

APPENDIX I-A
ELECTRONIC EQUIPMENT

COND	NOMENCLATURE	DESCRIPTION	QTY	SERIAL #	LOCATION	BLDG	APP	BAE #	PL #
1	AN/FRT-96	TRANSMITTER, AN/FRT-96	1	A315	TRANSMITTER DECK #1	BLDG 1	I-A	EE1-1-0001	
1	AN/FRT-96	TRANSMITTER, AN/FRT-96	1	A47	TRANSMITTER DECK #2	BLDG 1	I-A	EE1-1-0002	
1	AN/FRT-96	TRANSMITTER, AN/FRT-96	1	A366	TRANSMITTER DECK #3	BLDG 1	I-A	EE1-1-0003	
1	AN/FRT-96	TRANSMITTER, AN/FRT-96	1	A43	TRANSMITTER DECK #4	BLDG 1	I-A	EE1-1-0004	
1	AN/FRT-96	TRANSMITTER, AN/FRT-96	1	A384	TRANSMITTER DECK #5	BLDG 1	I-A	EE1-1-0005	
1	AN/FRT-96	TRANSMITTER, AN/FRT-96	1	A277	TRANSMITTER DECK #6	BLDG 1	I-A	EE1-1-0006	
1	AN/FRT-96	TRANSMITTER, AN/FRT-96	1	A40	TRANSMITTER DECK #7	BLDG 1	I-A	EE1-1-0007	
1	AN/FRT-96	TRANSMITTER, AN/FRT-96	1	A42	TRANSMITTER DECK #8	BLDG 1	I-A	EE1-1-0008	
1	AN/FRT-96	TRANSMITTER, AN/FRT-96	1	A37	TRANSMITTER DECK #9	BLDG 1	I-A	EE1-1-0009	
1	AN/FRT-96	TRANSMITTER, AN/FRT-96	1	A278	TRANSMITTER DECK #10	BLDG 1	I-A	EE1-1-0010	
1	AN/FRT-96	TRANSMITTER, AN/FRT-96	1	A279	TRANSMITTER DECK #11	BLDG 1	I-A	EE1-1-0011	
1	AN/FRT-96	TRANSMITTER, AN/FRT-96	1	A382	TRANSMITTER DECK #12	BLDG 1	I-A	EE1-1-0012	
1	AN/FRT-96	TRANSMITTER, AN/FRT-96	1	A46	TRANSMITTER DECK #13	BLDG 1	I-A	EE1-1-0013	
1	AN/FRT-96	TRANSMITTER, AN/FRT-96	1	A388	TRANSMITTER DECK #14	BLDG 1	I-A	EE1-1-0014	
1	AN/FRT-96	TRANSMITTER, AN/FRT-96	1	A358	TRANSMITTER DECK #15	BLDG 1	I-A	EE1-1-0015	
1	AN/FRT-96	TRANSMITTER, AN/FRT-96	1	A41	TRANSMITTER DECK #16	BLDG 1	I-A	EE1-1-0016	
1	AN/FRT-96	TRANSMITTER, AN/FRT-96	1	A45	TRANSMITTER DECK #17	BLDG 1	I-A	EE1-1-0017	
1	AN/FRT-96	TRANSMITTER, AN/FRT-96	1	A280	TRANSMITTER DECK #18	BLDG 1	I-A	EE1-1-0018	
1	AN/FRT-96	TRANSMITTER, AN/FRT-96	1	A283	TRANSMITTER DECK #19	BLDG 1	I-A	EE1-1-0019	
1	AN/FRT-96	TRANSMITTER, AN/FRT-96	1	A367	TRANSMITTER DECK #20	BLDG 1	I-A	EE1-1-0020	
1	AN/FRT-96	TRANSMITTER, AN/FRT-96	1	A51	TRANSMITTER DECK #21	BLDG 1	I-A	EE1-1-0021	
1	AN/FRT-96	TRANSMITTER, AN/FRT-96	1	A50	TRANSMITTER DECK #22	BLDG 1	I-A	EE1-1-0022	
1	AN/FRT-96	TRANSMITTER, AN/FRT-96	1	A360	TRANSMITTER DECK #23	BLDG 1	I-A	EE1-1-0023	
1	AN/FRT-96	TRANSMITTER, AN/FRT-96	1	A284	TRANSMITTER DECK #24	BLDG 1	I-A	EE1-1-0024	
1	AN/FRT-96	TRANSMITTER, AN/FRT-96	1	A285	TRANSMITTER DECK #25	BLDG 1	I-A	EE1-1-0025	
1	AN/FRT-96	TRANSMITTER, AN/FRT-96	1	A349	TRANSMITTER DECK #26	BLDG 1	I-A	EE1-1-0026	
1	AN/FRT-96	TRANSMITTER, AN/FRT-96	1	A319	TRANSMITTER DECK #27	BLDG 1	I-A	EE1-1-0027	
1	AN/FRT-96	TRANSMITTER, AN/FRT-96	1	A48	TRANSMITTER DECK #28	BLDG 1	I-A	EE1-1-0028	
1	AN/FRT-96	TRANSMITTER, AN/FRT-96	1	A290	TRANSMITTER DECK #29	BLDG 1	I-A	EE1-1-0029	
1	AN/FRT-96	TRANSMITTER, AN/FRT-96	1	A282	TRANSMITTER DECK #30	BLDG 1	I-A	EE1-1-0030	
1	AN/URT-42 (V1)	TRANSMITTER AN/URT-42	1	70	TRANSMITTER DECK #4	BLDG 1	I-A	EE1-1-0034	
1	AN/URT-42 (V1)	TRANSMITTER AN/URT-42	1	71	TRANSMITTER DECK #5	BLDG 1	I-A	EE1-1-0035	
1	AN/URT-42 (V1)	TRANSMITTER AN/URT-42	1	88	TRANSMITTER DECK #6	BLDG 1	I-A	EE1-1-0036	
1	AN/URT-42 (V1)	TRANSMITTER AN/URT-42	1	89	TRANSMITTER DECK #7	BLDG 1	I-A	EE1-1-0037	
1	AN/URT-42 (V1)	TRANSMITTER AN/URT-42	1	105	TRANSMITTER DECK #8	BLDG 1	I-A	EE1-1-0038	
1	AN/URT-42 (V1)	TRANSMITTER AN/URT-42	1	134	TRANSMITTER DECK #9	BLDG 1	I-A	EE1-1-0039	
1	AN/URT-42 (V1)	TRANSMITTER AN/URT-42	1	137	TRANSMITTER DECK #10	BLDG 1	I-A	EE1-1-0040	
1	9924233301	ANTENNA PATCH PANEL	1	4	TRANSMITTER DECK	BLDG 1	I-A	EE1-1-0041	
1	9924233301	ANTENNA PATCH PANEL	1	2	TRANSMITTER DECK	BLDG 1	I-A	EE1-1-0042	
1	9924233301	ANTENNA PATCH PANEL	1	1	TRANSMITTER DECK	BLDG 1	I-A	EE1-1-0043	
1	9924233301	ANTENNA PATCH PANEL	1	3	TRANSMITTER DECK	BLDG 1	I-A	EE1-1-0044	
1	CU-1382G/FRR	ANTENNA COUPLER	1	A390	TRANSMITTER DECK	BLDG 1	I-A	EE1-1-0045	
1	CU-1382G/FRR	ANTENNA COUPLER	1	A393	TRANSMITTER DECK	BLDG 1	I-A	EE1-1-0046	
1	CU-1382G/FRR	ANTENNA COUPLER	1	A410	TRANSMITTER DECK	BLDG 1	I-A	EE1-1-0047	
1	CU-1382G/FRR	ANTENNA COUPLER	1	A470	TRANSMITTER DECK	BLDG 1	I-A	EE1-1-0048	
1	CU-1382G/FRR	ANTENNA COUPLER	1	A473	TRANSMITTER DECK	BLDG 1	I-A	EE1-1-0049	
1	CU-1382G/FRR	ANTENNA COUPLER	1	A424	TRANSMITTER DECK	BLDG 1	I-A	EE1-1-0050	
1	CU-1382G/FRR	ANTENNA COUPLER	1	A403	TRANSMITTER DECK	BLDG 1	I-A	EE1-1-0051	
1	CU-1382G/FRR	ANTENNA COUPLER	1	A471	TRANSMITTER DECK	BLDG 1	I-A	EE1-1-0052	
3	CU-1382G/FRR	ANTENNA COUPLER	1	A640	WORKBENCH	BLDG 1	I-A	EE1-1-0053	
1	4-26100-0010	PATCHPANELS	1	505	R1B1	BLDG 1	I-A	EE1-1-0054	
1	4-26100-0010	PATCHPANELS	1	593	R1B1	BLDG 1	I-A	EE1-1-0055	
1	4-26100-0010	PATCHPANELS	1	489	R1B1	BLDG 1	I-A	EE1-1-0056	
1	4-26100-0010	PATCHPANELS	1	747	R1B1	BLDG 1	I-A	EE1-1-0057	
1	4-26100-0010	PATCHPANELS	1	749	R1B1	BLDG 1	I-A	EE1-1-0058	
1	4-26100-0010	PATCHPANELS	1	506	R1B1	BLDG 1	I-A	EE1-1-0059	
1	4-26100-0010	PATCHPANELS	1	674	R1B1	BLDG 1	I-A	EE1-1-0060	
1	4-26100-0010	PATCHPANELS	1	676	R1B1	BLDG 1	I-A	EE1-1-0061	
1	4-26100-0010	PATCHPANELS	1	427	R1B1	BLDG 1	I-A	EE1-1-0062	
1	4-26100-0010	PATCHPANELS	1	678	R1B1	BLDG 1	I-A	EE1-1-0063	
1	4-26100-0010	PATCHPANELS	1	658	R1B1	BLDG 1	I-A	EE1-1-0064	

APPENDIX I-A
ELECTRONIC EQUIPMENT

1	4-26100-0010	PATCHPANELS	1	663	R1B1	BLDG 1	I-A	EE1-1-0065
1	4-26100-0010	PATCHPANELS	1	574	R1B1	BLDG 1	I-A	EE1-1-0066
1	4-26100-0010	PATCHPANELS	1	577	R1B2	BLDG 1	I-A	EE1-1-0067
1	4-26100-0010	PATCHPANELS	1	671	R1B2	BLDG 1	I-A	EE1-1-0068
1	4-26100-0010	PATCHPANELS	1	510	R1B2	BLDG 1	I-A	EE1-1-0069
1	4-26100-0010	PATCHPANELS	1	430	R1B2	BLDG 1	I-A	EE1-1-0070
1	4-26100-0010	PATCHPANELS	1	440	R1B2	BLDG 1	I-A	EE1-1-0071
1	4-26100-0010	PATCHPANELS	1	432	R1B2	BLDG 1	I-A	EE1-1-0072
1	4-26100-0010	PATCHPANELS	1	681	R1B2	BLDG 1	I-A	EE1-1-0073
1	4-26100-0010	PATCHPANELS	1	499	R1B2	BLDG 1	I-A	EE1-1-0074
1	4-26100-0010	PATCHPANELS	1	434	R1B2	BLDG 1	I-A	EE1-1-0075
1	4-26100-0010	PATCHPANELS	1	517	R1B2	BLDG 1	I-A	EE1-1-0076
1	4-26100-0010	PATCHPANELS	1	535	R1B2	BLDG 1	I-A	EE1-1-0077
1	4-26100-0010	PATCHPANELS	1	423	R1B2	BLDG 1	I-A	EE1-1-0078
1	4-26100-0010	PATCHPANELS	1	670	R1B2	BLDG 1	I-A	EE1-1-0079
1	4-26100-0010	PATCHPANELS	1	664	R1B2	BLDG 1	I-A	EE1-1-0080
1	4-26100-0010	PATCHPANELS	1	521	R1B2	BLDG 1	I-A	EE1-1-0081
1	4-26100-0010	PATCHPANELS	1	435	R1B2	BLDG 1	I-A	EE1-1-0082
1	4-26100-0010	PATCHPANELS	1	452	R1B2	BLDG 1	I-A	EE1-1-0083
1	4-26100-0010	PATCHPANELS	1	564	R1B2	BLDG 1	I-A	EE1-1-0084
1	4-26100-0010	PATCHPANELS	1	462	R1B2	BLDG 1	I-A	EE1-1-0085
1	4-26100-0010	PATCHPANELS	1	537	R1B2	BLDG 1	I-A	EE1-1-0086
1	4-26100-0010	PATCHPANELS	1	438	R1B2	BLDG 1	I-A	EE1-1-0087
1	4-26100-0010	PATCHPANELS	1	501	R1B2	BLDG 1	I-A	EE1-1-0088
1	ADTECH DSA-5060A	DUAL AMPLIFIER VOICE ORDERWIRE	1	68030	R1B3	BLDG 1	I-A	EE1-1-0089
1	AS-3642/GRC	ANTENNA AZIMUTH CONTROLLER	1	74014	R1B3	BLDG 1	I-A	EE1-1-0090
1	TT202 SYNTECH MODEM	A TO D MODEM MP#20321	1	426	R2B2	BLDG 1	I-A	EE1-1-0091
1	CV-2997A(V)/FGC (DIGITAL DATA LEVEL)	CONVERTOR	1	117F	R2B2	BLDG 1	I-A	EE1-1-0092
1	MP96 MOD 2496 PARADYNEUP 9600	A TO D MODEM	1	7311	R2B4	BLDG 1	I-A	EE1-1-0093
1	DSV 10	DIGITAL VOX SYSTEM	1	9324-013	R1B3	BLDG 1	I-A	EE1-1-0094
1	4-26100-0010	PATCHPANELS	1	547	R1B5	BLDG 1	I-A	EE1-1-0095
1	4-26100-0010	PATCHPANELS	1	437	R1B5	BLDG 1	I-A	EE1-1-0096
1	4-26100-0010	PATCHPANELS	1	426	R1B5	BLDG 1	I-A	EE1-1-0097
1	4-26100-0010	PATCHPANELS	1	503	R1B5	BLDG 1	I-A	EE1-1-0098
1	4-26100-0010	PATCHPANELS	1	518	R1B5	BLDG 1	I-A	EE1-1-0099
1	4-26100-0010	PATCHPANELS	1	477	R1B5	BLDG 1	I-A	EE1-1-0100
1	4-26100-0010	PATCHPANELS	1	469	R1B5	BLDG 1	I-A	EE1-1-0101
1	4-26100-0010	PATCHPANELS	1	677	R1B5	BLDG 1	I-A	EE1-1-0102
1	4-26100-0010	PATCHPANELS	1	672	R1B5	BLDG 1	I-A	EE1-1-0103
1	4-26100-0010	PATCHPANELS	1	666	R1B5	BLDG 1	I-A	EE1-1-0104
1	4-26100-0010	PATCHPANELS	1	661	R1B5	BLDG 1	I-A	EE1-1-0105
1	4-26100-0010	PATCHPANELS	1	500	R1B5	BLDG 1	I-A	EE1-1-0106
1	4-26100-0010	PATCHPANELS	1	642	R1B5	BLDG 1	I-A	EE1-1-0107
1	4-26100-0010	PATCHPANELS	1	433	R1B5	BLDG 1	I-A	EE1-1-0108
1	4-26100-0010	PATCHPANELS	1	442	R1B5	BLDG 1	I-A	EE1-1-0109
1	4-26100-0010	PATCHPANELS	1	493	R1B5	BLDG 1	I-A	EE1-1-0110
1	4-26100-0010	PATCHPANELS	1	686	R1B5	BLDG 1	I-A	EE1-1-0111
1	4-26100-0010	PATCHPANELS	1	669	R1B5	BLDG 1	I-A	EE1-1-0112
1	4-26100-0010	PATCHPANELS	1	482	R1B5	BLDG 1	I-A	EE1-1-0113
1	4-26100-0010	PATCHPANELS	1	460	R1B5	BLDG 1	I-A	EE1-1-0114
1	4-26100-0010	PATCHPANELS	1	451	R1B5	BLDG 1	I-A	EE1-1-0115
1	4-26100-0010	PATCHPANELS	1	467	R1B5	BLDG 1	I-A	EE1-1-0116
1	4-26100-0010	PATCHPANELS	1	511	R1B5	BLDG 1	I-A	EE1-1-0117
1	4-26100-0010	PATCHPANELS	1	444	R1B5	BLDG 1	I-A	EE1-1-0118
1	4-26100-0010	PATCHPANELS	1	1011	R1B6	BLDG 1	I-A	EE1-1-0119
1	4-26100-0010	PATCHPANELS	1	995	R1B6	BLDG 1	I-A	EE1-1-0120
1	4-26100-0010	PATCHPANELS	1	1009	R1B6	BLDG 1	I-A	EE1-1-0121
1	4-26100-0010	PATCHPANELS	1	980	R1B6	BLDG 1	I-A	EE1-1-0122
1	4-26100-0010	PATCHPANELS	1	983	R1B6	BLDG 1	I-A	EE1-1-0123
1	4-26100-0010	PATCHPANELS	1	964	R1B6	BLDG 1	I-A	EE1-1-0124
1	4-26100-0010	PATCHPANELS	1	959	R1B6	BLDG 1	I-A	EE1-1-0125
1	4-26100-0010	PATCHPANELS	1	991	R1B6	BLDG 1	I-A	EE1-1-0126

APPENDIX I-A
ELECTRONIC EQUIPMENT

1	4-26100-0010	PATCHPANELS	1	461	R1B6	BLDG 1	I-A	EE1-1-0127
1	4-26100-0010	PATCHPANELS	1	519	R1B6	BLDG 1	I-A	EE1-1-0128
1	4-26100-0010	PATCHPANELS	1	522	R1B6	BLDG 1	I-A	EE1-1-0129
1	4-26100-0010	PATCHPANELS	1	492	R1B6	BLDG 1	I-A	EE1-1-0130
1	4-26100-0010	PATCHPANELS	1	466	R1B6	BLDG 1	I-A	EE1-1-0131
1	4-26100-0010	PATCHPANELS	1	514	R1B6	BLDG 1	I-A	EE1-1-0132
1	4-26100-0010	PATCHPANELS	1	443	R1B6	BLDG 1	I-A	EE1-1-0133
1	4-26100-0010	PATCHPANELS	1	476	R1B6	BLDG 1	I-A	EE1-1-0134
1	4-26100-0010	PATCHPANELS	1	474	R1B6	BLDG 1	I-A	EE1-1-0135
1	4-26100-0010	PATCHPANELS	1	497	R1B6	BLDG 1	I-A	EE1-1-0136
1	4-26100-0010	PATCHPANELS	1	463	R1B6	BLDG 1	I-A	EE1-1-0137
1	RS-422 K-PATCH	PATCHPANELS	2	NONE	R1B7	BLDG 1	I-A	EE1-1-0138
1	4-26100-0010	PATCHPANELS	1	436	R1B9	BLDG 1	I-A	EE1-1-0139
1	4-26100-0010	PATCHPANELS	1	439	R1B9	BLDG 1	I-A	EE1-1-0140
1	4-26100-0010	PATCHPANELS	1	660	R1B9	BLDG 1	I-A	EE1-1-0141
1	4-26100-0010	PATCHPANELS	1	496	R1B9	BLDG 1	I-A	EE1-1-0142
1	RS-422-A/V.115	PATCHPANELS	5	NONE	R1B9	BLDG 1	I-A	EE1-1-0143
1	4-26100-0010	PATCHPANELS	1	576	R1B10	BLDG 1	I-A	EE1-1-0144
1	CODEX 2660	A TO D MODEM	1	32169	R2B4	BLDG 1	I-A	EE1-1-0145
1	AN/FCC-100 V1 (X)	MULTIPLEXER SET	1	429A	R2B4	BLDG 1	I-A	EE1-1-0146
1	AN/FCC-100 V1 (X)	MULTIPLEXER SET	1	1177A	R2B4	BLDG 1	I-A	EE1-1-0147
1	AN/FCC-100 V1 (X)	MULTIPLEXER SET	1	957A	R2B4	BLDG 1	I-A	EE1-1-0148
1	AN/FCC-100 V1 (X)	MULTIPLEXER SET	1	1160A	R2B4	BLDG 1	I-A	EE1-1-0149
1	INTELECT 6234A	ALARM PANEL	1	NONE	R2B5	BLDG 1	I-A	EE1-1-0150
1	INTELECT 6234A	ALARM PANEL	1	NONE	R2B5	BLDG 1	I-A	EE1-1-0151
1	TELLAB MOD 4018	DISTRIBUTION AMPLIFIER	20	NONE	R2B5	BLDG 1	I-A	EE1-1-0152
1	TLC 333D LINE AMP	DISTRIBUTION AMPLIFIER	130	NONE	R2B5	BLDG 1	I-A	EE1-1-0153
1	KY-655A/FRT	KEYER MP N00950-01129	1	A002	R2B10	BLDG 1	I-A	EE1-1-0154
1	KY-655A/FRT	KEYER MP N00950-01130	1	A005	R2B10	BLDG 1	I-A	EE1-1-0155
1	KY-655A/FRT	KEYER MP N00950-01131	1	A001	R2B10	BLDG 1	I-A	EE1-1-0156
1	KY-655A/FRT	KEYER MP N00950-01132	1	A012	R2B10	BLDG 1	I-A	EE1-1-0157
1	KY-655A/FRT	KEYER MP N00950-01133	1	A39	R2B10	BLDG 1	I-A	EE1-1-0158
1	KY-655A/FRT	KEYER MP N00950-01126	1	A008	R2B10	BLDG 1	I-A	EE1-1-0159
1	KY-655A/FRT	KEYER MP N00950-01127	1	A369	R2B10	BLDG 1	I-A	EE1-1-0160
1	KY-655A/FRT	KEYER MP N00950-01144	1	A009	R2B10	BLDG 1	I-A	EE1-1-0161
1	ELECTROCOM 4810	FSK/CW KEYER CARD ASSEMBLY	1	106	R2B11	BLDG 1	I-A	EE1-1-0162
1	ELECTROCOM 4810	FSK/CW KEYER CARD ASSEMBLY	1	109	R2B9	BLDG 1	I-A	EE1-1-0163
1	C-12331/GRT-37	MCU-8 MATRIX CONTROLLER	1	A03	R2B12	BLDG 1	I-A	EE1-1-0164
1	C-12331/GRT-37	MCU-8 MATRIX CONTROLLER	1	A07	R2B12	BLDG 1	I-A	EE1-1-0165
1	C-12331/GRT-37	MCU-8 MATRIX CONTROLLER	1	A05	R2B12	BLDG 1	I-A	EE1-1-0166
1	R2368/URR	RECEIVERS MP N00950-00086	1	A1842	QC RACK -1	BLDG 1	I-A	EE1-1-0167
1	R2368/URR	RECEIVERS MP N00950-00087	1	A1887	QC RACK -1	BLDG 1	I-A	EE1-1-0168
1	MAS-96	ALARM PANELS	2	NONE	QC RACK -2	BLDG 1	I-A	EE1-1-0169
1	CDS-10	DISTRIBUTION AMPLIFIER	1	NONE	R3B6	BLDG 1	I-A	EE1-1-0170
1	GPS TRUETIME RCVR GSQ-215 "GPS DC" ON GEAR	GLOBAL POSITIONING SYSTEM	1	967	R3B6	BLDG 1	I-A	EE1-1-0171
1	FREQ MULTIPLIER 6016	AUSTRON	1	4800BS	R3B6	BLDG 1	I-A	EE1-1-0172
1	FREQ STANDARD 2010B	AUSTRON	1	5718IT	R3B6	BLDG 1	I-A	EE1-1-0173
1	FREQ STANDARD 2010B	AUSTRON	1	4898IS	R3B6	BLDG 1	I-A	EE1-1-0174
1	STANDBY PWR SUPPLY 1290A	AUSTRON	1	7230IU	R3B6	BLDG 1	I-A	EE1-1-0175
1	SA-2692/GRT-37	ANTENNA SWITCHING MATRIX	1	A03	MATRIX-1	BLDG 1	I-A	EE1-1-0176
1	CU2455/F	ANTENNA MULTICOUPLER	1	A2	MATRIX-1	BLDG 1	I-A	EE1-1-0177
1	DA-484/URT	DUMMY LOAD MP N00950-01113	1	B874202	MATRIX-1	BLDG 1	I-A	EE1-1-0178
1	PUR GAS PMP 25A10	DRY AIR MANIFOLD	1	11971892	MATRIX-1	BLDG 1	I-A	EE1-1-0179
1	PUR GAS PMP25A10	DRY AIR MANIFOLD	1	11971899	MATRIX-1	BLDG 1	I-A	EE1-1-0180
1	SA-2692/GRT-37	ANTENNA SWITCHING MATRIX	1	A05	MATRIX-2	BLDG 1	I-A	EE1-1-0181
1	CU2455/F	ANTENNA MULTICOUPLER	1	A10	MATRIX-2	BLDG 1	I-A	EE1-1-0182
1	CU2455/F 520G17 (PCB)	ANTENNA MULTICOUPLER	1	2364	MATRIX-2	BLDG 1	I-A	EE1-1-0183
1	CU2455/F	ANTENNA MULTICOUPLER	1	A7	MATRIX-2	BLDG 1	I-A	EE1-1-0184
1	DA-484/URT	DUMMY LOAD	1	B48	MATRIX-2	BLDG 1	I-A	EE1-1-0185
1	PUR GAS	DRY AIR MANIFOLD	1	11971891	MATRIX-2	BLDG 1	I-A	EE1-1-0186
1	SA-2692/GRT-37	ANTENNA SWITCHING MATRIX	1	A07	MATRIX-3	BLDG 1	I-A	EE1-1-0187
1	CU2455/F	ANTENNA MULTICOUPLER #8	1	NONE	MATRIX-3	BLDG 1	I-A	EE1-1-0188

APPENDIX I-A
ELECTRONIC EQUIPMENT

1	DA-484/URT	DUMMY LOAD	1	B13	MATRIX-3	BLDG 1	I-A	EE1-1-0189
1	PUR GAS PMP 23/10	DRY AIR MANIFOLD	1	18326016	MATRIX-3	BLDG 1	I-A	EE1-1-0190
1	PUR GAS PMP 25A10	DRY AIR MANIFOLD	1	11971890	MATRIX-3	BLDG 1	I-A	EE1-1-0191
1	PUREGAS P 06500	DEHYDRATOR MP N00950-01116	1	397969	BASEMENT	BLDG 1	I-A	EE1-1-0192
1	CYPHER LOCK	ALTRONIX	1	NONE	CCL DOOR	BLDG 1	I-A	EE1-1-0193
1	MCU-8	MATRIX CONTROL UNIT	1	268 was 279	3A1A1 SCOPE START	BLDG 1	I-A	EE1-1-0194
1	ALIEN TEL PROD	RACK MOUNT PHONE W/HEAD/HAND SET	1	N/A	3A1A5	BLDG 1	I-A	EE1-1-0195
1	MONITOR VE710b	VIEWSONIC	1	PIQ0523C1214	3A1A6	BLDG 1	I-A	EE1-1-0196
1	8 PORT PS/2 KVM SWITCH	CPU SWITCH IO GEAR	1	N/A	3A1A8	BLDG 1	I-A	EE1-1-0197
1	SITE PROCESSOR	CPU W/HARD DRIVE/CD/FLOPPY	1	N/A	3A1A10	BLDG 1	I-A	EE1-1-0200
1	SITE PROCESSOR	CPU W/HARD DRIVE/CD/FLOPPY	1	N/A	3A1A11	BLDG 1	I-A	EE1-1-0201
1	TROMPETER PATCH PANEL	PA/EXCITER PATCH PANEL	1	N/A	3A2A1	BLDG 1	I-A	EE1-1-0202
1	VML-300	VU METER/ LOUDSPEAKER	1	N/A	3A2A4	BLDG 1	I-A	EE1-1-0203
1	PATCH PANEL	PATCH PANEL	1	N/A	3A2A5	BLDG 1	I-A	EE1-1-0204
1	PATCH PANEL	PATCH PANEL	1	N/A	3A2A6	BLDG 1	I-A	EE1-1-0205
1	WESCOM	RING GEN. & PWR SUP (7 CARDS)	1	N/A	3A2A15	BLDG 1	I-A	EE1-1-0206
1	2600	CISCO ROUTER 2621	1	JAB043786QM	3A2	BLDG 1	I-A	EE1-1-0207
1	2600	CISCO ROUTER 2621	1	JMX0618K59X	3A2	BLDG 1	I-A	EE1-1-0208
1	PATCH PANEL	PATCH PANEL	1	N/A	3A3A4	BLDG 1	I-A	EE1-1-0209
1	RT-2200	RECEIVER-TRANSMITTER	1	824	3A3A7	BLDG 1	I-A	EE1-1-0210
1	RT-2200	RECEIVER-TRANSMITTER	1	34	3A3A8	BLDG 1	I-A	EE1-1-0211
1	RT-2200	RECEIVER-TRANSMITTER	1	641	3A3A9	BLDG 1	I-A	EE1-1-0212
1	RT-2200	RECEIVER-TRANSMITTER	1	1933	3A3A10	BLDG 1	I-A	EE1-1-0213
1	RT-2200	RECEIVER-TRANSMITTER	1	646	3A3A11	BLDG 1	I-A	EE1-1-0214
1	PATCH PANEL	PATCH PANEL	1	N/A	3A4A4	BLDG 1	I-A	EE1-1-0215
1	RT-2200	RECEIVER-TRANSMITTER	1	642	3A4A7	BLDG 1	I-A	EE1-1-0216
1	RT-2200	RECEIVER-TRANSMITTER	1	37	3A4A8	BLDG 1	I-A	EE1-1-0217
1	RT-2200	RECEIVER-TRANSMITTER	1	643	3A4A9	BLDG 1	I-A	EE1-1-0218
1	RT-2200	RECEIVER-TRANSMITTER	1	644	3A4A10	BLDG 1	I-A	EE1-1-0219
1	CISCO CATALYST 2950	ETHERNET 24 PORT HUB	1	HIKTSW1	3A4	BLDG 1	I-A	EE1-1-0220
1	CISCO CATALYST 2950	ETHERNET 24 PORT HUB	1	HIKTSW2	3A4	BLDG 1	I-A	EE1-1-0221
1	UPS TT041W0123	UPS CABINET	1	TT041W0123	3A5A1	BLDG 1	I-A	EE1-1-0222
1	UPS BATTERY TT032W0140	EXTENDED BATTERY CABINET	1	TT032W0140	3A5A2	BLDG 1	I-A	EE1-1-0223
1	RT-2200	RECEIVER-TRANSMITTER	1	1383	3A4	BLDG 1	I-A	EE1-1-0250
1	RT-2200	RECEIVER-TRANSMITTER	1	1391	3A4	BLDG 1	I-A	EE1-1-0251
1	RT-2200	RECEIVER-TRANSMITTER	1	1393	3A4	BLDG 1	I-A	EE1-1-0252
1	RT-2200	RECEIVER-TRANSMITTER	1	1394	3A4	BLDG 1	I-A	EE1-1-0253
1	RT-2200	RECEIVER-TRANSMITTER	1	1395	3A4	BLDG 1	I-A	EE1-1-0254
1	TROMPETER PATCH PANEL	PA/EXCITER PATCH PANEL	1	N/A	3A30	BLDG 1	I-A	EE1-1-0255
1	PATCH PANEL	PATCH PANEL	1	N/A	3A30	BLDG 1	I-A	EE1-1-0256
1	RT-2200	RECEIVER-TRANSMITTER	1	1403	3A30	BLDG 1	I-A	EE1-1-0257
1	RT-2200	RECEIVER-TRANSMITTER	1	1180	3A30	BLDG 1	I-A	EE1-1-0258
1	RT-2200	RECEIVER-TRANSMITTER	1	1421	3A30	BLDG 1	I-A	EE1-1-0259
1	RT-2200	RECEIVER-TRANSMITTER	1	1422	3A30	BLDG 1	I-A	EE1-1-0260
1	RT-2200	RECEIVER-TRANSMITTER	1	1525	3A30	BLDG 1	I-A	EE1-1-0261
1	RT-2200	RECEIVER-TRANSMITTER	1	1760HL	3A30	BLDG 1	I-A	EE1-1-0262
1	RT-2200	RECEIVER-TRANSMITTER	1	17DH9L	3A30	BLDG 1	I-A	EE1-1-0263
1	RT-2200	RECEIVER-TRANSMITTER	1	1829	3A30	BLDG 1	I-A	EE1-1-0264
1	TROMPETER PATCH PANEL	PA/EXCITER PATCH PANEL	1	N/A	3A32	BLDG 1	I-A	EE1-1-0265
1	PATCH PANEL	PATCH PANEL	1	N/A	3A32	BLDG 1	I-A	EE1-1-0266
1	RT-2200	RECEIVER-TRANSMITTER	1	1417	3A32	BLDG 1	I-A	EE1-1-0267
1	RT-2200	RECEIVER-TRANSMITTER	1	1832	3A32	BLDG 1	I-A	EE1-1-0268
1	RT-2200	RECEIVER-TRANSMITTER	1	1397	3A32	BLDG 1	I-A	EE1-1-0269
1	RT-2200	RECEIVER-TRANSMITTER	1	1402	3A32	BLDG 1	I-A	EE1-1-0270
1	RT-2200	RECEIVER-TRANSMITTER	1	1184	3A32	BLDG 1	I-A	EE1-1-0271
1	RT-2200	RECEIVER-TRANSMITTER	1	1406	3A32	BLDG 1	I-A	EE1-1-0272
1	RT-2200	RECEIVER-TRANSMITTER	1	1407	3A32	BLDG 1	I-A	EE1-1-0273
1	COM4000S-1	POWER AMPLIFIER (1)	1	1230	3A6	BLDG 1	I-A	EE1-1-0224
1	COM4000S-1	POWER AMPLIFIER (2)	1	1210	3A7	BLDG 1	I-A	EE1-1-0225
1	COM4000S-1	POWER AMPLIFIER (3)	1	1200	3A8	BLDG 1	I-A	EE1-1-0226
1	COM4000S-1	POWER AMPLIFIER (4)	1	1160	3A9	BLDG 1	I-A	EE1-1-0227
1	COM4000S-1	POWER AMPLIFIER (5)	1	1220	3A10	BLDG 1	I-A	EE1-1-0228

APPENDIX I-A
ELECTRONIC EQUIPMENT

1	COM4000S-1	POWER AMPLIFIER (6)	1	1170	3A11	BLDG 1	I-A	EE1-1-0229
1	COM4000S-1	POWER AMPLIFIER (7)	1	1240	3A12	BLDG 1	I-A	EE1-1-0230
1	COM4000S-1	POWER AMPLIFIER (8)	1	340	3A13	BLDG 1	I-A	EE1-1-0231
1	COM4000S-1	POWER AMPLIFIER (9)	1	350	3A14	BLDG 1	I-A	EE1-1-0232
1	COMM4000S-1	POWER AMPLIFIER (PA10)	1	1650	3A15	BLDG 1		EE1-1-0274
1	COMM4000S-1	POWER AMPLIFIER (PA11)	1	1651	3A16	BLDG 1		EE1-1-0275
1	COMM4000S-1	POWER AMPLIFIER (PA12)	1	1652	3A17	BLDG 1		EE1-1-0276
1	COMM4000S-1	POWER AMPLIFIER (PA13)	1	1653	3A18	BLDG 1		EE1-1-0277
1	COMM4000S-1	POWER AMPLIFIER (PA14)	1	1654	3A19	BLDG 1		EE1-1-0278
1	COMM4000S-1	POWER AMPLIFIER (PA15)	1	1655	3A20	BLDG 1		EE1-1-0279
1	COMM4000S-1	POWER AMPLIFIER (PA16)	1	1656	3A21	BLDG 1		EE1-1-0280
1	COMM4000S-1	POWER AMPLIFIER (PA17)	1	1657	3A22	BLDG 1		EE1-1-0281
1	COMM4000S-1	POWER AMPLIFIER (PA18)	1	1658	3A23	BLDG 1		EE1-1-0282
1	COMM4000S-1	POWER AMPLIFIER (PA19)	1	1659	3A24	BLDG 1		EE1-1-0283
1	COMM4000S-1	POWER AMPLIFIER (PA20)	1	1660	3A25	BLDG 1		EE1-1-0284
1	COMM4000S-1	POWER AMPLIFIER (PA21)	1	1661	3A26	BLDG 1		EE1-1-0285
1	COMM4000S-1	POWER AMPLIFIER (PA22)	1	1662	3A27	BLDG 1		EE1-1-0286
1	COMM4000S-1	POWER AMPLIFIER (PA23)	1	1663	3A33	BLDG 1		EE1-1-0287
1	COMM4000S-1	POWER AMPLIFIER (PA24)	1	1664	3A34	BLDG 1		EE1-1-0288
1	COMM4000S-1	POWER AMPLIFIER (PA25)	1	1665	3A35	BLDG 1		EE1-1-0289
1	COMM4000S-1	POWER AMPLIFIER (PA26)	1	1666	3A36	BLDG 1		EE1-1-0290
1	COMM4000S-1	POWER AMPLIFIER (PA27)	1	1667	3A37	BLDG 1		EE1-1-0291
1	COMM4000S-1 + LINK 11 UNIT	POWER AMPLIFIER (PA28)	1	1668	3A38	BLDG 1		EE1-1-0292
1	COMM4000S-1 + LINK 11 UNIT	POWER AMPLIFIER (PA29)	1	1649	3A39	BLDG 1		EE1-1-0293
1	RF TERMINATION	DACT-5KFM	1	1502106		BLDG 1		EE1-1-0294
1	SLS4M	TRANSMIT MATRIX (16X16)	1	368	3A28	BLDG 1	I-A	EE1-1-0233
1	DACT-5KFM	RF TERMINATION	1	1473004	3A29 SCOPE FINISH	BLDG 1	I-A	EE1-1-0234
1	HP MODEL 712/100 PA RISC CHIP	DESK TOP PROCESSOR/CPU (SRCS)	1	6710A55392	CCL START SRCS	BLDG 1	I-A	EE1-1-0235
1	DELL MONITOR	MONITOR (SRCS)	1	1062398	CCL	BLDG 1	I-A	EE1-1-0236
1	APC UPS NB0146313364	BF 500U 500VA UPS (SRCS)	1	NB0146313364	CCL	BLDG 1	I-A	EE1-1-0237
1	MOTOROLA UDS	MODEM V3225 (SRCS)	1	4613485	CCL	BLDG 1	I-A	EE1-1-0238
1	232-422 MFG. BY BLACK BOX	CONVERTER (SRCS)	1	96050129	CCL	BLDG 1	I-A	EE1-1-0239
1	HP S5264A	INTERFACE (SRCS)	1	6715A55309	CCL	BLDG 1	I-A	EE1-1-0240
1	HP A2655A	INTERFACE (SRCS)	1	6529A50534	CCL	BLDG 1	I-A	EE1-1-0241
1	232/422/485	CONVERTER (SRCS)	1	9808270663	CCL	BLDG 1	I-A	EE1-1-0242
1	232/422/485	CONVERTER (SRCS)	1	9808270226	CCL	BLDG 1	I-A	EE1-1-0243
1	ESPL-310	NET BUILDER ROUTER REMOTE OFF	1	4SPA008169	CCL	BLDG 1	I-A	EE1-1-0244
1	ST1016	232 16 PORT INTERFACE	1	000550-003	CCL FINISH SRCS	BLDG 1	I-A	EE1-1-0245
1	LDM 192	MODEM	1	9746	CCL QC RACK	BLDG 1	I-A	EE1-1-0246
1	LDM 192	MODEM	1	9749	CCL QC RACK	BLDG 1	I-A	EE1-1-0247
1	232/422/485 IN CARDBOARD BOX ON SHELF	CONVERTER (SRCS) SPARE	1	9701230124	T/E ROOM	BLDG 1	I-A	EE1-1-0248
1	HEWLETT/PACKARD CPU	712/80 (SRCS)	1	6611A50590	CONSOLE	BLDG 2	I-A	EE2-1-0001
1	3COM NETBUILDER	ESPL-310 (SRCS)	1	4SPA008165	CONSOLE	BLDG 2	I-A	EE2-1-0002
1	MOTOROLA MODEM	V.3225 (SRCS)	1	122559	CONSOLE	BLDG 2	I-A	EE2-1-0003
1	HEWLETT/PACKARD TAPE DRIVE	A2655A (SRCS)	1	6616A50656	CONSOLE	BLDG 2	I-A	EE2-1-0004
1	HEWLETT/PACKARD TAPE DRIVE	A2655A (SRCS)	1	6617A50493	CONSOLE	BLDG 2	I-A	EE2-1-0005
1	TIME & FREQUENCY SOLUTIONS CLOCK	AN/BSQ-9 (V) 3 (NISBS)	1	292	B1	BLDG 2	I-A	EE2-1-0006
1	TIME & FREQUENCY SOLUTIONS CLOCK	AN/BSQ-9 (V) 3 (NISBS)	1	180	B1	BLDG 2	I-A	EE2-1-0007
1	BPSA#1 ADC PATCH PANEL	RDC-01A (NISBS)	1	11805	B1	BLDG 2	I-A	EE2-1-0008
1	BPSA#2 ADC PATCH PANEL	2-42933-3/4T (NISBS)	1	11804	B1	BLDG 2	I-A	EE2-1-0009
1	BPSA#3 ADC PATCH PANEL	PMS-16MF (NISBS)	1	11806	B1	BLDG 2	I-A	EE2-1-0010
1	TEST PANEL	DM89-1 (NISBS)	1	423882-0010	B1	BLDG 2	I-A	EE2-1-0011
1	ROCKWELL GPS RECEIVER	AN/PSN-11 (V)1 (NISBS)	1	166875	B2	BLDG 2	I-A	EE2-1-0012
1	ROCKWELL GPS RECEIVER	AN/PSN-11 (V)2 (NISBS)	1	166881	B2	BLDG 2	I-A	EE2-1-0013
1	MD-1310/U	MODULATOR	1	11	B2	BLDG 2	I-A	EE2-1-0014
1	MD-1310/U	MODULATOR	1	14	B2	BLDG 2	I-A	EE2-1-0015
1	PARADYNE	3920-A1-401 (NISBS)	1	5072695	B2	BLDG 2	I-A	EE2-1-0016
1	PARADYNE	3920-A1-401 (NISBS)	1	5117832	B2	BLDG 2	I-A	EE2-1-0017
1	PARADYNE	3920-A1-401 (NISBS)	1	4932620	B2	BLDG 2	I-A	EE2-1-0018
1	MD 5062, MDL 1280 PLANTRONICS	P/O KEYS RACK	1	7005	B2	BLDG 2	I-A	EE2-1-0019
1	MD 1316/UGC COPACT-TIME INTEGRITY MODEM	MODEM	1	26	B2	BLDG 2	I-A	EE2-1-0020
1	MD 1316/UGC COPACT-TIME INTEGRITY MODEM	MODEM	1	015M	B2	BLDG 2	I-A	EE2-1-0021

APPENDIX I-A
ELECTRONIC EQUIPMENT

1	TUNING PATTERN GENERATOR	TPG #1	1	N/A	B2	BLDG 2	I-A	EE2-1-0022	
1	TUNING PATTERN GENERATOR	TPG #2	1	N/A	B2	BLDG 2	I-A	EE2-1-0023	
1	MD 5062, MDL 1280 PLANTRONICS	P/O KEYSER RACK	1	69026	B2	BLDG 2	I-A	EE2-1-0024	
1	UPS ENERGY TECHNOLOGIES INC.	UPS (NISBS)	1	2719-14889	B3	BLDG 2	I-A		
1	INDUSTRIAL COMPUTER SOURCE	7415P6-23V-B4 (NISBS)	1	G-3285100002	B4	BLDG 2	I-A	EE2-1-0026	
1	DATAPROBE ALARM ANNUNCIATOR	ANN-2-SA (NISBS)	1	2263 5-129	B3	BLDG 2	I-A	EE2-1-0027	
1	EMACHINE MONITOR	510V (NISBS)	1	M51966100-00-197	B3	BLDG 2	I-A		
1	DELL MONITOR	MONITOR	1	90627S0GAC86	B4	BLDG 2	I-A		
1	UPS ENERGY TECHNOLOGIES INC.	UPS (NISBS)	1	2719-14892	B4	BLDG 2	I-A		
1	INDUSTRIAL COMPUTER SOURCE	7415P6-23V-B4 (NISBS)	1	G-3353300001	B3	BLDG 2	I-A	EE2-1-0031	
1	INDUSTRIAL COMPUTER SOURCE	7415-A3 (NISBS)	1	C-4350201022	B4	BLDG 2	I-A	EE2-1-0032	
1	DATAPROBE ALARM ANNUNCIATOR	ANN-2-SA (NISBS)	1	1771.2-058	B4	BLDG 2	I-A	EE2-1-0033	
1	SORESEN DCS 40-25	24VDC POWER SUPPLY	1	N/A	B6	BLDG 2	I-A	EE2-1-0034	
1	EATON POWERWARE	UPS	1	1249	B6	BLDG 2	I-A		
1	AXXIUM 1500	UPS	1	203PFF0017T	B6	BLDG 2	I-A	EE2-1-0036	
1	AXXIUM 1500	UPS	1	203PFE7117T	B6	BLDG 2	I-A	EE2-1-0037	
1	POWERWARE 9125	UPS	1	TU443A0792	B6	BLDG 2	I-A	EE2-1-0038	
1	POWERWARE 9125	UPS	1	TT095A1033	B6	BLDG 2	I-A		
1	AXXIUM 1000	UPS	1	203PFF8264T	B6	BLDG 2	I-A	EE2-1-0040	
1	AXXIUM 1000	UPS	1	203PFF8268T	B6	BLDG 2	I-A	EE2-1-0041	
1	AXXIUM 1000	UPS	1	204PFF6135T	B6	BLDG 2	I-A	EE2-1-0042	
1	POWERWARE 9125	UPS	1	TX343S0043	B6	BLDG 2	I-A		
1	MONITOR WAS NMCI UNIT	DELL (FACIT)	1	MX-OWJ632-70715-669-31KZ	CONSOLE	BLDG 2	I-A		
1	MONITOR	DELL P1130	1	MX-06D251-47741-IC3-719Z	CONSOLE	BLDG 2	I-A	E2-1-0046	
1	CPU AUTO TUNE COMPUTER	REPLACEMENT UNIT	1	CDB005746	BEHIND UNIT 13	BLDG 2	I-A		
1	TOP LEVEL	AN/FRT-64, LUALUALEI, HI	1	-	68000-1	BLDG 2	I-A	EE2-1-0048	PL68000-1
1	AIR COMPRESSOR	71T2 MP N00950-07827	1	30T 719218	EXTERIOR	BLDG 2	I-A	EE2-1-0049	
1	AIR COMPRESSOR	71T2-10E MP N00950-07826	1	30T 637715	EXTERIOR	BLDG 2	I-A	EE2-1-0050	
1	DEMINERALIZER, BARNSTEAD	MP N00950-00343	1	9003001	STILL HOUSE	BLDG 2	I-A	EE2-1-0051	
1	DEMINERALIZER, BARNSTEAD	MP N00950-00344	1	9003002	STILL HOUSE	BLDG 2	I-A	EE2-1-0052	
1	STILL, STERILIZER BARNSTEAD		1	520	STILL HOUSE	BLDG 2	I-A	EE2-1-0053	
1	3	KIRK INTERLOCK SYSTEM	1	-	68103-1	BLDG 2	I-A	EE2-1-0054	PL68103-1
1	7	FIRST CROWBAR INDICATOR	1	148502	148501-1	BLDG 2	I-A	EE2-1-0055	PL148501-1
1	7A1 BOARD IN UNIT	FIRST EVENT LOGIC ASSY	1	143354	143352-1	BLDG 2	I-A	EE2-1-0056	PL143352-1
1	7A2 BOARD IN UNIT	SIGNAL CONDITIONER	1	148508	148507-1	BLDG 2	I-A	EE2-1-0057	PL148507-1
1	7A3 BOARD IN UNIT	SIGNAL CONVERTER	1	148511	148510-1	BLDG 2	I-A	EE2-1-0058	PL148510-1
1	7A4 BOARD IN UNIT	CROWBAR CARRIER CUTOFF BOARD	1	148505	148504-1	BLDG 2	I-A	EE2-1-0059	PL148504-1
1	8 BAY 5	AUXILIARY CONTROL RACK	1		197942-1	BLDG 2	I-A	EE2-1-0060	PL197942-1
1	A1 UNIT WITH CLEAR FRONT	CONTROL RACK	1	196971	196970-1	BLDG 2	I-A	EE2-1-0061	PL196970-1
1	A1A1 ALL CARDS IN ABOVE UNIT	CCO-PLC	1	197933	197932-1	BLDG 2	I-A	EE2-1-0062	PL197932-1
1	A1A3 24VDC POWER SUPPLY IN BAY 6	POWER SUPPLY ASSY, 24VDC REDUNDANT	1	196481	196480-1	BLDG 2	I-A	EE2-1-0063	PL196480-1
1	A1A4 IN REAR OF BAY 5	FIBER OPTIC TRANSMITTER ASSY	1	197155	197154-1	BLDG 2	I-A	EE2-1-0064	PL197154-1
1	A1A5 IN REAR OF BAY 5	RECEIVER, FIBER OPTIC ASSY	2	186490	186489-1	BLDG 2	I-A	EE2-1-0065	PL186489-1
1	A1A7	MODULATOR SELECT ASSY	1	196971	198089-1	BLDG 2	I-A	EE2-1-0066	PL198089-1
1	A2 UNIT HOLDING AXIUM 1000 UPS UNITS IN BAY 6	UPS RACK ASSY	1	197935	197934-1	BLDG 2	I-A	EE2-1-0067	PL197934-1
1	9	CCO CARD CAGE ASSY, TYPE VII	1	196429	186010-7	BLDG 2	I-A	EE2-1-0068	PL186010-7
1	A902 BOARD IN UNIT	PULSE SHAPER	1	186370		BLDG 2	I-A	EE2-1-0069	1
1	A903 BOARD IN UNIT	CCO STEERING LOGIC	1	186042		BLDG 2	I-A	EE2-1-0070	1
1	A904-5 BOARDS IN UNIT	ARC INPUT SENSOR	2	186009		BLDG 2	I-A	EE2-1-0071	1
1	A906 BOARD IN UNIT	PHASE MONITOR	1	196424		BLDG 2	I-A	EE2-1-0072	1
1	10	CONTROL CONSOLE	1	197309	197308-1	BLDG 2	I-A	EE2-1-0073	PL197308-1
1	A1002 MONITOR LEFT OF METER PANEL	MONITOR NEC LCD 2010X-BK	1	2900434CA	109-0741-040	BLDG 2	I-A	EE2-1-0075	1
1	A1003 CPU FAR RIGHT OF METER PANEL	COMPUTER, PENTIUM IV DELL DHM	1	8K3Y311	109-0777-010	BLDG 2	I-A	EE2-1-0076	1
1	A1004 MONITOR RIGHT OF METER PANEL	MONITOR NEC LCD 2010X-BK	1	2900655CA	109-0741-040	BLDG 2	I-A	EE2-1-0077	1
1	A1005 CPU IN FAR LEFT CONSOLE UNIT	COMPUTER, PENTIUM IV DELL DHM	1	CK3Y311	109-0777-010	BLDG 2	I-A	EE2-1-0078	1
1	A1006 MONITOR	DELL (SRCS)	1	7195427	CONSOLE	BLDG 2	I-A		
1	A1007	METER PANEL	1	196818	196815-1	BLDG 2	I-A	EE2-1-0080	PL196815-1
1	A1008 OSCOPE	OSCILLOSCOPE TEKTRONICS TDS-3034B	1	B031275	122-0009-010	BLDG 2	I-A	EE2-1-0081	1
1	A1009 123214 CYTEC	COAXIAL SWITCH ASSY	1	123214	196561-1	BLDG 2	I-A	EE2-1-0082	PL196561-1
1	A1011	ETHERNET SWITCH	1	D100/7LEV48C0758	109-0755-010	BLDG 2	I-A	EE2-1-0083	1
1	A1012	ETHERNET SWITCH	1	D100/7LEV48C0D68	109-0755-010	BLDG 2	I-A	EE2-1-0084	1
1	11	IPA PLC	1	197705	197686-1	BLDG 2	I-A	EE2-1-0085	PL197686-1

APPENDIX I-A
ELECTRONIC EQUIPMENT

1	12	PA PLC	1	197404	197403-1	BLDG 2	I-A	EE2-1-0086	PL197403-1
1	13	MASTER PLC	1	197402	197401-1	BLDG 2	I-A	EE2-1-0087	PL197401-1
1	A1333	NATIONAL INSTRUMENTS IN UNIT 13-2	1	N/A	196752-1	BLDG 2	I-A	EE2-1-0088	PL196752-1
1	A1334	IN UNIT 13-1	1	17	177402-3	BLDG 2	I-A	EE2-1-0089	PL177402-3
1	18	IPA CABINET ASSY	1	197400	197399-1	BLDG 2	I-A	EE2-1-0090	PL197399-1
1	19	BACK OF UNIT 18	1	197398	197397-1	BLDG 2	I-A	EE2-1-0091	PL197397-1
1	20	IPA DUMMY LOAD	1	197396	197395-1	BLDG 2	I-A	EE2-1-0092	PL197395-1
1	22	IPA LOAD CENTER ASSY	1	N/A	197922-1	BLDG 2	I-A	EE2-1-0093	PL197922-1
1	A1	LOAD CENTER SUB-ASSY, IPA-1	1	68022	197822-1	BLDG 2	I-A	EE2-1-0094	PL197822-1
1	A2	LOAD CENTER SUB-ASSY, IPA-2	1	68022	197824-1	BLDG 2	I-A	EE2-1-0095	PL197824-1
1	24-1	RADIO FREQUENCY AMPLIFIER	1	68024	68124-1	BLDG 2	I-A	EE2-1-0096	PL68124-1
1	24-2	RADIO FREQUENCY AMPLIFIER	1	68024	68124-1	BLDG 2	I-A	EE2-1-0097	PL68124-1
1	25-1	RADIO TUNING UNIT	1	68025	68125-1	BLDG 2	I-A	EE2-1-0098	PL68125-1
1	25-2	RADIO TUNING UNIT	1	68025	68125-1	BLDG 2	I-A	EE2-1-0099	PL68125-1
1	A2520	1EA 25-1 &25-2	2	196230	177402-3	BLDG 2	I-A	EE2-1-0100	PL177402-3
1	A2506	1EA 25-1 &25-2	2	196867	125463-4	BLDG 2	I-A	EE2-1-0101	PL125463-4
1	A2507	1EA 25-1 &25-2	2	196867	125463-4	BLDG 2	I-A	EE2-1-0102	PL125463-4
1	A2508	1EA 25-1 &25-2	2	196867	125463-4	BLDG 2	I-A	EE2-1-0103	PL125463-4
1	A2509	1EA 25-1 &25-2	2	196867	125463-4	BLDG 2	I-A	EE2-1-0104	PL125463-4
1	A2510	1EA 25-1 &25-2	2	196867	125463-4	BLDG 2	I-A	EE2-1-0105	PL125463-4
1	A2511	1EA 25-1 &25-2	2	196867	125463-4	BLDG 2	I-A	EE2-1-0106	PL125463-4
1	A2512	1EA 25-1 &25-2	2	196867	125463-4	BLDG 2	I-A	EE2-1-0107	PL125463-4
1	A2513	1EA 25-1 &25-2	2	196867	125463-4	BLDG 2	I-A	EE2-1-0108	PL125463-4
1	26	PA OUTPUT SWITCHING	1	68026	68126-1	BLDG 2	I-A	EE2-1-0109	PL68126-1
1	A2605	SENSOR, ARC DETECTOR	1	196867	125463-4	BLDG 2	I-A	EE2-1-0110	PL125463-4
1	A2606	SENSOR, ARC DETECTOR	1	196867	125463-4	BLDG 2	I-A	EE2-1-0111	PL125463-4
1	A2607	SENSOR, ARC DETECTOR	1	196867	125463-4	BLDG 2	I-A	EE2-1-0112	PL125463-4
1	A2608	SENSOR, ARC DETECTOR	1	196867	125463-4	BLDG 2	I-A	EE2-1-0113	PL125463-4
1	A2609	SENSOR, ARC DETECTOR	1	196867	125463-4	BLDG 2	I-A	EE2-1-0114	PL125463-4
1	A2610	SENSOR, ARC DETECTOR	1	196867	125463-4	BLDG 2	I-A	EE2-1-0115	PL125463-4
1	A2611	SENSOR, ARC DETECTOR	1	196867	125463-4	BLDG 2	I-A	EE2-1-0116	PL125463-4
1	A2612	SENSOR, ARC DETECTOR	1	196867	125463-4	BLDG 2	I-A	EE2-1-0117	PL125463-4
1	27-1	AMPLIFIER FILTER UPSTAIRS	1	680027	68127-1	BLDG 2	I-A	EE2-1-0118	PL68127-1
1	A2702	CROWBAR ASSY P/O ABOVE UNIT	1	196550	196549-1	BLDG 2	I-A	EE2-1-0119	PL196549-1
1	27-2	AMPLIFIER FILTER UPSTAIRS	1	680027	68127-1	BLDG 2	I-A	EE2-1-0120	PL68127-1
1	A2702	CROWBAR ASSY P/O ABOVE UNIT	1	196550	196549-1	BLDG 2	I-A	EE2-1-0121	PL196549-1
1	28-1	PA COOLING EQUIPMENT	1	68028	68128-1	BLDG 2	I-A	EE2-1-0122	PL68128-1
1	28-2	PA COOLING EQUIPMENT	1	68028	68128-1	BLDG 2	I-A	EE2-1-0123	PL68128-1
1	28-3	PA COOLING EQUIPMENT	1	68028	68128-1	BLDG 2	I-A	EE2-1-0124	PL68128-1
1	29-1	POWER SUPPLY	1	68029	68129-1	BLDG 2	I-A	EE2-1-0125	PL68129-1
1	A2902-1	GROUNDING SWITCH	1	N/A	197297-1	BLDG 2	I-A	EE2-1-0126	PL197297-1
1	29-2	POWER SUPPLY	1	68029	68129-1	BLDG 2	I-A	EE2-1-0127	PL68129-1
1	A2902-2	GROUNDING SWITCH	1	N/A	197297-1	BLDG 2	I-A	EE2-1-0128	PL197297-1
1	30-1	PA 2400KW RECTIFIER PLATE TRANSFORMER	1	68030	68130-1	BLDG 2	I-A	EE2-1-0129	PL68130-1
1	30-2	PA 2400KW RECTIFIER PLATE TRANSFORMER	1	68030	68130-1	BLDG 2	I-A	EE2-1-0130	PL68130-1
1	31-1	PA 2500KVA REGULATOR	1	68031	68131-1	BLDG 2	I-A	EE2-1-0131	PL68131-1
1	31-2	PA 2500KVA REGULATOR	1	68031	68131-1	BLDG 2	I-A	EE2-1-0132	PL68131-1
1	32	11.5KV/4160	1	68032	68132-1	BLDG 2	I-A	EE2-1-0133	PL68132-1
1	33	LOAD CENTER ASSEMBLY	1	N/A	197923-1	BLDG 2	I-A	EE2-1-0134	PL197923-1
1	A1	LOAD CENTER SUB-ASSY, PA-1	1	68033	197823-1	BLDG 2	I-A	EE2-1-0135	PL197823-1
1	A2	LOAD CENTER SUB-ASSY, PA-2	1	68033	197823-1	BLDG 2	I-A	EE2-1-0136	PL197823-1
1	34	SUBSTATION EQUIPMENT, 4160/460V	1	68034	68134-1	BLDG 2	I-A	EE2-1-0137	PL68134-1
1	37	LOAD CENTER, MASTER	1	68037	197925-1	BLDG 2	I-A	EE2-1-0138	PL197925-1
1	38	DUMMY LOAD, ELECTRICAL, DA-372	1	68038	68138-1	BLDG 2	I-A	EE2-1-0139	PL68138-1
1	42-1	TOWER BASE, ARC SENSOR	1	197556	197514-1	BLDG 2	I-A	EE2-1-0140	PL197514-1
1	42-2	TOWER BASE, ARC SENSOR	1	197556	197514-1	BLDG 2	I-A	EE2-1-0141	PL197514-1
1	45	STATION COOLING SYSTEM	1	68045	68145-1	BLDG 2	I-A	EE2-1-0142	PL68145-1
1	51 NEW SUBSTA	SUBSTATION EQUIPMENT, 11.5KV/4160V	1	68051	68151-1	BLDG 2	I-A	EE2-1-0143	PL68151-1
1	RECEIVER	R-2368/URR MP N00950-00240	1	A1898	BAY 7	BLDG 2	I-A	EE2-1-0144	
1	NITROGEN SYSTEM	PRISM NITROGEN SYSTEM	1	PAM8300	BY BACK ENTRANCE	BLDG 2	I-A	EE2-1-0145	
1	NITROGEN COMPRESSOR	KAISER SM11	1	1326	BY BACK ENTRANCE	BLDG 2	I-A	EE2-1-0146	
1	STORAGE TANK P/O NITROGEN SYSTEM	80 GALLONTANK	1	CATALOG #302417	BY BACK ENTRANCE	BLDG 2	I-A	EE2-1-0147	

APPENDIX I-A
ELECTRONIC EQUIPMENT

1	STORAGE TANK P/O NITROGEN SYSTEM	120 GALLON TANK	1	CATALOG # 302421	BY BACK ENTRANCE	BLDG 2	I-A	EE2-1-0148	
1	AXXIUM 1000	UPS	1	200PFF6140T	CONSOLE	BLDG 2	I-A	EE2-1-0149	
1	HP LASERJET PRINTER	5100tn	1	JPGQC00066	ON CONSOLE	BLDG 2	I-A	EE2-1-0150	
1	DELL LAPTOP COMPUTER	D800	1		CONSOLE UNIT 1	BLDG 2	I-A	EE2-1-0152	
1	BRANDYWINE NETWORK TIME SERVER	NTP8 PART # 081000001	1	227/AFED	CONSOLE BOTTOM UNIT C	BLDG 2	I-A	EE2-1-0153	
1	GPIB-USB-B NATIONAL INSTRUMENTS	SMALL BLUE BOX	1	10C87BC	CONSOLE UNIT 1 SMALL B	BLDG 2	I-A	EE2-1-0154	
1	ROSS RELAY TESTER	ASSY 504847-001	1	1	EQUIPMENT CABINET	BLDG 2	I-A	EE2-1-0155	
1	14	HELIX HOUSE PLC	1	68014	197930-1	BLDG 3	I-A	EE2-1-0156	PL197930-1
1	36	LOAD CENTER, HELIX HOUSE	1	68036	197924-1	BLDG 3	I-A	EE2-1-0157	PL197924-1
1	40	HELIX HOUSE	1	68040	68140-1	BLDG 3	I-A	EE2-1-0158	PL68140-1
1	A4002	SENSOR, ARC DETECTOR	1	196867	125463-4	BLDG 3	I-A	EE2-1-0159	PL125463-4
1	A4003	SENSOR, ARC DETECTOR	1	196867	125463-4	BLDG 3	I-A	EE2-1-0160	PL125463-4
1	A4004	SENSOR, ARC DETECTOR	1	196867	125463-4	BLDG 3	I-A	EE2-1-0161	PL125463-4
1	A4005	SENSOR, ARC DETECTOR	1	196867	125463-4	BLDG 3	I-A	EE2-1-0162	PL125463-4
1	A4006	SENSOR, ARC DETECTOR	1	196867	125463-4	BLDG 3	I-A	EE2-1-0163	PL125463-4
1	A4007	SENSOR, ARC DETECTOR	1	196867	125463-4	BLDG 3	I-A	EE2-1-0164	PL125463-4
1	PENWALT WALLACE & TIERNAN SCALE	SF-6 SCALE	1	N/A	HELIX HOUSE	BLDG 3	I-A	EE3-1-0001	
1	BUSHING PRESSURE MANIFOLD	SF-6 GAS	1	N/A	HELIX HOUSE	BLDG 3	I-A	EE3-1-0002	
1	AIR LIQUIDE MANIFOLD FOR SF-6 TANK	MODEL HTPT500-80-590-4M	2	N/A	HELIX HOUSE	BLDG 3	I-A	EE3-1-0003	
3	CU-1382G/FRR	ANTENNA COUPLER	1	A475	BLDG 1	BLDG 1	I-A	EE66-1-0001	
1	HP CPU	MODEL 712/80 SPARE UNIT FOR SRCS	1	6616A50339	Model 712/80 spare SRCS	BLDG 66	I-A	EE66-1-0002	
1	VARIABLE PLATE TRANSFORMER	WESTINGHOUSE	1	ZBP-75341	NORTH PART OF BLDG 67	BLDG 67	I-A	EE67-1-0001	
1	CPU DELL MODEL WHL LEFT OF METERS	SCADA	1	C1SCJ91	CONSOLE	BLDG2	I-A	EE2-1-0165	
1	CPU DELL MODEL WHL RIGHT OF METERS	SCADA	1	F1SCJ91	CONSOLE	BLDG2	I-A	EE2-1-0166	
1	PLASMA MONITOR NEC MODEL PX-50XM4A W/ STAND	SYSTEM MONITOR	1	5700081 9K	CONTROL ROOM	BLDG2	I-A	EE2-1-0171	

Appendix I-B
Test Equipment

COND	NOMENCLATURE	DESCRIPTION	QTY	SERIAL	LOCATION	BLDG	APPN
1	820	CAPACITANCE METER	1	90-44190	BCTD	BLDG 1	I-B
1	212159	MEGOHMMETER *	1	1088	BCTD	BLDG 1	I-B
1	1502C	TDR CABLE TESTER	1	B022366	BCTD	BLDG 1	I-B
1	1503C04	TDR CABLE TESTER	1	B010627	BCTD	BLDG 1	I-B
1	1531AB	STROBOSCOPE	1	1928	BCTD	BLDG 1	I-B
1	2002-08	ANALYZER DISTN TTY *	1	1115	BCTD	BLDG 1	I-B
1	2002-08	ANALYZER GENERATOR	1	1483	BCTD	BLDG 1	I-B
1	2002-08CC19	ANALYZER GENERATOR	1	1234	BCTD	BLDG 1	I-B
1	260-6XLP	MULTIMETER	1	20352	BCTD	BLDG 1	I-B
1	27AN	MULTIMETER	1	4915218	BCTD	BLDG 1	I-B
1	27AN	MULTIMETER	1	5045134	BCTD	BLDG 1	I-B
1	27AN	MULTIMETER	1	5060124	BCTD	BLDG 1	I-B
1	323-20 MOD 40	VOLTMETER TRUE RMS	1	025-8069	BCTD	BLDG 1	I-B
1	3551A	TRANSMISSION T/S	1	1550A08302	BCTD	BLDG 1	I-B
1	3551A	TRANSMISSION T/S	1	2632A15659	BCTD	BLDG 1	I-B
1	3551A	TRANSMISSION T/S	1	2632A16321	BCTD	BLDG 1	I-B
1	400GLC01	AC VOLTMETER	1	0943A04619	BCTD	BLDG 1	I-B
1	460A TEKTRONIX	4 CHAN O'SCOPE FROM FRT-64	1	B050861	BCTD	BLDG 1	I-B
1	4410-025	DIRECTIONAL WATTMETER	1	1910	BCTD	BLDG 1	I-B
1	4410-025	DIRECTIONAL WATTMTR	1	1815	BCTD	BLDG 1	I-B
1	4410-3	RF WATTMTR PLUGIN	1	1815	BCTD	BLDG 1	I-B
1	4410-4	RF WATTMTR PLUGIN	1	1815	BCTD	BLDG 1	I-B
1	4410-4	RF WATTMETER PLUG IN	1	1910	BCTD	BLDG 1	I-B
1	4410-5	RF WATTMTR PLUGIN	1	1815	BCTD	BLDG 1	I-B
1	4410-5	RF WATTMETER PLUG IN	1	1910	BCTD	BLDG 1	I-B
1	4410-6	RF WATTMETER PLUG IN	1	1815	BCTD	BLDG 1	I-B
1	4410-7	RF WATTMTR PLUGIN	1	1815	BCTD	BLDG 1	I-B
1	4600-000	RF LINE SECTION	1	2772	BCTD	BLDG 1	I-B
1	4600-000	RF LINE SECTION	1	2773	BCTD	BLDG 1	I-B
1	4950PT39	SPECTRUM ANALYZER	1	B020108	BCTD	BLDG 1	I-B
1	4950PT39	SPECTRUM ANALYZER	1	B020187	BCTD	BLDG 1	I-B
1	5328AF96	COUNTER FREQUENCY *	1	1828A08234	BCTD	BLDG 1	I-B
1	5328AH99	COUNTER FREQUENCY *	1	2144A51345	BCTD	BLDG 1	I-B
1	5328AH99	COUNTER FREQUENCY	1	2444A58222	BCTD	BLDG 1	I-B
1	5328AH99	COUNTER FREQUENCY	1	2444A58595	BCTD	BLDG 1	I-B
1	6274B	DC POWER SUPPLY	1	1712A03845	BCTD	BLDG 1	I-B

Appendix I-B
Test Equipment

1	6274B	DC POWER SUPPLY	1	2323A07730	BCTD	BLDG 1	I-B
1	6296A	DC POWER SUPPLY	1	1918A03448	BCTD	BLDG 1	I-B
1	633-60 TYPE VA1	CLAMP-ON METER	1	28214	BCTD	BLDG 1	I-B
1	72-62	BIT ERROR RATE T/S	1	107506	BCTD	BLDG 1	I-B
1	72-62	BIT ERROR RATE T/S	1	107512	BCTD	BLDG 1	I-B
1	80I600A	CLAMP-ON AC PROBE	1	5045134	BCTD	BLDG 1	I-B
1	80K-40	HI VOLTAGE PROBE	1	3	BCTD	BLDG 1	I-B
1	80K6	PROBE HIGH VOLTAGE	1	4915218-2	BCTD	BLDG 1	I-B
1	80K6	PROBE HIGH VOLTAGE *	1	5060124-2	BCTD	BLDG 1	I-B
1	8563AH51	SPECTRUM ANALYZER	1	3604A03910	BCVC	BLDG 1	I-B
1	85RF	HI FREQUENCY PROBE	1	4915218-1	BCTD	BLDG 1	I-B
1	85RF	HI FREQUENCY PROBE	1	4920057	BCTD	BLDG 1	I-B
1	85RF	HI FREQUENCY PROBE	1	5045134-1	BCTD	BLDG 1	I-B
1	8643AH02K01	SYNTH SIGNAL GEN	1	3546A02046	BCTD	BLDG 1	I-B
1	8643AH02K01	SYNTH SIGNAL GEN	1	3546A02052	BCTD	BLDG 1	I-B
1	ANURQ23	FREQUENCY/TIME STD	1	E324	BCTD	BLDG 1	I-B
1	DP501	DIGITAL PRESCALER	1	B010329	BCTD	BLDG 1	I-B
1	E4407B	SPECTRUM ANALYSER	1	US41443035	BCVC	BLDG 1	I-B
1	HD125	AC/DC HIPOT TESTER	1	7701-13-8341	BCTD	BLDG 1	I-B
1	MD 400	CLAMP ON CURRENT PROBE	1	N40062AEMC	BCTD	BLDG 1	I-B
1	RS3	CLAMP-ON METER	1	96106575	BCTD	BLDG 1	I-B
1	TF2005	AF TWO TONE SIGNAL S	1	351239-20	BCTD	BLDG 1	I-B
1	TF2005R	AF TWO TONE SIGNAL S	1	351284-04	BCTD	BLDG 1	I-B
1	TF2005R	AF TWO TONE SIGNAL S	1	351286-05	BCTD	BLDG 1	I-B
1	TF2005R	AF TWO TONE SIGNAL S	1	351288-063	BCTD	BLDG 1	I-B
1	177	TRUE-RMS MULTIMETER	1	80450163	BCVC	BLDG 2	I-B
1	620	LAN CABLE METER	1	7822028	BCVC	BLDG 2	I-B
1	830	CAPACITANCE METER	1	72-40310	BCVC	BLDG 2	I-B
1	4265	LCR METER	1	LO818004	BCVC	BLDG 2	I-B
1	6610	PHASE METER	1	934	BCVC	BLDG 2	I-B
1	212159	MEGOHMMETER	1	2287	BCVC	BLDG 2	I-B
1	260-6XLP	MULTIMETER	1	20351	BCVC	BLDG 2	I-B
1	33120A	FUNCTION GENERATOR	1	US36037678	BCVC	BLDG 2	I-B
1	34401A	RMS MULTIMETER	1	US36087090	BCVC	BLDG 2	I-B
1	3551A	TRANSMISSION TEST SET	1	2214A11771	BCVC	BLDG 2	I-B
1	3551A	TRANSMISSION TEST SET	1	2632A15662	BCVC	BLDG 2	I-B
1	5321A 2PCS.	DC HYPOT	1	1111	BCVC	BLDG 2	I-B

Appendix I-B
Test Equipment

1	5328AH99	COUNTER FREQUENCY	1	2444A58264	BCVC	BLDG 2	I-B
1	77AN	MULTIMETER DIGITAL	1	38150277	BCVC	BLDG 2	I-B
1	77BN	MULTIMETER DIGITAL	1	53570921	BCVC	BLDG 2	I-B
1	77BN	MULTIMETER DIGITAL	1	71210907	BCVC	BLDG 2	I-B
1	80I600A	CLAMP-ON AC PROBE	1	80I01	BCVC	BLDG 2	I-B
1	80K-40	HIGH VOLTAGE PROBE	1	80340073	BCVC	BLDG 2	I-B
1	99B	SCOPE METER FLUKE	1	DM7690065	BCVC	BLDG 2	I-B
1	BIDDLE LO RESISTANCE OHMMETER	CAT # 247100 100A CURRENT SOURCE	1	47759	BCVC	BLDG 2	I-B
1	BIDDLE LO RESISTANCE OHMMETER	CAT # 247100 MEASURING MODULE	1	47759	BCVC	BLDG 2	I-B
1	BIDDLE LO RESISTANCE OHMMETER	PART # 15572-1 CHARGER MODULE	1	N/A	BCVC	BLDG 2	I-B
1	CV931	DC AMMETER	1	72224	BCVC	BLDG 2	I-B
1	80K-40 (LOCKER ABOVE OFFICE)	FLUKE 80K-40 HI VOLT PROBE	1	N/A	BCVC	BLDG 2	I-B
1	80K-40 (LOCKER ABOVE OFFICE)	FLUKE 80K-40 HI VOLT PROBE	1	N/A	BCVC	BLDG 2	I-B
1	M712A P/O T710	FOTOTEC LAN METER	1	P20156	BCVC	BLDG 2	I-B
1	ND650V	CLAMP ON AMMETER	1	N/A	BCVC	BLDG 2	I-B
1	OC60D-A	HIPOT OIL DIELECRIC TESTER	1	P0511039	BCVC	BLDG 2	I-B
1	P6015A	HIGH VOLTAGE PROBE	1	B032142	BCVC	BLDG 2	I-B
1	P6015A	HIGH VOLTAGE PROBE	1	B032143	BCVC	BLDG 2	I-B
1	POWER SUPPLY	LAMBDA REGULATED POWER SUPPLY	1	M048430	BCVC	BLDG 2	I-B
1	POWER SUPPLY	LAMBDA EMS	1	24H7205	BCVC	BLDG 2	I-B
1	R1LB	MICRO OHMMETER	1	29474	BCVC	BLDG 2	I-B
1	RS-3 SUPER	CLAMP-ON METER	1	141563	BCVC	BLDG 2	I-B
1	S770 P/O T710	FOTOTEC LAN METER	1	S20155	BCVC	BLDG 2	I-B
1	SD100	SPRING SCALE	1	VLF001	BCVC	BLDG 2	I-B
1	SD100	SPRING SCALE	1	VLF002	BCVC	BLDG 2	I-B
1	SIMPSON '00168	HI VOLTAGE PROBE	1	N/A	BCVC	BLDG 2	I-B
1	T710	OPTICAL LOSS TEST SET	1	N/A	LLL	BLDG 2	I-B
1	TDS1012	DIG RT OSCILLOSCOPE	1	CO15345	BCVC	BLDG 2	I-B
1	TF2005R	AF TWO TONE SIGNAL	1	351288-037	BCVC	BLDG 2	I-B
1	TI 30 PART # 2433111	THERMAL IMAGING KIT W/2CD MANUAL	1	2486600201-0001	BCVC	BLDG 2	I-B
1	TORQUE SCREWDRIVER	STURTEVANT RICHMONT	1	CAL-36/4	BCVC	BLDG 2	I-B
1	W10MT3A	VARIAC	1	194522	BCVC	BLDG 2	I-B
1	WRENCH, TORQUE	7502MMH	1	802305555	BCVC	BLDG 2	I-B
1	ANRITSU S114C SPEC ANALYZER	W/ CASE, CHARGER AND MANUAL	1	540105	BCVC	BLDG 2	I-B
1	OSLN50LF P/O S114C ANRITSU	PRECISION OPEN/SHORT/LOAD	1	0509326	BCVC	BLDG 2	I-B
1	15NNF50-1.5C P/O S114C ANRITSU	TEST PORT EXTENSION CABLE	1	03828661	BCVC	BLDG 2	I-B
1	VIBRO-METER INC.	U/V TEST METER	1	MODEL 43808-2	BCVC	BLDG 2	I-B

Appendix I-B
Test Equipment

1	212159	MEGOHMMETER	1	2181	BCVC	BLDG 4R	I-B
1	1502C4	TESTER CABLE TDR	1	B023865	BCVC	BLDG 4R	I-B
1	260-6XLP	MULTIMETER	1	11893	BCTD	BLDG 4R	I-B
1	TORQUE WRENCH, BELIEVED TO BE TH	JS TECHNOLOGY	1	43400	NSN 5120-0	BLDG 4-G	I-B
1	20	SURVEYORS SCOPE	1	4659	BCTD	BLDG 4-R	I-B
1	20	SURVEYORS SCOPE	1	4673	BCTD	BLDG 4-R	I-B
1	475	DYNAMOMETER	1	472-0190	BCTD	BLDG 4-R	I-B
1	475	DYNAMOMETER, DILLON was 472-0191	1	AP31243	BCTD	BLDG 4-R	I-B
1	475	DYNAMOMETER, DILLON was 472-0189	1	APD88763	BCTD	BLDG 4-R	I-B
1	77BN	MULTIMETER DIGITAL	1	77950314	BCVC	BLDG 4-R	I-B
1	77BN	MULTIMETER DIGITAL	1	78851773	BCVC	BLDG 4-R	I-B
1	DT5A SOKIA	THEODOLITE	1	D20507		BLDG 4-R	I-B
1	TM 750	TENSIONMETER	1	2118	BCVC	BLDG 4-R	I-B
1	TM 750	TENSIONMETER	1	2124	BCVC	BLDG 4-R	I-B
1	TM 750	TENSIONMETER	1	2126	BCVC	BLDG 4-R	I-B
1	TM 800	TENSIONMETER	1	2696	BCTD	BLDG 4-R	I-B
1	TM 800	TENSIONMETER	1	2725	BCVC	BLDG 4-R	I-B
1	WRENCH, TORQUE	5120-00-640-6365	1	28304		BLDG 4-R	I-B
1	77-0010	SURVEYORS SCOPE K+E	1	192998	BCVC	BLDG 74	I-B
1	TD5	DYNAMOMETER, CHATILLON	1	4249	BCVC	BLDG 74	I-B
1	TD5	DYNAMOMETER, CHATILLON	1	4250	BCVC	BLDG 74	I-B
1	212159	MEGOHMMETER	1	1286	BCTD	BLDG 81	I-B
1	1646388	OIL TEST OUTFIT	1	MRG54180	BCTD	BLDG 81	I-B
1	27AN	MULTIMETER	1	4920057	BCTD	BLDG 81	I-B
1	80I410	CLAMP-ON AC/DC PROBE	1	4920057	BCTD	BLDG 81	I-B
1	80K6	PROBE HIGH VOLTAGE	1	4920057	BCTD	BLDG 81	I-B
1	W10MT3A	VARIAC	1	PHON00004	BCTD	BLDG 81	I-B

Appendix I-F
Antennas

COND	NOMENCLATURE	DESCRIPTION	QTY	SERIAL	LOCATION	BLDG	APPN
1	AS-2856	HTOA	1	STRUCTURE # 406	WAH	BLDG 12A	I-F
1	AS-2856	HTOA	1	STRUCTURE # 407	WAH	BLDG 12A	I-F
1	INVERTED CONE ANTENNA	INVERTED CONE	1	STRUCTURE # 404	WAH	BLDG 12A	I-F
1	INVERTED CONE ANTENNA	INVERTED CONE	1	STRUCTURE # 405	WAH	BLDG 12A	I-F
1	TCI MODEL 4-612-8	LOOP ARRAY	1	STRUCTURE # 444	WAH	BLDG 12A	I-F
1	DI-MONOPOLE ANTENNA	N/A	1	STRUCTURE # 403	WAH	BLDG 12A	I-F
1	SPIRACONE ANTENNA	SPIRA-CONE	1	STRUCTURE # 437	WAH	BLDG 12A	I-F
1	4203-AA	INVERTED CONE	1	S347	LLL	BLDG 1	I-F
1	4203-AA	INVERTED CONE	1	S348	LLL	BLDG 1	I-F
1	4203-AA	INVERTED CONE	1	S349	LLL	BLDG 1	I-F
1	4203-AA	INVERTED CONE	1	S350	LLL	BLDG 1	I-F
1	4203-AA	INVERTED CONE	1	S351	LLL	BLDG 1	I-F
1	794-A	INVERTED CONE	1	S403	LLL	BLDG 1	I-F
1	AS-2212/FRC	INVERTED CONE	1	S437	LLL	BLDG 1	I-F
1	AS-2212/FRC	INVERTED CONE	1	S438	LLL	BLDG 1	I-F
1	AS-2212/FRC	INVERTED CONE	1	S439	LLL	BLDG 1	I-F
1	AS-2212/FRC	INVERTED CONE	1	S440	LLL	BLDG 1	I-F
1	AS-2212/FRC	INVERTED CONE	1	S441	LLL	BLDG 1	I-F
1	AS-2212/FRC	INVERTED CONE	1	S442	LLL	BLDG 1	I-F
1	AS-2212/FRC	INVERTED CONE	1	S443	LLL	BLDG 1	I-F
1	AS-2212/FRC	INVERTED CONE	1	S446	LLL	BLDG 1	I-F
1	AS-2212/FRC	INVERTED CONE	1	S454	LLL	BLDG 1	I-F
1	AS-3642/GRC	RLPA	1	S456	LLL	BLDG 1	I-F
1	AS/2855/FRC	HTOA	1	S464	LLL	BLDG 1	I-F
1	AS/2855/FRC	HTOA	1	S465	LLL	BLDG 1	I-F
1	TCI MODEL 540-2-05	HOBA	1	S476	LLL	BLDG 1	I-F
1	TCI MODEL 540-2-05	HOBA	1	S477	LLL	BLDG 1	I-F
1	TCI MODEL 540-2-05	HOBA	1	S478	LLL	BLDG 1	I-F
1	TCI MODEL 550-1A-04	VOBA	1	S479	LLL	BLDG 1	I-F
1	TCI MODEL 550-1A-04	VOBA	1	S480	LLL	BLDG 1	I-F
1	TCI MODEL 550-1A-04	VOBA	1	S481	LLL	BLDG 1	I-F
1	TCI MODEL 550-1A-04	VOBA	1	S482	LLL	BLDG 1	I-F
1	TCI MODEL 540-2-05	HOBA	1	S483	LLL	BLDG 1	I-F
1	TCI MODEL 540-2-05	HOBA	1	S484	LLL	BLDG 1	I-F
1	TCI MODEL 550-1A-04	VOBA	1	S485	LLL	BLDG 1	I-F
1	ANDREW MODEL 3002-36HE-32	SPIRA-CONE	1	SC-5	LLL	BLDG 1	I-F
1	ANDREW MODEL 3002-36HE-32	SPIRA-CONE	1	SC-6	LLL	BLDG 1	I-F
1	ANDREW MODEL 3005-2L-34	SPIRA-CONE	1	SC-1	LLL	BLDG 1	I-F
1	ANDREW MODEL 3005-2L-34	SPIRA-CONE	1	SC-2	LLL	BLDG 1	I-F
1	ANDREW MODEL 3005-2L-34	SPIRA-CONE	1	SC-3	LLL	BLDG 1	I-F
1	ANDREW MODEL 3005-2L-34	SPIRA-CONE	1	SC-4	LLL	BLDG 1	I-F
1	ANDREW MODEL 3005-2L-34	SPIRA-CONE	1	SC-7	LLL	BLDG 1	I-F
1	ANDREW MODEL 3005-2L-34	SPIRA-CONE	1	SC-8	LLL	BLDG 1	I-F
1	TRUETIME MODEL 142-401	GPS	1	N/A	LLL	BLDG 1	I-F
1	AIR FORCE TOWER	N/A	1	STRUCTURE # 417	WAH	BLDG 12	I-F
1	AIR FORCE TOWER	N/A	1	STRUCTURE # 418	WAH	BLDG 12	I-F
1	GPS ANTENNAS (2EA)	GPS	1	N/A	LLL	BLDG 2	I-F
1	VLF ANTENNA EAST TOWER	P/O AN/FRT-64	1	STRUCTURE # 427	LLL	BLDG 2	I-F
1	VLF ANTENNA WEST TOWER	P/O AN/FRT-64	1	STRUCTURE # 426	LLL	BLDG 2	I-F
1	VLF ANTENNA "P" TOWER	P/O AN/FRT-64	1	STRUCTURE # 462	LLL	BLDG 2	I-F
1	BUILDING 261 TOWER	N/A	1	STRUCTURE # 341	WAH	BLDG 261	I-F
1	KOLE KOLE TOWER	N/A	1	467	KOLE KOLE PASS	N/A	I-F

Appendix I-I
Directives, Equipment Publications, Instructions, and Notices

ALL INSTRUCTIONS FOR NCTAMS,PACNAVFACENGCOM,DISA/DCAC, DCA, NAVFAC NAVSUP,NAVCOMPT, OPNAV, NAVNETSPAOPSCOM IS AVAILABLE ONLINE AT THE APPLICABLE WEBSITE.		
COND	TITLE	DESCRIPTION
1	2336YA OSCILLOSCOPE TEKTRONICS	070-5011-00
1	3002A-36H SPIRACONE	1098-1396-02
1	3002A-36H SPIRACONE	1098-1396-02
1	3005 SPIRACONE	1098-1426
1	492/492P SPECTRUM ANALYZER	070-3784-01
1	540-2-05-HOBA	0913-LP-164-5100
1	540-2-05-HOBA	0913-LP-164-5100
1	540-2-05-HOBA	0913-LP-164-5100
1	550-1A-04-VOBA	0913-LP-280-9800
1	AM-7494/URT-42	EE150-WE-MMC-010
1	AM-7494/URT-42	EE020-PV-INS-010
1	AN/FCC-100	EE163-CA-OMI-010/E110-FCC-100
1	AN/FCC-100	EE163-CA-MMI-010
1	AN/FCC-100	EE163-CA-PLL-010
1	AN/FRT-64	0967-LP-384-1010
1	AN/FRT-64	0967-LP-384-1020
1	AN/FRT-64	0967-LP-384-1030
1	AS 4134/GRC	0913-LP-285-5600
1	AS/2187/FRC	0967-434-2010
1	AS/2187/FRC	0967-434-2010
1	AS/2187/FRC	0967-434-2010
1	AS/2187/FRC	0967-434-2010
1	AS-2187/FRC	0967-LP-434-2040
1	AS-2187/FRC	0967-LP-589-4010
1	AS-2187/FRC	0967-LP-589-4010
1	AS-2212/13/14	09627-LP-294-6020
1	AS-3642-GRC	0967-LP-224-9010
1	AS-4135/GRC	0913-LP-285-5400
1	C-12331/GRT-37	D93-299A (D13-78-1)
1	C-123330/GRT-36	D93-299A (D13-77-1)
1	CDS-10	N/A
1	COLLINS 237A, 237A-2, 237A-3	520-5863-00
1	CR10 OPERAORS MANUAL CAMBELL SCIENTIFIC	
1	CU-1382B/FRR ANTENNA COUPLER	0967-LP-233-5010
1	CU-1382F&G/FRR	0967-LP-450-8010
1	CU-656/U	0967-LP-383-3010 NAVSHIPS 93804B
1	CV-2998 2997/2997A/2998	0967-LP-432-7010
1	CV-2998 2997/2997A/2998	0967-LP-432-7010
1	DA-242/U DUMMY LOAD	N00104-85-G-0375
1	DA-242/U DUMMY LOAD	N00104-85-G-0375
1	DA-484/URT	0967-LP-330-0010

Appendix I-I
Directives, Equipment Publications, Instructions, and Notices

1	DA-484/URT DUMMY LOAD	0969-LP-247-0010
1	DIGITAL DISTRIBUTION UNIT MODEL DDU-1	CTM 0220-1 ISSUE 2
1	DIGITEC MODEL 2002-08 (GENERATOR MODEL	810-00162
1	DIGITECH PATTERNGENERATOR MODEL 2182-03	810-00056A
1	FP-40,40A & 40B FUSE PANELS	IM-714 REV B
1	FRT-64	MODIFICATION PLAN
1	FRT-64	SURVEY AND PRELIMINARYDESIGN FOR FVLF REMOTE CONTROLL
1	FRT-64	REMOTE CONTROL & COMMAND PERFORMANCE MONITORING SCREENS
1	FRT-64	INTERMEDIATE POWER AMPLIFIER
1	HF-8151A	523-0774470-001211
1	HF-8151A	523-0774470-001211
1	H-P 10811A/B QUARTZ CRYSTAL OSCILLATOR	10811-9002
1	H-P 5328AH99 FREQUENCY COUNTER	05328-90101
1	H-P 8904A MULTIFUNCTION SYTHESIZER	08904-90007
1	H-P 8904A MULTIFUNCTION SYTHESIZER	08904-90008
1	KY-655/FRT	0967-LP-292-9020
1	KY-655/FRT	0967-293-4010
1	KY-655A/FRT	EE141-HW-MOH-010/E110
1	KY-655A/FRT	0967-LP-293-4020
1	KY-665A/FRT	EE141-HW-MSB-010/E110
1	KY-655A/FRT	EE141-HW-OMI-010/E110
1	KY-655A/FRT	EE141-HW-MOH-010/E110
1	LOW LEVEL TECH CONTROL EQUIPMENT	0967-LP-391-6010
1	MCU-8 MATRIX CONTROL UNIT	D13-62-18
1	MODEL 6531-KB3	RACK MOUNT FOR KEYBOARDS MANUAL (USED IN BLDG.2)
1	PARADYNE 392X	3920-A2-GK41-50
1	PARADYNE 9600	MP96
1	PECO SHREDDER	PARTS AND SERVICE LIST
1	PP-8377/URT-42	EE010-VG-MMC-010
1	R-2368/URR	EE125-FC-OMI-010
1	RF-353	10087-0705
1	RF-354	10087-0805
1	RF-354	10087-0805
1	SA-1551 (V)/GRT- RF TRANSMISSION LINE SWITCH	0967-LP-284-7010
1	SA-1551(V)GRT-RF TRANSMISSION LINE SWITCH	0967-LP-224-9010
1	SA-2691/GRT-36	D61-109-1
1	SA-2691/GRT-37	D61-110-1
1	SATCOM ANTENNA Project Managers OFFICE	ANTENNA MAINTENANCE GREEN BOOK
1	T-1588/URT-42	EE150-WE-MMC-010
1	T-1588/URT-42	EE150-WE-MMC-010
1	T-1588/URT-42	EE150-WF-INS-010
1	TLS-350-350R VEEDER ROOT	576013-610, REVISION F
1	TM503 POWER MODULE TEKTRONICS	070-1305-01
1	TM503 POWER MODULE TEKTRONICS	070-1305-01

Appendix I-I
Directives, Equipment Publications, Instructions, and Notices

1	TM503 POWER MODULE TEKTRONICS	070-1305-01
1	TR 503 TRACKING GENERATOR	070-3526-00
1	TR 503 TRACKING GENERATOR	070-3526-00
1	WOODWARD EMERGENCY DIESEL UPGRADE	WOODWARD EMERGENCY DIESEL UPGRADE
1	O & M FOR BLDG.1	MEDIUM VOLTAGE SWITCH GEAR, OUTDOOR UNIT SUB TRANSFORMERS, LOW
	*****	VOLTAGESWITCH GEAR AND DRAWINGS
1	BLDG 1 ALARM MANUALS	FBII
1	BLDG 1 ROLL UP DOOR MANUALS	
1	SUBSTATION ECHO	SUBSTATION ECHO TECHNICAL DOCUMENTATION AND BLUE PRINTS
1	SUBSTATION ALPHA BLDG. 404 SPEC SEC 16361	1.REPLACE TRANSFORMER STATION WITH GE POWER MANAGEMENT SR745
	*****	TRANSFORMER MANAGEMENT RELAY
	*****	2. ABB TYPE PM LINE OF RELAYS (41-973.5R)
	*****	3. ABB HCB-1 PILOT WIRE RELAY SYSTEM (I.L.-971.3L)
	*****	4. GE METAL CLAD SWITCHGEAR (GEK-39672F)
	*****	5. GE POWERVAC VACUUM CKT BRKRS (GEK-86132F)
	*****	6. GE INSTANTANEOUS AUX RELAY (GEH-1793J)
	*****	7. GE AUX RELAY (GEH-2058L)
	*****	8. GE TEST PLUGS (GEI-25372D)
	*****	9. GE MAGNETIC CONTACTORS (GEH 5089A)
	*****	10. GE CONTROL AND INSTRUMENT SWITCHES (GEH-908R)
	*****	11. GE UNDERVOLTAGE RELAYS (GEH-1768G)
	*****	12. GE LIFT TRUCK (GE 90214A)
	*****	13. GE TEST PLUGS (GE-49083)
1	SUBSTATION ALPHA BLDG. 404 O & M	SYNCH RELAY BE-125
1	SUBSTATION ALPHA BLDG. 404 O & M SPEC SEC 16336	REPLACE TRANSFORMER, DRAWINGS, SCHEMATICS AND OPERATION
	*****	STARTUP TEST REPORT FOR TRANSFORMER REPLACEMENT
1	BLDG. 71 TRANSFORMER INFORMATION	
1	SF6 CIRCUIT BREAKERS ABB POWER T&D COMPANY INC.	ABB POWER T&D COMPANY INC. INSTALLATION AND MAINTENANCE.PUB# 33-200A-6
1	SF6 CIRCUIT BREAKERS ABB POWER T&D COMPANY INC.	ABB POWER T&D COMPANY INC. INSTALLATION AND MAINTENANCE.PUB# 33-200A-6
1	SF6 CIRCUIT BREAKERS ABB POWER T&D COMPANY INC.	ABB POWER T&D COMPANY INC. INSTALLATION AND MAINTENANCE.PUB# 33-200A-6
1	SF6 CIRCUIT BREAKERS ABB POWER T&D COMPANY INC.	TYPE PM FSA-2 MECHANISM PUB#641P007-7
1	SF6 CIRCUIT BREAKERS ABB POWER T&D COMPANY INC.	TYPE PM FSA-2 MECHANISM PUB#641P007-7
1	SF6 CIRCUIT BREAKERS ABB POWER T&D COMPANY INC.	TYPE PM FSA-2 MECHANISM PUB#641P007-7
1	SCOPE	DRAWINGS 3 INCH BINDER AND A STACK OF DRAWINGS
1	NISBIS	INSTALLATION DESIGN PLAN 3 INCH BINDER AND A STACK OF DRAWINGS
1	MIL HDBK-419A	MILITARY HANDBOOK-GROUNDING BONDING AND SHIELDING FOR ELECTRONIC
	*****	EQUIPMENTS AND AND FACILITIES VOLS. I & II
1	LPH # 40218	O & M MANUAL FOR HELIX HOUSE BLOWERS
1	SPIROCONE	MEDIUM INTENSITY OBSTRUCTION LIGHTING TYPE LS-161 (WAHIAWA SPIRACONE)
1	DEHUMIDIFIER	ANDREW 1920A AND PUREGAS MODEL P-05000
1	BLDG 1 AC O&M MANUAL	N/A

Appendix I-J
Naval Warfare Publications Library

COND	NOMENCLATURE	DESCRIPTION	QTY	LOCATION	BLDG	APPENDIX
1	ACP 131(E)	COMMUNICATION INSTRUCTIONS AND OPERATING SIGNALS S/N #10	1	LLL	BLDG 1	I-J

HF RSS

location	part_num	descr	nsn	qty	auth_qty	ordQty
10A1	637-9315-001	CONNECTOR	5935-01-199-6411	1	1	0
10A2	259-7201-310	SWITCH	5930-01-310-1934	1	1	0
10A3	635-0888-001	C/C ASSY	5998-01-123-8753	1	1	0
10B1	747-3829-000	RESISTOR, FIXED	5905-00-764-8816	4	4	0
10B2	4511-00	Control Module		1	1	0
10B3	B22-0007-001	FAN ASSY	4140-01-208-6568	3	3	0
10C1	635-0657-001	C/C ASSY	5998-01-113-7073	7	7	0
10C2	913-3017-000	CAPACITOR	5910-00-737-1530	3	3	0
10C2	962-5054	CIRCUIT CARD ASSY	599801-080-4680	2	2	0
10D1	547-6291-003	COIL, RF	5950-00-086-8827	3	3	0
10D2	353-0424-040	SEMICONDUCTIVE DEVICE	5961-01-249-5677	40	40	0
10D3	10085-5310	IF FILTER	5998-01-529-4219	1	1	0
10D3	10085-5500	CIRCUIT CARD A1A9	5998-01-161-7536	1	1	0
10E1	714-3196-000	RESISTOR, FIXED	5905-00-916-2343	6	6	0
10E2	638-6896-004	INTERFACE, SERI	5998-01-306-7216	8	8	0
10E3	10085-2100	CIRCUIT CARD ASSY	5998-01-162-5539	1	1	0
10F1	012-2111-000	INSERT, SCR THD	5340-00-815-4930	1	1	0
10F1	372-5884-200	PIN CONTACT	5999-00-890-9450	1	1	0
10F2	266-7524-010	SWITCH	5930-01-089-6298	1	1	0
10F2	372-0046-010	CONNECTOR	5935-01-112-5579	1	1	0
10F3	1261B	LINE SECTION, RADIO	5985-00-849-4809	1	1	0
10G1	10085-0212	TUBEAXIAL FAN A2B1	4140-01-424-2024	4	4	0
10G2	777-5983-002	DRIVE, TUNING	5895-01-113-6989	7	7	0
10G3	687-5593-001	ARRESTER, SURGE	5920-01-305-9356	6	6	0
10H1	10085-0220	CIRCUIT CARD A4 & A13	6130-01-211-5493	1	1	0
10H1	10086-7100	CIRCUIT CARD A5	5998-01-159-9688	1	1	0
10H2	10085-5600	CIRCUIT CARD A1A10	5895-01-194-8120	2	2	0
10H3	10086-9200	CIRCUIT CARD A6	5998-01-159-9689	1	1	0
10H3	401-0004-120	ARMATURE RELAY	5945-01-128-6709	5	5	0
11A	637-1348-001	DISCRIMINATOR	5895-01-113-6972	13	13	0
11A	637-2712-007	FILTER, RFI	5998-01-306-7222	3	3	0
11B	659-2488-001	IF CHANNEL	5998-01-306-7210	13	13	0
11B	687-5563-001	ASSEMBLY, FILTER	5915-01-306-7016	1	1	0
11C	637-1345-002	DETECTOR, RF	5895-01-113-7045	4	4	0
11C	659-2485-001	SIDEBOARD, SYNTH	5998-01-306-7220	2	2	0
11C	751-3478-001	Circuit Card		2	2	0
11C	777-5873-001	SUPPLY, POWER	6130-01-069-3714	4	4	0
11D	220-1523-000	TUBE SOCKET	5935-00-920-7087	3	4	0
11D	637-1781-012	ASSEMBLY, FREQ.	5999-01-306-7186	2	2	0
11D	687-5579-005	Tuning Drive	5895-01-302-2709	4	4	0
12A	635-4930-002	SYNTHESIZER	5998-01-113-6533	6	6	0
12A	NOS-50	FUSE 50 AMP	5920-00-190-7334	14	40	0
12B	642-3137-003	OUTPUT, PARALLEL	5998-01-306-7215	8	8	0
12B	687-5565-001	DIRECTIONAL, COUPLER	5985-01-341-4473	1	1	0
12B	746-6737-000	RESISTOR, FIXED	5105-00-837-3613	0	16	0
12C	10085-5400	EXC PWB ASSY,CW	5998-01-162-3346	2	2	0
12C	646-5672-003	CONTROL	5998-01-306-7214	8	8	0
12C	R-7171	RESISTOR	5905-01-462-9598	14	14	0
12D	623-2080-003	SYNTHESIZER	5998-01-113-7071	7	7	0
12D	635-0735-002	CONTROL, SERIAL	5998-01-306-7200	12	12	0

13A	635-0830-001	SWITCHBOARD, FR	5998-01-124-9153	5	5	0
13A	646-6558-001	SWITCH, FREQ.	5998-01-126-8299	4	4	0
13A	687-5052-002	SWITCH, BUS	5998-01-306-7207	16	16	0
13B	623-2080-001	SYNTHESIZER	5998-01-113-7069	3	3	0
13B	635-0824-002	AUDIO, TRANSMIT	5998-01-306-7208	7	7	0
13B	662-0382-010	Transformer, POW	5950-00-470-9388	3	3	0
13B	777-6703-002	SWITCH SHORT	5930-01-128-7289	2	2	0
13C	635-0745-002	CONTROL, INTER	5998-01-306-7201	14	14	0
13C	662-0600-010	TRANSFORMER, POW	5950-01-115-1369	6	6	0
13D	10085-0410	CIRCUIT CARD A1A22	5998-01-440-2533	1	1	0
13D	637-1295-001	RECTIFIER PLATE	6130-01-112-8824	1	2	0
13D	637-1341-001	DISCRIMINATOR	5895-01-113-6458	10	10	0
14A	10085-0580	PLATE CONN A1A20	5820-01-211-5293	1	1	0
14A	10085-2000	PANEL A1A11	5998-01-211-5499	1	1	0
14A	10085-8010	POWER AMP A1A4	5996-01-209-9063	3	3	0
14B	635-0794-001	CIRCUIT CARD ASSY	599801-113-7079	9	9	0
14B	635-0825-018	DISPLAY, LED	5998-01-306-7203	1	1	0
14B	642-3135-001	INPUT, PARALLEL	599801-113-7082	8	8	0
14C	10085-1240	CIRCUIT CARD A1A14	5998-01-211-7914	0	1	0
14C	687-5054-001	POSITIONING	5998-01-306-7202	16	16	0
14D	635-0804-001	REGULATOR, BI	5820-01-113-7391	3	3	0
14D	659-2179-001	CONTROL, LOGIC	5998-01-301-6353	8	8	0
15A	638-6896-009	C/C ASSY		4	4	0
15A	V06-0001-000	VACUUM TUBE	5960-00-313-6715	4	4	0
15B	10085-0068	SEE RF-364 MICROPHONE	5965-01-209-2800	2	2	0
15B	10085-0213	TRANSFORMER A2T1	5950-01-208-5441	1	1	0
15B	218-0090-010	CIRCUIT CARD	5925-01-133-9488	2	2	0
15B	260-4021-480	CIRCUIT BREAKER	5925-01-133-9488	11	11	0
15B	281-0650-010	KNOB	5355-01-135-4061	1	1	0
15B	426-0038	INDUCTOR, WOU	5950-01-209-2254	1	1	0
15B	426-1034-010	CABLE ASSY	5995-01-173-6417	1	1	0
15B	662-0382-010	TRANSFORMER, POW	5950-00-470-9388	2	2	0
15B	C-8201	CAPACITOR	5910-01-210-1141	1	1	0
15C	10085-0290	CIRCUIT CARD A2A1	5998-01-209-9103	1	1	0
15C	10085-5000	CIRCUIT CARD A1A3	5998-01-162-1107	1	1	0
15C	10085-5200	CIRCUIT CARD A1A7	5998-01-162-1106	1	1	0
15C	10085-5250	CIRCUIT CARD A1A6	5998-01-162-3348	1	1	0
15C	10085-5300	CIRCUIT CARD A1A2	5998-01-162-3347	1	1	0
15C	10085-7000	CIRCUIT CARD A1A13	5998-01-161-7535	2	2	0
15C	10087-2100	CIRCUIT CARD A7A1	5998-01-160-5546	1	1	0
15C	10215-6900	DEMODULATOR	5895-01-484-4260	3	3	0
15D	10085-4210	CIRCUIT CARD A1A15	5998-01-211-5522	1	1	0
15D	10087-4500	LOW PASS FILTER A10	5915-01-159-9643	1	1	0
16A	260-0006-040	CIRCUIT BREAKER	5925-01-133-9487	7	7	0
16A	659-2484-001	IF CHANNEL B	5998-01-306-7209	7	7	0
16A	777-5982-001	DRIVER	5996-01-034-6925	1	4	0
16B	659-2355-002	CONTROL, SERIAL	5998-01-306-7195	13	13	0
16C	635-0656-001	SYNTHESIZER	5998-01-113-7072	3	3	0
16C	642-2451-002	SYTHESIZER	5998-01-306-7187	28	28	0
16D	637-1814-001	AMPLIFIER, RF	5996-01-131-5238	0	2	0
17A	10087-3200	1KW TUBE ASSY A1	5998-01-159-9684	4	5	0
17B	659-9875-001	TRANSLATOR	5820-01-299-9866	13	13	0

17C	687-5579-004	DRIVE, PRIMARY	5895-01-306-7257	5	5	0
17D	10085-4060	LOWPASS FILTE	5998-01-441-7163	1	1	0
17D	10085-9000-30	XCVR CONTROL A1A12	PURCHASE	1	1	0
17D	10086-9200-60	CONTROL PWB	5998-01-434-3682	1	1	0
17D	777-5775-002	FILTER	4130-01-131-2484	9	10	0
17D	10085-9000-01	Controller	5998-01-424-0809	2	2	0
18A	10085-4000	CIRCUIT CARD A1A5	5998-01-161-7537	2	2	0
18A	4CX350AC	ELECTRON T	5960-01-389-9931	0	17	0
18B	4CX350A	ELECTRON TUBE	5960-00-226-5222	0	9	0
18B	T0210	TRANSFORMER	5950-00-117-8540	1	1	0
18C	687-5547-001	PANEL, ASSY	6625-01-309-7606	6	6	0
18D	628-3034-001	CONTROL, CONTACT	5820-01-113-6985	3	3	0
19A	256-0157-000	TUBE	5960-00-116-6566	2	2	0
19A	622-3431-001	CARD, EXTENDER KIT	6625-01-113-9438	1	1	0
19B	10085-0900-01	Systems Handel Assy	5895-01-473-8292	1	1	0
19B	248-0015-010	CAPACITOR, FIXED	5910-01-306-2330	4	5	0
19C	10087-4600	CIRCUIT CARD A3	PURCHASE	0	1	0
20A1	004-0041	BULLET 1-5/8		3	3	0
20A1	004-0067-001	KNOB, BLACK		3	3	0
20A1	004-0067-003	KNOB, GRAY		3	3	0
20A1	031-0048-001	EXTENDER BOARD	5998-01-432-3235	2	2	0
20A2	035-0019-003	MOTOR ACTUATOR		12	12	0
20A3	043-0001	CONTACT SPREADER		2	2	0
20A3	075-0104-001	CONTACT CARD		4	4	0
20A3	081-0089-001	ROTOR ASSY	5930-01-092-5938	13	13	0
20A3	081-0108-001	CONTACT ASSY		3	3	0
20A4	081-0108-002	CONTACT ASSY		3	3	0
20A4	081-0108-004	CONTACT ASSY END		2	2	0
20A4	081-0108-005	CONTACT ASSY		2	2	0
20A5	081-0108-006	CONTACT ASSY		2	2	0
20A5	081-0108-007	CONTACT ASSY		2	2	0
20A6	081-0108-008	CONTACT ASSY		2	2	0
20A6	081-0108-012	CONTACT ASSY		2	2	0
20A6	082-0038	INSULATOR		2	2	0
20B1	362-0048	TRANSFORMER	5950-01-416-1505	5	5	0
20B1	544-0020	IC,OVP		2	2	0
20B1	604-0005	VARISTOR		2	2	0
20B1	618-0023	SOCKET		2	2	0
20B2	618-0075	SOCKET		3	3	0
20B2	618-0076	SOCKET		3	3	0
20B2	622-0007	TERM,CONN,PIN		50	50	0
20B2	622-0073	TERM,CONN,PIN		25	25	0
20B2	632-0015	FUSE		34	34	0
20B2	632-1020	FUSE		25	25	0
20B2	632-1023	FUSE		25	25	0
20B2	632-1032	FUSE		21	21	0
20B2	644-0019	LAMP INCAN		21	21	0
20B3	644-0023	LAMP INCAN		25	25	0
20B3	654-0087	RELAY		4	4	0
20B3	654-0088	RELAY		2	2	0
20B3	654-0106	RELAY		6	6	0
20B3	666-0024	KEYLOCK SWITCH		6	6	0

20C	033-0168-002	ROW DRIVER ASSY		6	6	0
20D	033-0169-001	COLUMN DRIVER		6	6	0
20E1	033-0271-002	Video Assy		1	1	0
20E2	033-0290-001	Serial Interface		2	2	0
20E3	033-0299-001	Row Address		1	1	0
20E3	033-0299-002	COL Address		1	1	0
20E4	033-0299-003	Row Status		1	1	0
20E4	033-0299-004	COL Status		1	1	0
20F1	033-0299-005	INTERLOCK STATUS		1	1	0
20F1	036-0148-001	MICROPROCESSOR		1	1	0
20F2	036-0149-001	MICROPROCESSOR		1	1	0
20F3	033-0299-009	TX/COL PIA ASSY		2	2	0
20F4	033-0299-010	ANT/ROX PIA ASSY		2	2	0
20G1	033-0408-001	VIDEO MEMORY		2	2	0
20G2	033-0443-001	KEYPAD ASSY		3	3	0
20G3	652-0039	POWER SUPPLY		5	5	0
20G4	M2000-355	Monitor Television	5820-01-136-2829	0	1	0
20H	M2000-355	MONITOR TELEVISION	5820-01-136-2829	0	1	0
20H	034-0081-001	POWER SUPPLY		6	6	0
6A1	302-0348-000	WASHER, INSULATOR	5970-00-685-8695	6	6	0
6A1	310-0073-000	WASHER	5310-00-933-8120	6	6	0
6A1	913-0101-000	CAPACITOR	5910-00-668-3647	1	1	0
6A2	015-0514-010	COUPLING, SHAFT	3010-00-944-1438	7	7	0
6A2	310-0292-000	WASHER LOCK	5310-00-984-7042	1	1	0
6A2	705-1030-000	RESISTOR, FIXED	5905-00-060-2469	1	1	0
6A3	190-2322-000	STANDOFF, CERAMIC	5970-00-852-4492	5	5	0
6A3	241-0090-000	CAPACITOR, FIXED	5910-00-669-2649	4	4	0
6A3	422-0802-000	ELECTRICAL, WIRE	6145-00-838-6995	3	3	0
6A3	705-0944-000	RESISTOR	5905-00-186-9044	1	1	0
6A3	705-1111-000	RESISTOR	5905-00-786-3723	1	1	0
6A3	777-6319-002	SEAL		1	1	0
6A4	259-8017-020	SWITCH	5930-01-089-3778	1	1	0
6A4	330884	CONNECTOR PLUG	5935-00-976-1132	25	25	0
6A4	705-1011-000	RESISTOR, FIXED	5905-01-068-9301	1	1	0
6A4	CMR05E620GPDR	CAPACITOR, FIXED	5910-01-059-2478	2	2	0
6A4	JAN1N3003B	SEMICONDUCTOR	5961-00-892-1104	2	2	0
6A4	JANTX1N3003B	SEMICONDUCTOR	5961-01-123-2433	9	9	0
6A5	152-2493-000	SLEEVING	5970-00-899-6660	1	1	0
6A5	259-7201-200	SWITCH	5930-01-087-9918	1	1	0
6A5	259-7201-210	SWITCH	5930-01-087-9919	1	1	0
6A5	262-2798-010	OPTICALLY	5980-01-125-3086	7	7	0
6A5	38-00004-25	SHIELD, ELECTRICAL	5935-01-072-3995	1	1	0
6A5	428-0282-050	ELECTRICAL, WIRE	6145-01-084-1508	1	1	0
6A5	705-1014-000	RESISTOR	5905-00-965-9055	1	1	0
6A5	912-2989-000	CAPACITOR	5910-01-043-4309	1	1	0
6A6	260-1039-010	Circuit Breaker	5925-01-092-2876	4	4	0
6B1	260-1039-120	CIRCUIT BREAKER	5925-01-305-5198	4	4	0
6B2	190-0024-000	INSULATOR	5970-00-318-8753	5	5	0
6B2	302-0347-000	WASHER, INSULATOR	5970-00-705-9527	6	6	0
6B2	553-1064-003	COIL, RF	5950-00-924-0940	4	4	0
6B3	241-0184-000	CAPACITOR, FIXED	5910-00-899-9654	5	5	0
6B3	332-1972-090	ADAPTER, STRAIGHT	4730-00-172-1833	3	3	0

6B3	637-1855-001	DETECTOR, OVERV	5895-01-113-6975	2	2	0
6B3	757-0228-003	KNOB, ROUND	5355-00-253-4199	3	3	0
6B4	249-0005-010	CAPACITOR, FIXED	5910-01-301-2246	14	14	0
6B5	10087-3150	PWB INTRCNCT A9	5998-01-439-3794	1	1	0
6B5	357-9169-000	CONNECTOR PLUG	5935-00-614-3962	3	3	0
6B5	705-1016-000	RESISTOR, FIXED	5905-00-965-9050	1	1	0
6B5	705-1082-000	RESISTOR, FIXED	5905-00-965-9110	1	1	0
6B5	930-0107-010	CAPACITOR	5910-01-123-9767	2	2	0
6B6	10085-0550	CIRCUIT CARD A1A17	5820-01-194-4384	1	1	0
6B6	10086-7200	CIRCUIT CARD A8	5998-01-160-5573	1	1	0
6B6	10087-3170	CIRCUIT CARD A11	5999-01-217-7992	1	1	0
6B6	220-1563-000	SOCKET	5935-00-719-4759	2	2	0
6B6	W58-XB1A6A-20	CIRCUIT BREAKER	5925-01-440-2255	1	1	0
6C1	10085-0570	CIRCUIT CARD A1A16	5895-01-194-8119	1	1	0
6C1	262-1392-030	INDICATOR, DIGITAL	5980-01-088-8708	16	10	0
6C1	JAN2N5241	TRANSISTOR	5961-01-063-9258	1	1	0
6C1	MS16106-4	SWITCH, ROCK	5930-00-892-9246	1	1	0
6C1	RCR32G102JM	RESISTOR, CAR	5905-00-121-9861	1	1	0
6C1	RS14-8-261F	RESISTOR, CAR	5905-00-104-8343	1	1	0
6C1	RW74U1621F	RESISTOR	5905-01-186-6818	1	1	0
6C2	190-0017-000	INSULATOR	5970-00-151-7973	3	3	0
6C2	K20-0002-001	RELAY ASSY A2K1	5945-01-208-6357	1	1	0
6C2	M39003/01-2380	CAPACITOR	5910-01-232-6460	1	1	0
6C2	M39014/02	CAPACITOR	5910-01-311-7340	1	1	0
6C2	S91-0001-002	CIRCUIT BRKR	5925-01-209-2766	1	1	0
6C3	241-0089-000	CAPACITOR, FIXED	5910-00-855-6634	3	3	0
6C3	340-0089-000	RING, RETAINING	5325-00-200-2512	1	1	0
6C3	360-0430-170	JACK TELEPHONE	5935-00-530-4158	3	3	0
6C3	705-1019-000	RESISTOR, FIXED	5905-00-723-6852	1	1	0
6C3	913-0971-000	CAPACITOR	5910-00-191-5635	1	1	0
6C4	310-0779-070	WASHER, FLAT	5310-00-880-5978	7	7	0
6C4	353-3644-010	SEMICONDUCTOR	5961-00-950-6606	8	8	0
6C4	642-2756-002	ABSORBER, OVER	5920-01-310-8120	4	4	0
6C4	705-1064-000	RESISTOR, FIXED	5905-00-965-9090	1	1	0
6C5	260-1039-030	CIRCUIT BREAKER	5925-01-134-1235	6	6	0
6C5	262-2857-010	SEMICONDUCTIVE DEVICE	5961-01-127-6181	7	7	0
6C5	309-0797-000	BEARING SLEEVE	3120-00-690-2749	3	3	0
6C5	A1024	CAPACITOR	5910-00-954-5497	1	1	0
6C6	10085-0216	TRANSFORMER A2T2	5950-01-244-7653	1	1	0
6C6	635-0821-001	CIRCUIT CARD ASSY	5998-01-150-1802	1	1	0
6C6	A1013-29	HDL ALUM BLK	5340-01-163-9424	1	1	0
6C6	D22-0018-000	DIODE, RECT	5961-00-230-8631	1	1	0
6C6	K30-0003-103	RELAY ASSY	5945-01-210-5331	1	1	0
6C6	N10-0002-000	LAMP, NEON	6210-01-210-1926	2	2	0
6C6	S91-0001-006	CKT BREAKER	5925-01-209-2762	1	1	0
6D2	10085-0271	FILTER ASSY	4130-01-226-6384	5	5	0
6D2	10323-2002	KNOB ASSY	5355-00-682-6753	2	2	0
6D2	C11-0022-252	CAPACITOR	5910-01-087-1944	1	1	0
6D2	MP-1481	KNOB	5355-01-212-4710	3	3	0
6D2	RCR32G392JM	Resistor	5905-00-506-8870	5	5	0
6D3	10086-1400	FAN ASSY B1	4140-01-209-0859	1	1	0
6D3	R90-0003-104	RESISTOR	5905-01-210-1637	1	1	0

6D4	10085-2013	SPEAKER A1LS1	5965-01-208-2063	1	1	0
6D4	C21-0006-663	CAPACITOR A2C1	5910-01-245-1996	1	1	0
6D4	D22-5007-080	SEMICONDUCTOR	5961-01-101-1560	1	1	0
6D4	K55-0001-001	RELAY	5945-01-216-6676	1	1	0
6D5	82-3800	Driver, xfmr	5950-01-332-0517	1	1	0
6D5	D22-0018-001	DIODE, RECTIFIER	5961-01-424-2023	1	1	0
6D5	F03-0002-034	FUSE, 10A	5920-01-424-3721	180	180	0
6D5	S12-0003-001	SWITCH A2S2	5930-01-424-2025	1	1	0
6D6	K20-0002-002	RELAY ASSY A2K2	5945-01-208-6358	1	1	0
6D6	L20-0001-006	INDUCTOR, MOLDED	5950-01-462-9597	1	1	0
6D6	S06-003-001	SWITCH A1S1	5920-01-424-5486	1	1	0
6D6	Z03-0001-004	HANDLE	5340-01-096-7167	1	1	0
6D6	Z23-0015-001	GASKET	PURCHASE	1	1	0
6E1	021-0006-383	Capacitor	5910-01-442-5014	1	1	0
6E1	10085-2115	Lamp	6240-01-218-5187	5	5	0
6E1	10087-2010	Filter Media	4130-01-210-1949	5	5	0
6E2	637-9135-001	Elec. Comp Assy	5998-01-118-2756	4	4	0
6E3	10085-0610	Lamp	5955-01-213-6494	1	1	0
6E3	687-2973-008	Microcircuit, Digital	5962-01-306-2524	22	22	0
6E3	K30-0003-87	Relay Assy		1	1	0
6E4	015-0668-000	Coupling, Shaft	3010-00-289-8593	2	2	0
6E4	190-0025-000	Insulator		6	6	0
6E4	266-3065-000	Switch, Toggle		4	4	0
6E4	302-2300-000	Washer, Insulator	5970-00-284-7900	3	3	0
6E4	705-1023-000	Resistor, Fixed	5905-00-052-7829	1	1	0
6E4	705-1036-000	Resistor		1	1	0
6E5	024-0817-010	Tool, Alignment		2	2	0
6E5	241-0088-000	Capacitor, Fixed		3	3	0
6E5	353-3166-020	Semiconductor	5961-01-123-7935	5	5	0
6E5	710-5076-010	RESISTOR, FIXED	5905-00-919-6167	2	2	0
6E6	183-1287-110	Capacitor, Fixed		1	1	0
6E6	190-1143-000	Insulator		3	3	0
6E6	302-0640-190	Washer, Insulator	5970-00-491-0422	5	5	0
6F1	190-1150-000	INSULATOR	5970-00-588-0845	4	4	0
6F1	241-0085-000	CAPACITOR, FIXED		4	4	0
6F1	302-5700-000	WASHER	5970-00-458-8162	4	4	0
6F1	303-1023-000	WASHER, NONMETAL	5365-00-068-0995	3	3	0
6F1	371-0222-000	CONNECTOR, REC.	5935-00-249-1808	1	1	0
6F1	705-1010-000	RESISTOR, FIXED	5905-00-199-6397	1	1	0
6F2	302-0055-000	WASHER, INSULATOR	5365-01-299-8555	11	11	0
6F2	353-6442-030	SEMICONDUCTOR	5961-00-880-2938	3	3	0
6F2	712-4242-000	RESISTOR, FIXED	5905-00-941-4863	1	1	0
6F3	623-2080-002	SYNTHESIZER	5998-01-113-7070	6	6	0
6F4	183-1282-050	CAPACITOR	5910-00-118-7991	2	2	0
6F4	190-1144-000	INSULATOR	5970-00-284-8382	3	3	0
6F4	705-0937-000	RESISTOR, FIXED	5905-00-496-6315	1	1	0
6F4	705-1008-000	RESISTOR	5905-00-913-4330	1	1	0
6F4	705-1020-000	RESISTOR	5905-00-432-0415	1	1	0
6F4	912-4114-180	CAPACITOR	5910-00-901-6511	1	1	0
6F5	240-1626-000	COIL, RF	5950-01-030-1414	7	7	0
6F5	705-1052-000	RESISTOR	5905-00-965-9042	1	1	0
6F5	913-3124-010	CAPACITOR		1	1	0

6F6	553-0980-003	COIL RADIO	5950-00-924-0942	6	6	0
6G1	190-0018-000	INSULATOR	5970-00-151-8012	2	2	0
6G1	371-0170-000	CONNECTOR, REC.	5935-00-259-4690	1	1	0
6G1	750-0541-000	RESISTOR, VARIABLE	5905-00-655-3413	4	4	0
6G2	553-0970-000	COIL, RF DRIVE	5950-00-923-7334	7	7	0
6G3	240-2547-000	COIL, RF	5950-00-796-3120	4	4	0
6G3	262-2828-060	LIGHT IND	6210-01-058-8926	11	11	0
6G3	705-1040-000	RESISTOR	5905-00-965-9086	1	1	0
6G3	777-6216-001	FILTER AIR	5999-00-465-3681	5	5	0
6G4	184-9086-550	CAPACITOR, FIXED	5910-00-861-5108	1	1	0
6G4	746-3151-030	RESISTOR, FIXED	5905-00-469-5838	2	2	0
6G5	288-2154-000	SUPPRESSOR, PAR.	5950-01-318-0324	2	2	0
6G5	687-5597-001	CABLE, POWER	5995-01-309-4434	8	8	0
6G5	756-7544-002	GASKET	5330-00-909-0465	10	10	0
6G5	777-5769-001	SPRING, HEL EXT	5360-00-191-8277	3	3	0
6G5	777-6521-001	CLAMP LOP	5340-00-403-6467	3	3	0
6G6	10087-3233	INDUCTOR, WOUND	PURCHASE	8	8	0
6G6	757-0228-001	KNOB, ROUND	5355-00-931-1492	6	6	0
6G6	777-5823-001	PLATE, INSUL	5970-01-299-8556	8	8	0
6G6	777-6000-004	DETECTOR ASSY	5998-01-113-9505	1	1	0
6H1	747-3660-000	RESISTOR, FIXED	5905-00-549-7846	2	3	0
6H1	750-0504-000	RESISTOR, VARIABLE	5905-00-617-8016	4	4	0
6H2	190-1142-000	INSULATOR	5970-00-809-8207	1	1	0
6H2	705-0950-000	RESISTOR, FIXED	5905-00-307-4104	2	2	0
6H2	705-0953-000	RESISTOR, FIXED	5905-00-140-7162	1	1	0
6H2	705-0996-000	RESISTOR, FIXED	5905-00-432-0381	2	2	0
6H2	777-6547-003	COIL RF	5950-01-088-9613	4	4	0
6H3	190-1156-000	INSULATOR		3	3	0
6H3	266-8397-010	SWITCH, PRESSURE	5930-00-146-4126	3	3	0
6H3	712-4401-260	RESISTOR	5905-01-148-3200	1	1	0
6H4	265-1001-000	CLIP, FUSE	5999-00-761-5892	7	7	0
6H4	371-6225-000	CONNECTOR, PLUG	5935-00-820-2433	1	1	0
6H4	705-1059-000	RESISTOR, FIXED	5905-00-432-0403	1	1	0
6H4	777-6536-001	COIL	5950-00-494-5923	2	2	0
6H4	913-2829-000	CAPACITOR	5910-00-683-3159	5	5	0
6H5	351-1071-020	MICROCIRCUIT	5962-00-145-9823	3	3	0
6H5	777-6308-001	CORE TUNE COIL	5999-00-439-5277	3	3	0
6H5	913-1188-000	CAPACITOR	5910-00-256-4261	3	3	0
6H5	913-1295-000	CAPACITOR	5910-00-260-4342	5	5	0
6H5	913-3279-200	CAPACITOR	5910-00-113-5499	3	3	0
6H5	913-5019-200	CAPACITOR	5910-00-124-0659	1	1	0
6H5	913-5019-320	CAPACITOR	5910-00-113-7672	3	3	0
6H6	777-6544-001	GASKET AIR DUC	5330-00-463-3172	3	3	0
6H6	912-2056-000	CAPACITOR	5910-00-950-2802	9	9	0
6H6	913-4064-000	CAPACITOR	5910-00-804-7566	4	4	0
6H6	933-1081-200	CAPACITOR	5910-00-566-0021	4	4	0
6I1	913-0838-000	CAPACITOR	5910-00-950-6103	3	3	0
6I1	919-0262-120	CAPACITOR	5910-00-998-5564	1	1	0
6I1	SCHS10000	SEMICONDUCTOR	5961-01-087-7096	5	30	0
6I2	458-9009-01	METER TOTAL		3	3	0
6I2	751-8844-002	CABLE, SP		3	3	0
6I2	751-9993-001	IC MEMORY		1	1	0

6I3	249-0008-010	CAPACITOR, VARIABLE	5910-00-998-5564	9	9	0
6I3	371-0182-000	CONNECTOR, REC.	5935-00-583-5956	2	2	0
6I3	450-0151-010	METER, DC CLAMP	6625-01-126-3156	1	1	0
6I3	547-6487-002	CONTACT SPRING	5999-00-944-8555	6	6	0
6I3	RW35V183	RESISTOR, FIXED	5905-00-542-7666	1	1	0
6I4	264-0931-200	FUSE SUBMINIT	5920-00-916-5514	11	11	0
6I4	302-0034-000	WASHER	5310-00-304-9259	4	4	0
6I4	371-0219-000	CONNECTOR, REC.	5935-00-465-4378	2	2	0
6I4	380-3755-250	RESISTER, VARIABLE	5905-01-011-1695	4	4	0
6I4	381-1721-300	RESISTER, VARIABLE	5905-00-509-5124	3	3	0
6I4	381-1721-310	RESISTER, VARIABLE	5905-00-931-2023	2	2	0
6I4	502-6005-002	SPRING	5340-00-090-4035	2	2	0
6I4	553-1054-002	WASHER, INSULATO	5970-00-226-2753	3	3	0
6I5	10073-7208	HINGE FIXED	5340-01-331-0012	1	1	0
6I5	353-6442-070	SEMICONDUCTOR	5961-01-147-8971	9	9	0
6I5	353-6579-030	SEMICONDUCTOR	5961-01-182-6810	7	7	0
6I5	380-3755-230	RESISTER, VARIABLE	5905-01-021-7636	4	4	0
6I5	426-0063-030	CABLE ASSY RF	5995-01-143-7703	3	3	0
6I5	628-3983-001	CONNECTOR, JACK	5305-01-146-9868	3	3	0
6I6	262-2828-010	LIGHT IND	6210-00-058-5120	1	1	0
6I6	262-2828-030	LIGHT IND	6210-00-717-2900	1	1	0
6I6	360-0129-000	JACK TIP	5935-00-615-8555	1	1	0
6I6	371-0168-000	CONNECTOR, REC.	5935-00-702-3446	1	1	0
6I6	371-0220-000	CONNECTOR, REC.	5935-00-327-9301	3	3	0
6I6	372-2601-027	CONTACT, ELECTRICAL	5999-00-409-2663	1	1	0
6I6	373-0084-000	WASHER, LOCK	5310-00-550-3796	4	4	0
6I6	381-1721-290	RESISTER, VARIABLE	5905-00-267-1917	2	2	0
6I6	553-1056-002	WASHER, INSULATO	5310-00-226-2747	3	3	0
7A1	262-0179-010	LAMP	6210-00-763-7744	19	19	0
7A1	357-9292-000	CONNECTOR PLUG	5935-01-043-0629	2	2	0
7A1	361-0062-000	PLUG TIP	5935--00-856-4005	7	7	0
7A1	548-9569-003	WASHER	5310-01-301-4387	11	11	0
7A1	553-1052-002	WASHER, INSULATO	5310-01-088-3401	4	4	0
7A1	751-9993-002	IC, MEMORY		1	1	0
7A2	241-0334-000	CAPACITOR, FIXED	5910-00-980-2045	5	5	0
7A2	310-0093-000	Washer, Lock	5310-01-496-4707	5	5	0
7A2	343-0298-000	SCREW, MACHINE	5305-00-576-6002	8	8	0
7A2	353-0424-010	SEMICONDUCTOR	5961-00-244-7597	9	9	0
7A2	542-1402-002	SLEEVE SPRING	5310-00-421-8259	3	3	0
7A2	543-3492-002	PLATE CAPACITOR	5910-00-843-5757	3	3	0
7A3	262-1461-010	DISPLAY	5980-01-087-2874	3	3	0
7A3	264-0305-000	Fuse		5	5	0
7A3	266-5415-140	SWITCH, TOGGLE	5930-01-131-0407	1	1	0
7A3	306-1090-000	TERMINAL STUD	5940-00-983-0150	4	4	0
7A3	310-0053-010	WASHER, FLAT	5310-00-316-9040	12	12	0
7A3	343-0169-000	A1A1 TUBE CLAMP	5305-00-206-2045	200	200	0
7A3	353-3691-010	SEMICONDUCTOR	5961-00-402-1651	8	8	0
7A3	642-2673-001	WASHER	5310-01-248-9747	8	8	0
7A4	264-4280-000	FUSE	5920-00-850-6091	7	7	0
7A4	353-3591-380	SEMICONDUCTOR	5961-00-472-1293	1	1	0
7A4	381-1721-280	RESISTER, VARIABLE	5905-00-509-5095	2	2	0
7A4	553-1053-002	BOLT, SPECIAL	5306-00-689-7104	2	2	0

7A4	777-6434-001	COUPLING	3010-00-441-4354	2	2	0
7A5	266-5415-120	SWITCH, TOGGLE	5930-01-088-6919	2	2	0
7A5	372-2501-040	CONTACT, ELECTRICAL	5999-01-287-9750	5	5	0
7A5	609-2654-002	WASHER, FLAT	5310-01-301-4386	4	4	0
7A5	637-9022-001	WASHER, FLAT	5310-01-135-4086	2	2	0
7A5	913-0155-050	CAPACITOR	5910-01-136-3823	3	3	0
7A5	913-3612-000	CAPACITOR	5910-00-752-4612	11	11	0
7A6	712-4233-000	RESISTOR, FIXED	5905-00-923-1712	3	3	0
7A6	913-3508-000	CAPACITOR	5910-00-899-2415	4	5	0
7B1	930-0610-000	CAPACITOR	5910-00-988-7896	1	1	0
7B1	930-0787-010	CAPACITOR	5905-01-123-9796	5	5	0
7B2	705-1044-000	RESISTOR, FIXED	5905-00-269-3906	3	3	0
7B2	745-0785-000	RESISTOR, FIXED	5905-00-106-3666	3	3	0
7B2	745-1292-000	RESISTOR, FIXED	5905-00-141-1118	2	2	0
7B2	745-1296-000	RESISTOR, FIXED	5905-00-252-4018	1	1	0
7B2	745-1366-000	RESISTOR, FIXED	5905-00-141-1168	1	1	0
7B2	745-3415-000	RESISTOR, FIXED	5905-00-400-4482	1	1	0
7B2	745-5719-000	RESISTOR, FIXED	5905-00-185-6958	8	8	0
7B2	745-5743-000	RESISTOR, FIXED	5905-00-153-2016	3	3	0
7B3	266-5415-970	SWITCH	5930-01-305-5238	2	2	0
7B3	705-0994-000	RESISTOR, FIXED	5905-00-476-4691	2	2	0
7B3	705-4252-000	RESISTOR, FIXED	5905-00-556-5220	10	10	0
7B3	745-1338-000	RESISTOR, FIXED	5905-00-900-0423	1	1	0
7B3	777-6294-001	SHAFT, COUPLING	3010-00-450-2197	2	2	0
7B4	553-0977-003	COIL, RF	3950-00-924-0949	4	4	0
7B5	10043-0039	VARISTOR	5905-01-303-4533	1	1	0
7B5	260-0952-110	CKT BREAKER	5925-01-305-1965	5	5	0
7B5	443-0949-021	RESISTOR, WIRE WOUND	5905-00-513-2360	1	1	0
7B5	635-0655-001	CIRCUIT CARD	5999-01-124-9156	1	1	0
7B5	RCR42GF102J	RESISTOR, CAR	5905-00-138-4927	1	1	0
7B6	060-0004-001	DIODE, VARIST	5905-01-424-3718	1	1	0
7B6	10087-5224	S2 CROW BAR	5930-01-442-8277	1	1	0
7B6	777-6228-001	CAPACITOR, MICA	5910-00-181-4447	6	6	0
7B6	ERH-25	RESISTOR, FIXED	5905-00-145-9618	1	1	0
7C1	302-0639-030	WASHER, FINISHING	5310-00-872-9784	3	3	0
7C1	705-7048-000	RESISTOR, FIXED	5905-00-538-3258	1	1	0
7C1	745-0701-000	RESISTOR, FIXED	5905-00-811-7912	2	2	0
7C1	745-0797-000	RESISTOR, FIXED	5905-00-824-1729	1	1	0
7C1	745-1300-000	RESISTOR, FIXED	5905-00-104-8345	1	1	0
7C1	745-1359-000	RESISTOR, FIXED	5905-00-195-5514	1	1	0
7C1	745-1370-000	RESISTOR, FIXED	5905-00-195-6741	2	2	0
7C1	745-3352-000	RESISTOR, FIXED	5905-00-824-1732	5	5	0
7C1	745-5652-000	RESISTOR, FIXED	5905-00-195-6814	1	1	0
7C1	L21-6K3F-1Q/1	CORE, ELECTROMAGNETIC	5950-00-001-3256	2	2	0
7C2	547-7844-002	SUPPRESSOR, PARASITIC	5915-00-086-8690	2	2	0
7C2	757-8840-001	COIL	5950-00-863-3168	2	2	0
7C2	845-200-X5W	CAPACITOR	5910-00-067-5918	31	31	0
7C2	CB11RE201G	CAPACITOR	5910-00-134-0626	10	10	0
7C2	CK63AW103M	CAPACITOR	5910-00-822-5683	8	8	0
7C2	MDC89250-5	CONNECTOR, RECEPTACLE	5935-00-729-7305	1	1	0
7C3	262-2171-040	LAMP	6240-00-965-1381	221	221	0
7C3	56-590-65/4A6	SHIELDING BEAD	5950-00-916-8080	3	3	0

7C3	747-3765-000	RESISTOR, FIXED	5905-00-912-8574	3	3	0
7C4	747-1661-000	RESISTOR	5905-00-852-1144	1	4	0
7C4	CB61RF681G	CAPACITOR FIXED MIC	5910-01-123-9800	1	1	0
7C4	HT54T150JA	CAPACITOR	5910-01-026-2180	2	2	0
7C4	MS75103-10	COIL	5950-01-004-7256	11	11	0
7C5	259-9651-030	SWITCH ASSY	5930-01-130-3755	1	1	0
7C5	777-6526-003	NET WORK RF	5915-01-112-2042	2	2	0
7C5	RCR05G472KS	RESISTOR	5905-01-356-7495	1	1	0
7C6	304-0234-000	Terminal, Lug		5	5	0
7C6	750-0511-000	RESISTOR, VARIABLE	5905-00-578-2551	4	4	0
7C6	913-0758-000	CAPACITOR	5910-00-060-1367	2	2	0
7C6	913-3279-270	CAPACITOR	5910-00-113-5465	3	3	0
7C6	913-4754-000	CAPACITOR	5910-00-407-1094	6	6	0
7D1	10073-7210	HINGE	5340-01-332-4619	1	1	0
7D1	352-1043-020	TRANSISTOR	5961-01-135-1325	7	7	0
7D1	751-8822-001	LABEL,REAR PANAL		1	1	0
7D1	913-0760-000	CAPACITOR	5910-00-978-2565	21	21	0
7D1	913-5019-780	CAPACITOR	5910-00-460-0847	3	3	0
7D1	CGF3-2-0030	CAPACITOR	5910-01-301-2148	2	2	0
7D2	1N4753A	DIODE	5961-00-089-3576	10	10	0
7D2	F03A2500V10	FUSE	5920-00-243-3787	2	2	0
7D2	JAN1N4467	SEMICONDUCTOR DEVICE	5961-00-147-9600	9	9	0
7D2	JAN2N2907A	TRANSISTOR	5961-00-925-3777	5	5	0
7D2	MCT-275	INTEGRATED CIRCUIT	5980-01-138-0479	13	13	0
7D2	RNC60H2001	RESISTOR	5905-00-166-3536	4	4	0
7D3	1N5711	DIODE	5961-01-169-4695	24	24	0
7D3	635-0820-001	CIRCUIT CARD	5998-01-113-7080	5	5	0
7D3	H11A1	COUPLER	5980-01-028-0478	30	30	0
7D3	JAN2N3440	TRANSISTOR	5961-00-726-7836	2	2	0
7D3	JAN2N4033	TRANSISTOR	5961-01-047-9231	2	2	0
7D4	RCR42G393	RESISTOR	5905-01-420-2191	10	10	0
BULK-1C	5200-17	TRANS ANALIZER	6625-01-369-9813	3	3	0
BULK-2A	687-5579-001	DRIVE, LOADING	5895-01-306-7258	7	8	0
BULK-2B	637-1297-001	SUPPLY, LO-LEV	6130-01-112-8905	6	6	0
BULK-2C	637-1296-001	SUPPLY, BIAS, PO	6130-01-113-2529	13	13	0
BULK-2D	635-9649-001	SUPPLY, POWER	6130-01-112-8904	6	6	0
BULK-3A	662-0603-010	TRANSFORMER, POW	5950-01-113-6393	4	4	0
BULK-3B	664-0186-010	TRANSFORMER, POW	5950-01-379-8860	7	7	0
BULK-3C	622-3390-006	CONTROL,RADIO SET	5820-01-255-3495	2	2	0
BULK-3D	668-0023-000	INDUCTOR	5950-00-926-0724	4	4	0
BULK-4A	919-0226-020	CAPACITOR	5910-00-761-5738	6	6	0
BULK-4B	919-0227-020	CAPACITOR	5910-00-761-5736	4	4	0
BULK-4C	10087-3700-01	COOLING MOD	5840-01-433-9070	1	1	0
BULK-5	4CX15000A	ELECTRON TUBE	5960-01-160-2440	6	10	0
BULK-6A	664-0116-010	TRANSFORMER, POW	5950-00-470-9376	2	2	0
BULK-6B	777-5994-002	COIL, LOAD	5950-01-085-5439	8	8	0
BULK-6C/D	687-5587-001	ASSEMBLY, BLOWER	4140-01-306-7138	8	9	0

VLF RSS

location	part_num	descr	nsn	qty	auth_qty	ordQty
01A	125517-1	FRAME FOR LARGE BALL ASSY		1	1	0

01B	421040	S/W CONTROL		1	1	0
01B	22DSA32AE	STARTER, REVERSING		1	1	0
01B	14FSt32A	Relay, Overload		1	1	0
01C	E-31467	10AWG 40KVDC style3239 AWM(In Feet)		10	10	0
01C	RP133-4942	S/W CONTROL		3	3	0
01C	E61355	14AWG 40KVDC Style 3239		10	10	0
01D	892SP201K	RESISTOR, FIXED 200 OHMS 750W SUB P/N: 460-3444	5905-00-356-3214	3	3	0
02A1-A	M5060TB600	DIODE MODULE		1	1	0
02A1-B	M4/6 5116	ELECTRONIC EQUIPMENT		22	22	0
02A2-A	969-82	SWITCH, ON/OFF		1	1	0
02A2-B	KLKD 10	Fuse	5920-01-491-5105	100	100	0
02A3-A	G468-0001	SLIM PACK, AC INPU	6110-01-486-8881	1	1	0
02A3-B	0238/13658	FILTER		1	1	0
02A3-C	A110	Pulse Current Transformer		1	1	0
02A4-A	48BSH3M20	Overload Relay		1	1	0
02A4-B	31-209	ADAPTER 90 DEG BNC		8	8	0
02B1-A	233-5039-010	BELT SUB# FS-283		7	7	0
02B1-B	197322-1	ISOLATION XFMR BOARD		2	2	0
02B2-A	MS35769-6	GASKET	5330-01-371-4631	30	30	0
02B2-B	342-0002	RELAY DLA 900 90 M J927	5945-00-088-6212	2	2	0
02B3-A	NAS1515M6H	WASHER, TEFLON FOR WATER TARGETS 10EA B/0...+50	5310-00-242-7596	20	60	40
02B3-B	SCFS10000	SEMICONDUCTOR	5961-01-147-6917	6	6	0
02B4-A	N74HC08N	MICROCIRCUIT, LINEAR	5962-01-279-0145	1	1	0
02B4-B	F206CR7- 28V/20BP	LAMP ASSY	4820-01-306-6122	3	3	0
02B4-C	MS16106-5	SWITCH	5930-00-044-4144	2	2	0
02C1-A	31-2225	CONNECTOR TWIN BNC		3	3	0
02C1-B	0P27GP	MICROCIRCUIT, LINEAR	5962-01-389-2975	1	1	0
02C1-C	3299W-1-103	POT 10K OHMS	5905-01-006-9771	6	6	0
02C2-A	196196-1	CCA (CIRCUIT CARD ASSY)		4	2	0
02C2-B	216002	FUSE 2A		5	5	0
02C2-C	AD630AD	MICROCIRCUIT	5962-01-235-6930	1	1	0
02C3-A	266-9966-010	AUXILARY INTERLOCK KIT		2	2	0
02C3-B	266-9966-030	AUXILARY INTERLOCK KIT		2	2	0
02C3-C	191264-01	Water Target		40	40	0
02C3-D	HVSC5KM-P	RECTIFIER, SEMICONDUCTOR SUB# 171- 2277	5961-01-249-7187	2	2	0
02C4-A	M5D0606S-A	SWITCH, ROTARY	5930-01-451-2949	1	1	0
02C4-B	09-50-3051	CONN,HSG, RECEPT, 5 POS	5935-01-042-7270	10	10	0
02C4-C	09-50-3021	CONN, RECPT, 2 POS	5935-01-088-0760	10	10	0
02D1-A	48ASE3M20	OVERLAOD RELAY ESP100		5	5	0
02D1-B	MS25008-1	Switch, Master, on/off	5930-00-504-6094	2	2	0
02D1-C	27L456	Capacitor		2	2	0
02D2-A	7022AA	RELAY, AGASTAT	5945-00-722-5578	1	1	0
02D2-B	69-10-501-11	KNOB ASSY	5355-01-088-6304	12	12	0

02D3-A	ANSI/UL-153	LAMP		1	1	0
02D3-B	745437 001	DOOR LATCHES		4	4	0
02D3-C	272-1177	HALOGEN LAMP 12VDC, 20W		10	1	0
02E1-A	110-301	TRANSFORMER, CURRENT		1	1	0
02E1-B	EB2030	CKT BKR 30A TEST SET		1	1	0
02E2-A	HSN15-4.5	POWER SUPPLY	6130-01-087-6081	2	2	0
02E3-A	307-0717-00	RESISTOR	5905-01-191-9802	5	5	0
02E3-B	1G379	RES NETWORK 10K OHMS	5905-01-200-7728	1	1	0
02E3-C	LM324N	IC, QUAD OP-AMP	5962-01-357-3501	1	1	0
02F1-A	78675-001	CCA (CIRCUIT CARD ASSY)		1	1	0
02F1-B	889AS221K	RESISTOR 220 OHMS 10%		2	2	0
02F2-A	889AS102K	RESISTOR 1000 OHMS 10%	5905-00-021-6488	6	6	0
02F2-B	UES1106	RECTIFIER, SEMICONDUCTOR	5961-01-188-6042	75	75	0
02F3-A	RW47V820	RESISTOR	5905-00-882-6970	14	14	0
02G1-A	MC74HC02AN	MICRO CIRCUIT	5962-01-372-7419	5	5	0
02G1-B	12PJC14B2	RELAY		6	6	0
02G2-A	LNS-W-24	POWER SUPPLY		1	1	0
02G2-B	FT 141	TRANSFORMER, POWER	5950-00-731-9855	1	1	0
02G3-A	CB3704	CIRCUIT BREAKER	5925-00-660-3817	1	1	0
02G3-B	171-2278	RECTIFIER, SEMICONDUCTOR	5961-01-249-7188	2	2	0
02H1-A	HB1869K	CAPACITOR .15UF/2KV **CORRECTED LOC INFO FM 02H2	5910-00-238-0776	87	88	1
02H2-B	2N335 L25J50K ***ADD	RESISTOR FIXED 50K OHM 25W	5905-00-279-5173	13	14	1
02H3-A	170-0090	DIODE 73-4142	5961-00-470-5077	12	2	0
02I2-B	P/O RESISTOR	INSULATOR BRACKET		1	1	0
02I3-A	889SP200K	RESISTOR, FIXED 20 OHMS, 275	5905-01-148-3211	7	7	0
03A	199044-A	FRAME		1	1	0
03A	VDF 2-8-6.0S	Vacuum Capacitor	5910-00-464-2436	1	1	0
03B	SS BALLS - Large			4	4	0
03C	P32100067	REACTOR	5950-00-925-3803	2	2	0
03C	19 Inch Rack	Ventilating Fan		1	1	0
04A1-A	1492-W4	TERMINAL BOARD	5940-01-418-9292	50	50	0
04A1-B	186518-1	Fiber Assy	4030-01-375-5451	2	2	0
04A1-C	197154-1	ELECTRONIC EQUIPMENT		1	1	0
04A2-A	135118-1	RESISTOR END CAP SILVER PLATED	5935-01-148-6725	10	10	0
04A2-B	905-120-5000	ADAPTER, CONNECTOR	6060-01-206-7388	4	4	0
04A2-C	372-9831-010	ELECTRINIC EQUIPMENT		1	1	0
04A3-A	CM15D300	PS2 12V/.2A PS TUNEPAT	6130-01-100-9979	5	0	0
04A3-B	CM5S2000	PS1 5V/2A PS ENCAP		2	2	0
04A3-C	458-5210-030	ELECTRONIC PART		1	1	0
04A3-D	266-9700-020	MICRO SWITCH		1	1	0
04A4-A	GL-7964	TRIGGERED GAP	5840-00-465-2122	0	2	2
04A4-B	FNM-10	FUSE, DUAL ELEMENT 200A, 250VAC, 10KA, 125VAC		6	6	0

04A4-C	FNM-12	FUSE, DUAL ELEMENT 10 KA, 125VAC		6	6	0
04B1-A	501-0005	SWITCH, BIAS GR	5930-01-147-6900	10	10	0
04B2-A	A1145-0D15-00P3	AC/DC POWER MODULE	6130-01-140-0898	2	2	0
04B2-B	510-0530	TRANSFORMER, PULSE		2	2	0
04B3-A	PART OF C2513	ROD, SPARK GAP (GAS CAP)		13	13	0
04B3-B	PART OF C2513	ROD, SPARK GAP (GAS CAP) Center Conductor		5	5	0
04B4-A	GMD3A	Fuse, Cartridge		14	14	0
04B4-B	Z200S1A3075	GAUGE, PRESSURE SF6 CAP	6685-00-239-5697	2	2	0
04B4-D	PART OF C2513	Rod, Spark Gap Small Center Conductor		3	3	0
04C1-A	LC12RN2	Lens, Light	6210-00-990-4637	5	5	0
04C1-B	JANTX1N1190	Semiconductor	5961-00-154-7046	8	8	0
04C2-A	890AS602K	RESISTOR, 6000 OHMS		3	3	0
04C2-B	HVS10KM	Rectifier Semiconductor	5961-01-249-7186	2	2	0
04C3-A	MCD2711	Switch	5930-00-548-9371	1	1	0
04C3-B	B7200C/ML	Adapter, Connector	5935-00-926-7523	2	2	0
04C3-C	M39012/21-0002	Connector, BNC Jack		2	2	0
04C4-A	Copper Cable #36	Copper Cable #36		30	30	0
04D1-A	182194-1	RELAY ASSEMBLY 103340- 686	5945-00-786-4951	1	1	0
04D1-B	102918-1	SPRING ASSY	5820-00-423-5362	11	11	0
04D2-A	PL 121102	ELECTRONIC PART		2	2	0
04D2-B	343-5241	RELAY ASSEMBLY 103340- 686		1	1	0
04D2-C	150-1127	Circuit Breaker	5925-01-147-8848	1	1	0
04D3-A	M83248/1345	O-RING PA TUBE SOCKET	5331-00-184-3472	23	23	0
04D3-B	ARC CAP BALLS (SM)	ARC CAP BALLS (SM)		2	2	0
04E1-A	197576-1	CCA, CONTRO		1	0	0
04E1-B	197457-1	CCA	5998-01-533-1722	1	1	0
04E2-A	888SP220K	RESISTOR, FIX W.W. 22 OHM 125W		7	7	0
04E2-B	CM51M	POWER SOURCE	6130-01-036-9094	1	1	0
04E3-A	RW47V640	Resistor Set		4	4	0
04E3-B	197447-1	CCA , WAVEFOR		1	1	0
04F1-A	INSULATOR FOR TOP GAS CAP	INSULATOR		8	8	0
04F1-B	510-0138	TRANSFORMER TF4RX03MA		1	1	0
04F1-C	DS26C31TN	IC Quadline Driver	5962-01-370-8083	5	5	0
04F2-A	177243-1	CCA (CIRCUIT CARD ASSY) IPA, SCR CONTROLLER CA		4	3	0
04F2-B	197420-1	CCA SPLITTER PCB		2	2	0
04F3-A	1771-WH	ELECTRONIC PART		2	2	0
04F3-B	1771-WC	ELECTRONIC PART		2	2	0
04G1-A	B2028927	CKT BKR		2	2	0
04G1-B	197656-1	P.S. Fan Out		2	2	0
04G2-A	15-171-399-010	ROLLER BEARING KIT		1	1	0
04G2-B	14-W-DIP-3	SOCKET PLUG-IN	5935-00-172-1447	14	14	0

04G3-A	700-HRQN2GU25	TIMING RELAY		1	1	0
04G3-B	CE3-B100	CKT BKR 100AMP		1	1	0
04H1-A	125463-1	FRAME & MOUNT FOR ARC SENSORS		4	4	0
04H1-B	1N1190A	DIODE PAIRS W/INSULATING BOARD, or 33 individua		18	18	0
04H2-A	RAK 2 3/16	HH BLOWER BALL BEARING		2	2	0
04H3-A	301U160	DIODE 73-4143 ACTUAL LOCATION MAYBE 04H3-B	5961-01-308-4116	13	13	0
04H3-B	026165	RESISTOR 1000 OHMS 10%	4140-00-226-5872	1	1	0
04I1-A	127-0028	ELEC MOTOR TUNING 230-5033-010		2	2	0
04I2-A	A01ED64	SWITCH, AUX	5930-01-414-5900	2	2	0
04I3-A	M4185B1017	Blower Motor, Helix House	6105-00-007-8526	2	2	0
05A	DN7121-2	9 NICHROME WIRE		500	500	0
05B	W89F4-1225X	ADC QCP PANEL		1	1	0
05C	B133	V BELT, HH BLOWER NOT HH Belts Discard		13	13	0
05D-1	1403-LM05A	Power Monitor II LM module (unit ID 080)		1	1	0
05D-2	745-W2-P5-G5-LO	XFMR MANAGEMENT RELAY		1	1	0
05D-3	190-9035-280	PROCESSOR, PROGRAMMABLE LOGIC		1	1	0
06A1-A	974-0076-020	RELAY,ELECTROMAGNETIC		1	1	0
06A1-B	270-3365-010	MODULE UNIVERSAL AC INPUT		1	1	0
06A1-C	027-6004-179	SOCKET PLUG-IN	5935000581741	2	2	0
06A2-A	MS25098 22	SWITCH, TOGGLE 24V PS	5930-00-172-2869	1	1	0
06A2-D	131085-1	OPTICAL ARC SENSOR	5895-01-154-3671	1	1	0
06A4-B	CR103	SEMICONDUCTOR		5	5	0
06A4-C	220-0129	INDICATOR ASSY		7	7	0
06A5-B	890SP	RESISTOR 300 OHMS 10%		1	1	0
06B1-B	510-0430	TRANSFORMER, PULSE	5950-00-460-7958	3	3	0
06B1-D	A2901CR1CR1MP1	NUTS, DIODE		34	34	0
06B2-B	HECSPHH2332TA	CAPACITOR, CERAMIC 3300PF 15KV		0	1	0
06B3-A	5254	TRANSFORMER, PULSE, 15MH 1:1 P/N 5254	5950-00-071-3199	3	3	0
06B4-A	37TB20	TERMINAL BOARD	5940-00-983-6061	1	1	0
06B4-C	RCR07C561JS	Resistor, 560 OHM 10%		9	9	0
06B4-D	8501K4	SWITCH, TOGGLE	5930-00-655-4241	1	1	0
06B5-A	889SP	RESISTOR, 10 OHMS		2	2	0
06B6-B	7555	SWITCH, KNIFE	5930009127555	4	4	0
06C1-B	RT8A-77	JENNINGS BOTTLE		1	1	0
06C1-C	73905/8121	JENNINGS BOTTLE		1	1	0
06C2-A	3486-0092	Capacitor	5910-00-010-8717	10	10	0
06C2-B	CK05BX103K	Capacitor		10	10	0
06C3-A	Flow Meter	Flow Meter (Barnstead Still)		1	1	0

06C4-A	8205-11			4	4	0
06C5-A	905B-50-B	TRANSDUCER, BIDIRECTIONAL		2	2	0
06C5-B	PE-5250	Pulse Engineering		2	2	0
06C5-C	DILB14P-11T		5935-01-116-8976	2	2	0
06C5-D	JANTX15634A	Semiconductor	5961-01-080-0111	3	3	0
06D1-A	CSBF1885WC1- 24V/25-DP	Ranson's Test Fixture Spare Parts		10	10	0
06D2-A	CSBF1885WC5- 24V/25-DP	Ranson's Test Fixture Spare Parts		11	11	0
06D2-B	SW3821	Ranson's Test Fixture Spare Parts		1	1	0
06D2-C	300XBXC1-24A	Ranson's Test Fixture Spare Parts		2	2	0
06F1-A	P-8673	TRANSFORMER, 117VAC- 36VAC		1	1	0
06F1B	27L455	Sola Capacitor		2	2	0
06F3-A	D4C0106N/PA2043	SWITCH FOR TEST PATTERN GENERATOR 1 POLE		1	1	0
06F3-C	M38510/33001BCX	QUAD 2-INPUT NAND		3	3	0
06F5-C	1N6067A	DIODE	5961-01-067-1218	4	4	0
06G4-B	75451N	Microcircuit, Digital		1	1	0
06G5-A	M8340108K2202G C	Resistor	5905-01-287-7511	5	5	0
06H2-A	M38510/11703BXA	VOLTAGE REGULATOR	5962-01-239-4123	4	4	0
06H2-C	8001401ZA	MICROCIRCUIT	5962-01-139-5771	47	47	0
06I2-A	186050-19	CCA, TERMINAL BOAR		2	2	0
06I2-B	LM119J/883B	Microcircuit		7	7	0
06I5-C	MRD300	Semiconductor	5980-00-494-4930	6	12	0
06J1-A	463-5151	RESISTOR FIXED 6 OHM 10% 420W		20	20	0
06J2-A	4771-4	INSUL/STNDOFF, #1868		3	3	0
06J2-B	186008-1	SENSOR ARC INPUT		2	2	0
06J2-C	MWS-650	14 AWG Nickel Chrome Wire		475	475	0
06K1-A	BX116	Belts		4	4	0
06K2-A	ARC CAP BALLS - MED	ARC Cap Balls (MED)		5	5	0
07A	077-05FA-LSNT	AMMETER, 0-50		3	3	0
07A	077-05FA-LSRX	AMMETER, 0-300		4	4	0
07B	077-DIBU-LSPZ-AS	AMMETER, 0-150		1	1	0
07B	077-DIBU-LSSJ-AS	AMMETER, 0-600		1	1	0
07B	077-DIWU-PZWC- AS	VOLTMETER 0-15KV		1	1	0
07C	10 AWG TYPE THW 600V	WIRE		200	200	0
07C	GT015	WIRE, ELEC	6145-00-263-1308	20	20	0
07C	QQR175CUMPOSTI TIONE	WIRE, 14 GAUGE	6145-00-958-2404	600	600	0
07D	GS-60157	CCO POWER SUPPLY SPARE		1	1	0

08A1-C	42R0 1000 S-SIL	RELAY, SOLID STATE		2	2	0
08A2-A	LK 10-105C	CAP 1MFD 1000VVDC		1	1	0
08A2-D	31-3301	CONNECTOR	5935-01-043-0629	5	5	0
08A3-A	MBL 400-R28-7CL1	CCO LIGHTS		6	6	0
08A3-B	2081	EXPLORING COIL	5950-00-962-0262	1	1	0
08A3-C	CQR39AIKF104K3 P	CAPACITOR	5910-01--041-9936	3	3	0
08A3-D	RWR71S4R99FS	RESISTOR	5905-01-173-4874	4	4	0
08A4-A	KLKR1	FUSE	5920-01-257-3534	16	16	0
08C1-A	HVS-10000	DIODE	5961-01-249-5677	3	3	0
08C1-C	DSA 900-68-M- X428	CAP 2.0 10% 200VDC alternate numb	5910-00-078-1930	1	1	0
08C2-B	M5757/23-019	RELAY ARMATURE DPDT 10AMPS 28	5945-01-186-0113	7	7	0
08C2-D	RF717	FILTER, RFI 250VAC 600VDC 1 AMP		2	2	0
08C3-A	1N1190	DIODE	5961-00-892-0838	9	10	1
08C3-B	889AS401K	RESISTOR 400 OHMS 10%		2	2	0
08C4-B	CP72E1EG106K1	CAPACITOR, SPRAGUE 10- 1000 DC		1	1	0
08C5-B	1040-44-713	POWER SUPPLY:DC		1	1	0
08D3-B	22 GA WIRE	FOR MAKING F2101		3	3	0
08D4-B	12PJC14B7	RELAY, OVLD 12PJC14B7	5945-01-147-8064	4	4	0
08E1-A	343-0021	RELAY, OVLD 12PJC14B4	5945-00-918-8808	4	4	0
08E2-A	11857	POWER SUPPLY	5805-00-009-3475	1	1	0
08E2-B	28E15D25	DC/DC CONVERTER		2	2	0
08E5-A	12PJC14B4	RELAY, OVERLOAD	5945-01-088-6212	2	2	0
08F1-A	VPR-20H 4119516	RESISTOR 750 OHMS		11	11	0
08H2-A	DRIVE COUPLER	DRIVE COUPLING		4	4	0
08I1-B	JTS7-1Y	RELAY	5945-01-293-9217	10	10	0
08I2-A	RW38G141	RESISTOR		1	1	0
08I4-A	A6FB	FUSE	5920-00-940-0270	12	12	0
08J1-A	250R40/4	LAMP, HEAT 250W	6240-00-796-8790	5	5	0
08J2-A	143352-1	FIRST EVENT LOGIC ASSEMBLY		2	3	0
08K1-A	308644	METER 0-15KVAC		2	2	0
08K1-B	308626	METER 0-60AMP AC		2	2	0
08K2-A	308631	METER 0-200AMP AC		1	1	0
08K2-B	308632	METER 0-525V AC		1	1	0
08K2-B	308633	METER 0-50AMP AC		1	1	0
09B	TYPE 113	Fan		1	1	0
09C	410-6247-010	RELAY, ELECTROMAGNETIC		1	1	0
09C	410-6248-010	RELAY, ELECTROMAGNETIC		2	2	0
09D	109-0755-010	RESISTOR END CAP NOT PLATED	5905011492379	1	1	0
09D	3C16985B	SWITCH 330 SM 24 PORT		1	1	0
10A1-A	353-5201-010	SEMICONDUCTOR DEVICE, THYRISTOR:PHASE CONTROL	5961-01-533-3180	4	4	0

10A1-B	371-7158-060	CONNECTOR, RECEPTICLE ELECTRICAL:15 SKT CONTACT		2	2	0
10A1-C	372-9619-020	CONNECTOR, RECEPTICLE, ELECTRICAL:15 CONTACT,FE		15	15	0
10A2-A	109-0756-020	MATRIX SWITCH CONTROL MODULE		1	1	0
10A2-B	109-0756-030	MATRIX SWITCH CONTROL MODULE		1	1	0
10A2-C	270-3108-030	POWER MODULE: W/ SWITCH,RF FILTER		1	1	0
10A3-A	NL523W01-008	ISULATOR STANDOFF	5970-01-176-6887	1	1	0
10A3-B	NL523W04-010	ISULATOR STANDOFF	5970-00-499-7782	2	2	0
10A3-C	NL523W03-012	ISULATOR STANDOFF		1	1	0
10A3-D	356-0013-010	KEYING PIN:MEZZANINE CARD CODING PIN		10	10	0
10A3-E	358-1015-080	CONTACT ELECTRICAL: WIRE CRIMP W/INSILATION		5	5	0
10A3-F	283-1035-010	SWITCH, PUSH: 1NC-1NO CONTACTS,10AMP,600V RATIN		1	1	0
10A3-G	358-1017-030	CONTACT, ELEC		25	25	0
10A3-H	220-9086-010	RELAY SOCKET		1	1	0
10A3-I	260-5170-090	SHROUD, REAR CIRCUIT BREAKER		1	1	0
10A4-A	270-3363-020	POWER SUPPLY, DC/DC CONVERTER, 5VDC, 0.200 OUT		2	2	0
10A4-B	270-3340-020	POWER SUPPLY: DC/DC CONVERTER		1	1	0
10A4-C	371-7182-010	CONNECTOR RECEPTICLE, ELECTRICAL:TWINAXIAL,BNC		2	2	0
10A4-D	357-9991-010	CONNECTOR,RACEPTICLE,E LECTRICAL:BNC,PCB MOUNT		2	2	0
10A4-E	379-5031-050	ATTENUATOR,FIXED:COAXIA L,INLINE,10DB NOM,BNC		1	1	0
10A4-F	357-6631-010	CONNECTOR, PLUG, ELECT		2	2	0
10A5-A	270-3364-010	DC/DC CONVERTRER		1	1	0
10A5-C	262-5095-010	LAMP ASSY, LED T1		5	5	0
10A5-D	262-5114-030	LED GREEN		1	1	0
10A6-A	745-5680-000	RESISTOR, FIXED, COMPO		1	1	0
10A6-B	361-5058-030	CONNECTOR PLUG, ELECTRICAL: 16 POSITION		30	30	0
10A6-C	361-5058-060	CONNECTOR PLUG, ELECTRICAL: 26 POSITION		3	3	0
10A6-D	361-5058-090	CONNECTOR PLUG, ELECTRICAL: 40 POSITION		2	2	0
10A6-E	361-5058-100	CONNECTOR PLUG, ELECTRICAL: 50 POSITION		3	3	0

10A6-F	367-5635-010	TERMINAL BLOCK, GROUND		10	10	0
10B1-A	270-3376-010	POWER SUPPLY, 24VDC, SOLA SPC SERIES		1	1	0
10B1-B	270-3366-010	IGNITOR LEAD		1	1	0
10B1-C	664-5043-040	TRANSFORMER,CURRENT:50 OHM IMPEDANCE+/-1%		1	1	0
10B1-D	109-0756-040	POWER SOURCE	6130-01-087-9669	1	1	0
10B2-C	410-6217-010	RELAY, ELETRMAGNETIC		1	1	0
10B2-D	410-6245-010	RELAY, SOLID STATE		1	1	0
10B3-A	MS91587-2	SHUNT,INSTRUMENT:200AM P,50MILLIVOLT,TYPE MS		1	1	0
10B3-B	283-1031-010	MOMENTARY SWITCH		1	1	0
10B3-C	283-1024-010	SWITCH CURRENT SENSITIVE		2	2	0
10B3-D	283-1022-010	EMERGENCY OFF SWITCH		1	1	0
10B3-E	260-5170-070	CB: 1 POLE 20 AMP,20VAC, 28VDC		1	1	0
10B4-A	260-5170-080	CB: 1 POLE 20 AMP,20VAC, 28VDC		1	1	0
10B4-B	264-0291-000	FUSE CARTRIDGE, 1/4 AMP 240VOLT		3	3	0
10B4-C	284-0001-010	CORONA BALL		2	2	0
10B4-D	372-9684-010	CONNECTOR, RECEPTICLE, ELECTRIC:HEADER,26 PIN		2	2	0
10B4-E	372-9684-030	CONNECTOR RECEPTOCLE, ELECTRICAL:16 PIN W/LATCH		15	15	0
10B5-A	351-5332-020	MICROCIRCUIT, DIGITAL		1	1	0
10B5-C	351-4753-010	MICROCIRCUIT, DIGITAL		1	1	0
10B5-D	351-5434-010	MICROCIRCUIT, LINEAR		2	2	0
10B5-E	351-5435-010	MICROCIRCUIT, LINEAR		2	2	0
10B5-F	351-5451-010	MICROCIRCUIT, DIGITAL:12 BIT,ANALOG TO DIGITAL		2	2	0
10B5-G	351-5450-010	MICROCIRCUIT, LINEAR:OP AMP,LOW POWER,MONOLITH		2	2	0
10B5-H	351-5454-010	MICROCIRCUIT, DIGITAL:CMOS,EPROM, 64K,8K X 8		2	2	0
10B6-A	351-5457-010	MICROCIRCUIT, DIGITAL:TTL,DUAL VCO,85MHZ		2	2	0
10B6-B	353-5375-010	SEMICONDUCTOR DEVICE,DIODE:2DIODE MODULE,80AMPS		1	1	0
10B6-C	353-5377-010	RECTIFIER, SEMICONDUCTOR DEVICE:SINGLE PHASE BRI		3	3	0
10B6-D	353-3691-010	TRANSISTOR		4	4	0

10B6-E	353-5340-060	SEMICONDUCTOR DEVICE,DIODE:TRANSIENT SUPP		200	200	0
10B6-G	372-9684-040	CONNECTOR, RECEPTICLE, ELECTRICAL:40 PIN W/LATCH		1	1	0
10C1-A	410-6244-010	RELAY, ELETRMAGNETIC		1	1	0
10C1-B	109-0784-010	MD-1310/U VLF/LV SPARES KIT	6130014089569	1	1	0
10C2-A	274-1212-010	ALARM HORN		1	1	0
10C2-B	410-6238-010	RELAY, ELETRMAGNETIC		1	1	0
10C3-A	109-0783-010	DIGITAL MODULATION	6130014089569	2	2	0
10C3-B	KRPA-11AN-24	RELAY		2	2	0
10C3-C	148527-1	SWITCH, PUSH		3	3	0
10C4-A	410-6097-070	RELAY, 24VAC		10	10	0
10C4-B	D464M-012GA-1	FAN		1	1	0
10C4-B	KDE1205PFB1-8	FAN		1	1	0
10C4-C	015-9963-020	GUIDE, CARD		8	8	0
10C4-D	015-9963-010	GUIDE, CARD		3	3	0
10C5-A	410-6217-020	RELAY, 24VAC		7	7	0
10C5-B	WRENCH	WRENCH		1	1	0
10E1-A	sm-2501	ETHERNET LINK PROTECTOR		1	1	0
10E1-B	Ether Link	Power Supply for Ether Link Protector		1	1	0
10E3-A	1N4056	DIODE	5961-00-498-8463	5	4	0
10F1-A	G438-0001	SLIMPAC		4	4	0
10F2-A	410-6110-070	RELAY, ELETRMAGNETIC		2	2	0
10F3-A	458-5148-010	AMMETER,DC:1MA SENS		1	1	0
10F3-B	458-5148-060	PANEL METER		1	1	0
10F4-A	260-5214-020	CB, 2 AMP		10	10	0
10F4-B	260-5214-030	CB, 5 AMP		4	4	0
10F4-C	260-5214-010	CB, 1 AMP		2	2	0
10F5-A	404-5002-330	RELAY, ELETRMAGNETIC		2	2	0
10F5-B	270-3362-040	RTD FIELD CONFIGURABLE ISOLATOR,SLIMPAC		1	1	0
10G1-A	353-5156-010	RECTIFIER, SEMICONDUCTOR DEVICE:600V,354AMP		15	15	0
10H1-A	352-5068-010	HEAT SINK,ELECTRICAL- ELECTRONIC CCOMPONENT		2	2	0
10I1-A	109-9035-320	CAP 100 pF 200V	5910001135445	2	2	0
10I3-A	75301112C07	Flow Meter		2	2	0
10I3-B	NORGREN	Regulator		1	1	0
10I3-C	311313000	INGOLD		1	1	0
10I4-A	LINKAGE	Linkage HH		2	2	0
10I5-A	Valve	Valve, Permea		2	2	0
10J1-A	109-9035-070	MICROCIRCUIT,DIGITAL:CMO S COMPATIBLE		3	3	0
10J2-A	109-9035-010	MICROCIRCUIT,LINEAR:CMO S,ANALOG SWITCHES		1	1	0

10J2-B	109-9035-260	MICROCIRCUIT,DIGITAL:CMOS,EPROM,256K,16K X 16	1	1	0
10K1-A	270-3377-020	POWER SUPPLY, 24VDC, .27AMP@50C	1	1	0
10K1-B	270-3377-030	POWER SUPPLY, 12VDC, .53AMP@50C	1	1	0
10K2-A	109-9035-300	24V ac/dc Input module	4	4	0
10K2-B	270-3262-030	POWER SUPPLY, DC	1	1	0
11B	9070TF150D20	DUMMY LOAD	1	1	0
11C	109-9035-340	COUPLER,OPTOELECTRONIC	1	1	0
11D	109-9035-270	PLC POWER SUPPLY, EXTERNAL	2	2	0
11D	109-9042-010	MULTIFUNCTION BOARD	2	2	0
12A1-A	419-0059-010	COUPLER, OPTOELECTRONIC	1	1	0
12A1-B	351-5452-010	MICROCIRCUIT, DIGITAL:CMOS,HIGH AND LOW SIDE	50	50	0
12A2-A	351-5390-020	MICROCIRCUIT, DIGITAL	2	2	0
12A2-B	351-5448-010	MICROCIRCUIT, LINEAR:QUAD DIFF LINE DRIVER	24	24	0
12A3-A	351-4747-010	MICROCIRCUIT, DIGITAL	1	1	0
12A3-B	351-5449-010	MICROCIRCUIT, LINEAR:QUAD DIFF LINE RECEIVER	30	30	0
12A4-A	351-5455-010	MICROCIRCUIT, DIGITAL:CMOS,EPROM,256K, 16K X 16	4	4	0
12A4-B	352-5201-010	TRANSISTOR:FET,MOS,N-CHANNEL,500VDSS,20AMP	200	200	0
12A5-A	351-4802-010	MICROCIRCUIT, LINEAR:CMOS:ANALOG SWITCHES	2	2	0
12A5-B	351-5433-010	MICROCIRCUIT, LINEAR	2	2	0
12A6-A	351-5438-010	MICROCIRCUIT, DIGITAL	3	3	0
12A6-B	351-5453-010	MICROCIRCUIT, LINEAR:DIGITAL TO ANALOG CONVERTER	2	2	0
12A6-C	372-9684-050	CONNECTOR, RECEPTICLE, ELECTRIC:HEADER,50 PIN	1	1	0
12C1-A	351-5437-010	MICROCIRCUIT, DIGITAL	1	1	0
12C1-B	458-5206-010	INDICATOR, DIGITAL	1	1	0
12D1-A	191-270-1	Gasket, neoprene Corland Co. P/N B30204C860N	10	10	0
12D1-B	GASKET	GASKET	2	2	0
12D2-A	292100B102J01	CAPACITOR	2	2	0
12D2-B	241-3-120	TRANSFORMER	2	2	0
12D2-C	T7-222F1	SWITCH	1	1	0
12D3-A	A1215R4	RESISTOR	3	3	0
12D3-C	M19500/519	INDICATOR LAMP	1	1	0
12D4-A	889AS501K0DS	Resistor	2	2	0

12D4-B	4570-100-124-1-1	HOLDER		2	2	0
12D5-A	889AS502KDS	Resistor,DUMMY LOAD		2	2	0
12D5-B	888AS331KDS	RESISTOR		1	1	0
12E1-A	109-9035-360	COMMAND RELAY CCA	1130013555543	5	5	0
12E2-A	262-5115-010	LAMP FLUORESCENT, 26WATT		2	2	0
12F1-A	109-0763-020	ANALOG OUTPUT BOARD		1	1	0
12F1-B	96279273 A01	Analog Output Module		2	2	0
12F2-A	394-0021-010	CONNECTOR		1	1	0
12F2-B	109-0763-030	CONNECTOR, BLOCK		1	1	0
12F3-A	028448	BLOWER, ROTRON BT2A1	4140-01-084-0949	1	1	0
12F3-B	DTE6-2RN2	Switch interlock, sensitv	5930-00-904-0521	3	3	0
12J1-A	109-9046-020	INTERFACE MODULE, 1771- OW16		1	1	0
12J1-B	171-0063-010	SOLA SRGE SUPRESSOR		2	2	0
12J2	109-9035-120	PLC POWER SUPPLY SLOT1		2	2	0
12K1-A	109-9047-010	PLC MOD, TTL ANALOG INPUT ISOLATED		2	2	0
12K1-B	109-9035-330	PLC MOD, TTL OUTPUT, 16PT		2	2	0
12K2-A	109-9035-290	PLC MOD, RELAY OUTPUT, 16PT		3	3	0
12K2-B	109-9046-010	INTERFACE MODULE, 1771- IND		3	3	0
13A	VDF 1.4			1	1	0
13C	52151-199045-1	FRAME ASSY		1	1	0
13C	NL-37248	ELEC. TUBE, IGNITRON 1EA TUB	5960-00-153-4669	2	2	0
13C	507807	Transformer, RF		1	1	0
13D	664-5054-010	TRANSFORMER,CURRENT:13 00AMP,RMS		1	1	0
14A1-A	MV5453	LED, GREEN	5961-00-428-3355	6	6	0
14A1-B	2N3114	SEMICONDUCTOR TRANSISTOR	5961-00-905-3233	6	6	0
14A1-C	MP52	LED MTG KIT	5961-01-038-6706	4	4	0
14A2-B	CD4081BD	IC, AND GATE, QUAD 2-IN, 14 PIN	5962-01-086-7029	3	3	0
14A2-C	CD4098BD	IC, MULTIVIBRATOR, DUAL 16 PIN	5962-01-121-7644	3	3	0
14A3-B	M38510/01001BEB	MICROCIRCUIT	5962-00-428-7809	4	4	0
14A3-C	JM38510/00104BC B	MICROCIRCUIT		8	8	0
14A3-D	M38510/01201BCB	MICROCIRCUIT	5962-00-369-7706	3	3	0
14A4-A	3487-0030	CAP. 47 pF 200V	5910-00-117-5499	10	10	0
14A4-B	M38510/00203BCB	MICROCIRCUIT		2	2	0
14A5-C	CD4011BD	IC, NAND GATE, QUAD 2-IN, 14 PIN	5962-01-101-7469	1	1	0
14A6-D	SN34763J	MICROCIRCUIT	5962-01-007-2108	3	3	0
14A6-E	1N3024B	DIODE	5961-00-847-5508	3	3	0

14B1-A	JM38510/00103BC B	MICROCIRCUIT	5962-00-318-2224	2	2	0
14B1-C	RCR07G124JS	RESISTOR	5905-00-400-4528	19	19	0
14B1-D	404093-1	MICROCIRCUIT, DIGITAL	5962-00-220-2425	1	1	0
14B1-E	JM38510/10101BC A	MICROCIRCUIT	5962-00-762-0633	1	1	0
14B2-C	2N2222A	TRANSISTOR	5961-00-858-3826	20	20	0
14B2-D	2N3635	SEMICONDUCTOR	5961-00-026-8833	2	2	0
14B2-E	404093-1	MICRO CIRCUIT	5962-00-220-2425	2	2	0
14B3-A	JM38510/05603BE B	CD4020	5962-01-083-7495	5	5	0
14B3-B	LM118J/883C	MICROCIRCUIT, KEYS AMP	5962-00-615-4997	4	4	0
14B3-C	2N2219A	TRANSISTOR, NPN		21	21	0
14B4-B	BCL4050BC	MICROCIRCUIT	5962-01-033-2282	1	1	0
14B4-C	1N3022B	DIODE	5961-00-026-8851	9	9	0
14B5-A	JM38510/01307BC B	MICROCIRCUIT	5962-00-430-2600	5	5	0
14B6-A	4518BDMQB	MICROCIRCUIT	5962-01-033-2285	3	3	0
14B6-B	CD4016AE	MICROCIRCUIT RCA 210		3	3	0
14B6-C	CD4049AE	IC, HEX BUFFER/CONVERTER, 16 PIN DIP		2	2	0
14B6-D	CD4050AE	IC, HEX BUFFER/CONVERTER, 16 PIN DIP		2	2	0
14C1-A	CD4098BE	IC, MULTIVIBRATOR, DUAL 16 PIN		1	1	0
14C1-B	JM38510/05203BC A	IC, HEX, BUFFER DRIVER, 14 PIN DIP	5962-01-019-6671	2	2	0
14C1-C	F-7408PC-7922	Microcircuit		6	6	0
14C1-E	CD4072BE	MICROCIRCUIT RCA 701		3	3	0
14C1-F	JM38510/01001BE R	8024B CD4050BC		2	2	0
14C1-G	883/4050BC	MICROCIRCUIT	5962-01-131-7815	3	3	0
14C2-A	JM38510/00801BC B	MICROCIRCUIT Y814B 27014		3	3	0
14C2-C	FJM38510/10301B CB	Microcircuit, FJ8408B		7	7	0
14C2-D	LM318J	CIRCUIT	5962-01-072-4975	1	1	0
14C2-E	1N540	DIODE	5961-00-978-7660	13	13	0
14C2-G	M39003/01-2991	CAP	5910-00-007-3974	5	5	0
14C3-A	M39014/2-1338	CAP	5910-00-010-8718	14	14	0
14C3-B	M39018/01-1027P	CAP	5910-01-200-1570	5	5	0
14C3-C	RJR26FW102P	RESISTOR	5905-01-062-8637	2	2	0
14C3-D	FHL18G1-8	FUSEHOLDER, BLOWN FUSE IND.	5920-00-198-4303	1	1	0
14C3-E	FHL17G1	FUSEHOLDER	5920-00-089-4130	1	1	0
14C3-F	RCR32G222JS	RES 2.2K 1W BS	5905-00-111-8372	9	9	0
14C3-G	RCR07G562JS	RES 5.6K OHMS 1/4W BS	5905-00-141-0744	8	8	0
14C4-A	RCR07G150JS	RES 15K OHMS 1/4W BSàERROR! CORRECT VALUE RES 15	5905=00-135-3971	10	10	0

14C4-C	M39014/02-1419	CAPACITOR, 1 UF, 50 V, 10%	5910-01-312-6651	12	12	0
14C4-D	RCR20G221JS	RES 220K OHMS 1/2W BS	5905-00-104-8350	8	8	0
14C4-F	RCR20G101JS	RES 100 OHMS 1/2W BS	5905-00-106-9344	6	6	0
14C4-G	1N3600	DIODE	5961-00-599-5674	16	16	0
14C5-C	500D156G050CB7	CAP	5910-01-033-5939	3	3	0
14C5-D	M39003/01-3094	CAP, 10UF 50VVDC	5910-00-236-8766	8	8	0
14C5-E	M39006/09-8663	250 UF CAP 10 WVDC	5910-01-065-3959	1	1	0
14C5-F	M39006/09-8728	10 UF CAP 50 WVDC	5910-01-036-3581	9	9	0
14D1-A	M39003/01-3138	CAP		12	12	0
14D1-B	1VA-1308	50UF CAP 50VDC		4	4	0
14D1-C	M39006/01-3060	200 UF CAP 15V	5910-00-113-9518	1	1	0
14D1-D	476X9035R2	47 UF CAP 35VDC		1	1	0
14D1-E	1VA-1340	47UF CAP 35VDC		7	7	0
14D1-F	1N3315A	DIODE		2	2	0
14D2-A	M39003/01-3076	CAPACITOR, 1UF, 50V, 10%		17	17	0
14D2-B	2N3439	TRANSISTOR		4	4	0
14D2-C	RCR42G680JS	RES 68 OHMS 2W BS		8	8	0
14D2-D	RC42GF62J	RESISTOR	5905-00-279-2296	6	6	0
14D2-E	1N3829	DIODE		4	4	0
14D2-F	1N538M	DIODE		2	2	0
14D3-A	2N1008B	TRANSISTOR		3	3	0
14D3-B	M39014/02-1338V	CAPACITOR,.001 UF 200V	5910-01-316-7986	5	5	0
14D3-C	1N3189	DIODE		5	5	0
14D3-D	2N930	TRANSISTOR		5	5	0
14D4-A	2N3055	TRANSISTOR		1	1	0
14D4-B	CB150HMS5PCT	RESISTOR	5905-00-126-6691	10	10	0
14D4-C	LN50J 10R	10 OHM 50W NON-INDUCTIVE		1	1	0
14D4-D	RCR20G103JS	RES 10K OHMS 1/2W BS		8	8	0
14D4-E	RW67VR22	RESISTOR		8	8	0
14D4-F	1N1186	DIODE		5	5	0
14D5-B	325ML-902X	CHIP, 2,2,3,3, INPUT NAND	5962-01-117-2594	18	18	0
14D5-C	CM-7218	VERDIAN LAMP		4	4	0
14D5-D	MS24367-683	LAMP, INCAND	6240-00-060-2941	11	11	0
14D5-E	C9097-1768	VERDIN LAMP		10	10	0
14E1-A	MS3338-6839	LAMP, 28V		8	8	0
14E1-B	MT4264C-15/883C	MICROCHIP		1	1	0
14E1-C	MC1084P	MICRO CHIPS		3	3	0
14E1-D	BR8-550A1-26V	Relay		2	2	0
14E1-F	425RB	P921 TECHNITool 6 PIN		1	1	0
14E2-A	HP5082-7000	INDICATOR, DIGITAL		2	2	0
14E2-B	C931610	SOCKET MICROCIRCUIT 16 PIN		35	35	0
14E3-D	28865A	BALL GAP ELECTRODES		4	4	0
14E4-B	314-0232-7408	TRANSFORMER		1	1	0
14E4-D	135118-2	RESISTOR END CAP NOT PLATED		8	8	0
14E5-B	RCR07G473JS	RES 47K OHMS 1/4W BS		19	19	0
14E5-C	RCR07G103JS	RES 10K OHMS 1/4W BS		20	20	0
14E5-E	2N3822	TRANSISTOR		1	1	0
14E5-F	MC7815CK	MICROCIRCUIT		1	1	0

14F1-A	4111885-9	CAP, FIXED		1	1	0
14F1-B	M38510/10301BCB	SEE 1004A1U1		1	1	0
14F1-D	2N3565	TRANSISTOR		1	1	0
14F1-E	1N645	DIODE		19	19	0
14F2-A	RCR07G683JS	RES 68K OHMS 1/4W BS		44	44	0
14F2-C	301842	VALVES, SCHROEDER GAS CAP	4820-01-232-8725	6	6	0
14F2-D	"PLUG, HOLE INSERTS"	PLUG, HOLE INSERT		11	11	0
14F3-A	JM38510/01302BCB	MICROCIRCUIT	5962-00-365-5728	2	2	0
14F3-B	93L01PC	MICROCIRCUIT		2	2	0
14F3-C	JM38510/00701BCB	MICROCIRCUIT		2	2	0
14F3-D	373423-1	MICROCIRCUIT		1	1	0
14F3-E	LM301AH	CIRCUIT		1	1	0
14F4-A	301ML-902 (301BL)	CHIP DUAL 5 INPUT NAND	5962-01-117-2593	12	12	0
14F4-A	333ML-902	MICRO CHIP HEX INVERTER GATE		18	18	0
14F4-B	1N5233BIAW	DIODE		1	1	0
14F4-C	1N914	DIODE		4	4	0
14F4-D	FBN-L169	TRANSISTOR		2	2	0
14G1-A	125487-1	COUNTER ASSY		2	2	0
14G1-B	125484-1	TIMER		2	2	0
14G1-C	125796-1	LAMP LATCH		1	1	0
14G2-A	12548-1	COMBINER, ASSY		1	1	0
14G2-B	125487-2	COUNTER ASSY		1	1	0
14G3-F	BR23D-290A2-28V-022M	RELAY	5945-01-225-8872	5	5	0
14G4-D	MS75103-1	COIL,RF 22UH 10% 750 MA .295 O	5950-01-033-2066	16	16	0
14G5-C	220-1582-010	SOCKET, RELAY		1	1	0
14H1-A	270-3194-020	POWER SUPPLY		2	2	0
14H1-B	270-3194-010	POWER SUPPLY		2	2	0
14H1-C	1N5618	SEMICONDUCTOR DEVICE		16	16	0
14H1-D	353-5214-010	SEMICONDUCTOR DEVICE		2	2	0
14H2-B	M38510/10306BCX	DUAL VOLTAGE COMPARITOR		1	1	0
14H2-E	8302401EX	4-CHANNEL OPTICALLY COUPLED	5962-01-497-8503	6	6	0
14H2-F	M38510/65001BCX	CMOS QUAD 2-INPUT NAND		6	6	0
14H3-A	M38510/33501BCX	MICROCIRCUIT TTL QUAD 2-INPUT OR		6	6	0
14H3-B	M38510/13502BPX	MICROCIRCUIT		1	1	0
14H3-E	M38510/11201BCA	SAME AS A1706A2U14		1	1	0
14H3-F	M38510/34101BCX	SCHOTTKY TTL, DUAL D-TYPE FLIPFLOP		6	6	0
14H4-A	M38510/33301BCX	MICROCIRCUIT		6	6	0
14H4-B	2N2907A	TRANSISTOR		10	10	0

14H4-E	2N6788	TRANSISTOR, MOSFET		10	10	0
14H5-A	8418001XX	MICROCIRCUIT		1	1	0
14H5-B	M38510/11005BCX	LOW POWER QUAD OP AMP		4	4	0
14H5-C	M38510/34001BCX	SCHOTTKY TTL, QUAD 2- INPUT AND alt # 596		1	1	0
14H5-D	M38510/34401BEX	TTL SCHOTTKY 4-BIT DECADE CTR		1	1	0
14H5-E	M38510/65702BCX	HEX INVERTER SCHMITT TRIGGER		1	1	0
14I1-A	M38510/31101BEX	TTL SCHOTTKY 4 BIT COMPARATOR		7	7	0
14I1-B	352-5047-010	SEMICONDUCTOR DEVICE		1	1	0
14I1-D	M38502/1-011	SOCKET PLUG IN	5935-01-232-0975	3	3	0
14I1-E	570-V130LA2013	PART		2	2	0
14I2-A	2943777741	FERRITE BEAD, WOUND 4 1/2 TURN		4	4	0
14I2-B	2N6851	TRANSISTOR, MOSFET, P CHANNEL		1	1	0
14I2-C	1N6283C	DIODE, BIDIRECTIONAL, 26.8V		9	9	0
14I2-E	10MFD200WVDC	CAPACITOR		2	2	0
14I3-B	M39014/01-1317	CAPACITOR, 1000 PF, 200 V, 10%		10	10	0
14I3-C	M39014/01-1339	CAPACITOR, 100 PF, 200 V, 10%		10	10	0
14I3-D	CKR05BX104KR	CAPACITOR, .1 UF, 50 V 10%		5	5	0
14I3-E	CCR06-CG-332JR	CAP		2	2	0
14I3-F	CCR05-CG-470JR	CAP 47 PF 200V		2	2	0
14I4-A	M39014/01-1318	CAPACITOR,.001 UF 200V		5	5	0
14I4-C	M39003/01-7193	RESISTOR, VARIABLE 10K 1/4W		2	2	0
14I4-D	M39003/01-6114	CAPACITOR, 27 UF 35V		2	2	0
14I4-E	CKR06BX105KR	CAPACITOR, .1 UF, 50 V 10%		11	11	0
14I4-F	3610249-001	INTEGRATED CIRCUIT		4	4	0
14I5-A	M39003/01-6203J	CAP 2.2UF 5% 50V		2	2	0
14J1-A	411-5028-020	RELAY, ELETTROMAGNETIC		1	1	0
14J1-B	270-3262-040	POWER SUPPLY, DC		1	1	0
14J1-C	266-9842-010	SWITCH, PRESSURE	5930-01-490-0970	1	1	0
14K1-A	892SP301K	RESISTOR, FIXED 300 OHMS 750W	5905-01-148-3210	3	3	0
14K2-A	ED63A010	Circuit Breaker		2	2	0
14K2-B	A01ED62	SWITCH, TOGGLE	5930-01-336-3016	2	2	0
14K2-C	ED63A050	CIRCUIT BREAKER	5925-01-343-3596	1	1	0
14K3-A	031084	FAN, CENTRIFUGAL	4140-01-451-7042	5	5	0
15A	9170-4006	BLOWER		2	2	0
15A	B2-X-137	Capacitor		1	1	0
15B	125504-1	BALL GAP ASSY, SMALL		1	1	0
15B	RP133-2332-00	IPA Contractor		2	2	0
15C	MAMS-KIT F001	MODULATOR REPAIR KIT - MAMS KIT		1	1	0

16A1-A	HLMP-3300	LED		4	4	0
16A1-B	HLMP-3507	LED GREEN 5V		4	4	0
16A1-C	1N270	DIODE		4	4	0
16A1-E	1N415	DIODE		4	4	0
16A1-F	MC78L12ACP	REGULATOR		2	2	0
16A1-G	1N4745A	DIODE		4	4	0
16A1-H	1N4003	DIODE		4	4	0
16A1-I	1N4728A	DIODE		4	4	0
16A1-J	2N2924-LFS	XT		4	4	0
16A2-A	2N3053	TRANSISTOR	5961-00-985-9073	4	4	0
16A2-B	2N3640	XT		4	4	0
16A2-C	2N4037	XT		4	4	0
16A2-D	11P41B	XT NP2N5293		4	4	0
16A2-E	LM323K	REGULATOR LM323K .05V 3.0A		2	2	0
16A2-F	LM3401-12	RGLTR		2	2	0
16A2-G	MC79L05ACP	REGULATOR		2	2	0
16A2-H	MC79L12ACLP	REGULATOR		2	2	0
16A2-I	MC7805CT	REGULATOR MC7805CT		2	2	0
16A2-J	UA741CP	CIRCUIT		1	1	0
16A3-A	74LS163	IC, COUNTER, 4 BIT BINARY		1	1	0
16A3-B	74LS00	IC NAND GATE, QUAD 2-IN		1	1	0
16A3-C	74LS02	IC, NOR GATE, QUAD 2-IN		1	1	0
16A3-D	74LS04	IC, HEX INVERTER		1	1	0
16A3-E	74LS08	IC AND GATE QUAD 2-IN		1	1	0
16A3-F	74LS10	IC AND GATE, TRIPLE 3-IN		1	1	0
16A3-G	74LS20	IC, NAND GATE, DUAL 4-IN		1	1	0
16A3-H	74LS27	IC, NOR GATE, TRIPLE 3-IN		1	1	0
16A3-I	74LS30	IC, NAND GATE, 8-IN		1	1	0
16A3-J	74LS86	IC, XOR GATE, QUAD 2-IN		1	1	0
16A4-A	SN7406N	IC, HEX, BUFFER DRIVER, 14 PIN DIP		2	2	0
16A4-B	74LS123	IC, MULTIVIBRATOR, DUAL		1	1	0
16A4-C	74LS132	IC, NAND SCHMITT TRIGGER, QUAD 2-IN		1	1	0
16A4-D	74LS138	IC, DECODER/DEMULTIPLEXER, 3-8, 16 PIN DIP		1	1	0
16A4-E	74LS139	IC, DECODER/DEMULTIPLEXER, DUAL 2-4		1	1	0
16A4-F	74LS244	IC, BUFFER DRIVER, 8-BIT 20 PIN DIP		1	1	0
16A4-G	74LS367	IC		1	1	0
16A4-H	SN75452BP	IC, PERIPHERAL DRIVER		1	1	0
16A4-I	SN75472P	IC, NAND		1	1	0
16A4-J	74LS32	IC, OR GATE, QUAD 2-IN		1	1	0
16A5-A	74LS260	IC		1	1	0
16A5-B	74LS240	IC, BUFFER DRIVER, 8-BIT		1	1	0
16A5-C	SN74273	IC, FLIP-FLOP DUAL D TYPE		1	1	0
16A5-D	SN75160N	IC		1	1	0
16A5-E	SN75161BN	IC, TRANSCEIVER		1	1	0

16A5-F	EF6809P	IC		1	1	0
16A5-G	74LS11	IC AND GATE, TRIPLE 3-IN		1	1	0
16A5-H	74LS74	IC, FLIP-FLOP DUAL D TYPE		1	1	0
16A5-I	74LS133	IC, NAND GATE, 13-IN		1	1	0
16A5-J	SN74LS153N	CIRCUIT	5962-01-050-0919	1	1	0
16A6-A	MC14411P	IC, BIT RATE GENERATOR		1	1	0
16A6-B	MC14052BCP	IC DIFFERENTIAL AM 4 CH		1	1	0
16A6-C	AD574AKD	IC, A/D CONVERTER		1	1	0
16A6-D	DL-2416T	DISPLAY 17 SEG 4-DIGIT		1	1	0
16A6-E	AM9128-20PC	IC RAM STATIC 2K X 8		1	1	0
16A6-F	MC6821P	IC, INTERFACE		1	1	0
16A6-G	MC6828P	IC, PROIR INTERRUPT		1	1	0
16A6-H	MC6850P	IC, INTERFACE		1	1	0
16A6-I	HM6264P-15	IC RAM STATIC 8K X 8		1	1	0
16A6-J	MM58167	IC, MICRO COMP		1	1	0
16B1-A	MC68488P	IC, GPIB ADAPTER		1	1	0
16B1-B	X28C256P-30	IC EEPRM 32K X 8 300NS		1	1	0
16B1-C	LM308AN	IC, LM308AN DP AMP PRESSION		1	1	0
16B1-D	LM339N	IC		1	1	0
16B1-E	MC1488P	IC, LINE DRIVER		1	1	0
16B1-F	MC1489P	INTEGRATE CIRCUIT		1	1	0
16B1-G	RC4136N	IC, OP AMP		1	1	0
16B1-H	NE531N	IC, OP AMP		1	1	0
16B1-I	NE555N	IC		1	1	0
16B1-J	XR2206CP	IC, VCO WAVE GENERATOR		1	1	0
16B2-A	XR2211CP	IC, FSK MODEM		1	1	0
16B2-B	MOC-8030	IC OPTOISO		1	1	0
16B2-C	TL072ACP	IC, DUAL OP AMP		1	1	0
16B2-D	AY-5-2376	IC, KEYBOARD ENCODER		1	1	0
16B2-E	LDH3601	LED RED 1.6020 WIDE		4	4	0
16B2-F	550-3006	LED R/G 1.8 AT 10 DIFF		4	4	0
16B2-G	4N25	IC OPTOISO DC IN XT OUT		1	1	0
16B2-H	HLMP-0300	LED RED RECT .10 X 2951N		4	4	0
16B2-I	HLMP-0400	LED YELLOW RECT .10 X .2951N		4	4	0
16B2-J	HLMP-0503	LED GREEN RECT .10 X .2951N		4	4	0
16B3-A	MC7915CT	REGULATOR		2	2	0
16B3-B	MC7912CT	CIRCUIT		2	2	0
16B3-C	74LS245	TRANSCEIVER, 8-BIT		1	1	0
16B3-D	MM74HC32N	IC QUAD		1	1	0
16B3-E	74LS05	IC, HEX INVERTER		1	1	0
16B3-F	CD4040BE	12 STAGE BIN COUNTER		1	1	0
16B3-G	CD4020BE	IC BINARY COUNT/DIVIDER		1	1	0
16B3-H	MAX238CNG	IC RS-232 4 DRV 4 RX		1	1	0
16B3-I	CURRENT RING	CURRENT RING		1	1	0
16B4-A	26-500T	TRANSFORMER, DONUT LARGE		2	2	0
16B4-B	27J CD	CAPACITOR		14	14	0
16B4-C	M83421-01-11735	CAP		2	2	0

16B4-D	NTE5801	DIODE		6	6	0
16B4-E	1N758A	DIODE, ZENER 10.0V 400MW		2	2	0
16B4-F	1N4148	DIODE		11	11	0
16B4-G	CCR06CG682JR	CAP 6800 PF 50V		4	4	0
16B5-A	M39003/01-2295J	CAP 47UF 2N936		2	2	0
16B5-B	1N5622	DIODE, RECTIFIER 1000V 1.0A		23	23	0
16B5-D	KLDR 1/2A	FUSE, CLASS CC, 1/2 AMP		3	3	0
16B5-E	1N6111A	DIODE, BREAKDOWN BIDIRECTIONAL		4	4	0
16B5-G	1N6466	DIODE, TRANSIENT VOLTAGE SUPP		2	2	0
16B6-A	1N6121A	DIODE, BREAKDOWN BIDIRECTIONAL		12	12	0
16B6-C	1N5806	DIODE, RECTIFIER		2	2	0
16B6-D	1N4617	DIODE, BREAKDOWN 2.4V 400MW		7	7	0
16C1-A	M39003/01-7025	@CAP, TANT, 4.7UF, 10V, 20%		4	4	0
16C1-B	M39003/01-6077	CAPACITOR, 10.0 UF 20V		2	2	0
16C1-C	1N6464	DIODE, TRANSIENT VOLTAGE SUPP		8	8	0
16C1-D	AD637KD	IC		1	1	0
16C2-A	AD534KD	MICROCIRCUIT, ANALOG DIVIDER		2	2	0
16C2-B	M74HC02B1	IC		7	7	0
16C2-C	UC3637N	IC		5	5	0
16C2-D	MC74HC27N	IC		10	10	0
16C2-E	AD637KQ	IC		1	1	0
16C2-F	SN75115N	CIRCUIT		10	10	0
16C3-B	2N2222A	TRANSISTOR		6	6	0
16C3-C	1N4614TR	DIODE, ZENER 1.8V 400MW		2	2	0
16C3-D	JM38510/10304BP A	IC		2	2	0
16C3-F	241-3-120	TRANSFORMER, ISOLATION		2	2	0
16C4-A	HTAA-16W-A	DC POWER SUPPLY	6130-01-200-1039	1	1	0
16C4-B	27E891	RELAY SOCKET		3	3	0
16C4-C	KUL-11D15D-24	RELAY, LATCHING, 2PDT 10A		2	2	0
16C4-E	P-8542	TRANSFORMER, 120/40 VCT, 250ma		1	1	0
16D1-A	CHB-38-70001	RELAY, DELAY ON OPERATE 1-10 SE		1	1	0
16D1-B	K50D2	INDUSTRIAL CONTROL TRANSFORMER		1	1	0
16D1-C	CHB-38-30001	RELAY, DELAY ON OPERATE		1	1	0
16D1-D	CHD-38-30021	RELAY, INTERVAL ON, 1-10 SECS		1	1	0
16D1-E	CGD-38-30050M	RELAY, DELAY ON OPERATE		1	1	0
16D1-F	SSRT-120D-25	RELAY		1	1	0
16D2-A	L225J500	RESISTOR, 100K 225W		1	1	0

16D2-B	L225J100K	RESITOR, 500 225W		1	1	0
16D3-A	KHAU-17A16-24V	RELAY, 4PDT 1A, 24 VAC COIL		1	1	0
16D3-C	KHAU-17A13-120	RELAY, 4PDT 2A, 120 VAC COIL		2	2	0
16D3-D	N00126-70-P-3265	RELAY CONTACTOR		1	1	0
16D3-H	226F330P100XX	CAPACITOR, 33 UF 100VDC		18	18	0
16D4-A	1N6283A	DIODE, TRANSIENT SUPPRESSOR		2	2	0
16D4-D	M2285/9-01	SWITCH FOR CCO SYSTEM		1	1	0
16D4-E	RH-25	RES 25 OHMS 25W		2	2	0
16D4-G	1N4004	DIODE		5	5	0
16D4-H	1757019	TERMINAL JUNCTIO BLOCK	5940-01-325-6690	2	2	0
16D5-A	SDHD5KM	SEMICONDUCTOR		4	4	0
16D5-D	905B-200-B	AC CURRENT SENSOR		1	1	0
16D5-E	CGS352U040R2C	CAPACITOR		1	1	0
16D5-F	100JB10L	RESISTOR 470 OHM 2% 1/4W	5905011575608	1	1	0
16E2-A	GBW9401	CIRCUIT CARD	5905000999908	1	1	0
16E3-A	TUNING PATTERN GENERATOR	TUNING PATTERN GENERATOR		1	1	0
16E3-B	54RO8-12 5-0487X	CIRCUIT CARD		1	1	0
16E3-C	20C2792	GP1B 488, EXTENDER CARD		1	1	0
16E4-B	NC2D-DC24V	RELAY, DPDT, 24VDC COIL 5A		10	10	0
16F1-A	9204348	EXT CARD		1	1	0
16F3-A	20D2795	STATUS INPUT		1	1	0
16I1-A	LM319N-V8315	IC CHIP		9	9	0
16I1-B	M74HC132B1	Z991A9344		2	2	0
16I1-C	M74HC08B1	Z994A9331		2	2	0
16I1-D	506-218-AG49D	IC CHIP, SOCKET		1	1	0
16I1-E	CA124E H9331	IC CHIP		2	2	0
16I1-F	S22SA9318	IC CHIP		2	2	0
16I2-A	MT4264C-15/883C	MICROCHIP		26	26	0
16I2-B	R11-62F-9514	NEON LAMP ON/OFF		1	1	0
16I3-A	M74HC4538B1	Z993A9327		2	2	0
16I3-B	M74HC14B1	Z994A9344		2	2	0
16I3-C	208-AG49D	IC SOCKET 8 PIN		8	8	0
16I3-D	27E893	IC SOCKET, 8 PIN		1	1	0
16I3-E	27E894	RELAY SOCKET		5	5	0
16I4-A	21203A	SWITCH, ROTARY, 6 POLE		1	1	0
16I4-C	70RCK4	MOUNTING RACK, I/O MODULE		1	1	0
16I4-D	HLMP-0354	DIODE, LIGHT EMITTING, RED		3	3	0
16I4-E	HAD15-0.4-A	POWER SUPPLY + OR - 15VDC .4A		1	1	0
16J1-A	A41-25-16	SIGNAL TRANSFORMER		1	1	0
16J1-B	105024-001	MICROCIRCUIT	5962012649005	1	1	0
16J2-A	102034-002	Driver Control, CCA		1	1	0

16J3-A	VT-240A	TRANSDUCER, 300 VAC - 1MA DC		1	1	0
16J3-D	UAOKUTV2	PANEL METER FLW		1	1	0
16K1	29450B563J02	Capacitor		14	2	0
16K2	1980	Grid Cap, PA2		3	2	0
17A	314303000	OXYGEN METER		1	1	0
17B	PM-510	METER	6625-01-188-7518	1	1	0
17C	8141-0042	CONDENSER FOR STILL		1	1	0
17D	467-0025	RESISTOR WW 2.5 OHM 1.5KW **REC FOR V389 NEW LO	5905-00-909-1641	6	6	0
18A1-A	PROBE SHIELD FOR STILL	PROBE SHIELD, STILL		2	2	0
18A1-B	CM-10	TIMER		2	2	0
18A1-C	COLLAR FOR MIXED BED FILTER	COLLAR FOR MIXED BEDS		1	1	0
18A1-D	PROBE CONN. FOR STILL	PROBE, CONNECTOR STILL		4	4	0
18A1-E	"GAUGE, GLASS NUT"	GAUGE, GLASS NUT		2	2	0
18A1-F	1/2" PIPE ADAPTOR	1/2" Pipe Adaptor		2	2	0
18A2-A	SIGHT GLASS PROTECTOR	SIGHT GLASS PROTECTOR		3	3	0
18A2-B	DRIP TUBE FOR STILL	DRIP TUBE FOR STILL		2	2	0
18A2-C	EA66	PACKING PERFORMED MILLIPORE		8	8	0
18A2-D	2088	RELIEF VALVE	4820-01-096-9216	3	3	0
18A2-E	CONN. PLUG FOR MILLIPORE	CONNECTOR PLUG FOR MILLIPORE		4	4	0
18A2-F	E-RING NUT FOR Still	E-RING NUT FOR SCALE		5	5	0
18A2-G	CONDESATE TRAP	CONDESATE TRAP		1	1	0
18A3-A	GSX28	O-RING FOR INPUT FILTER +H514		8	8	0
18A3-B	6073	O-RINGS FOR MILLIPORE	5331-01-230-3248	4	4	0
18A3-C	FLAT GASKET FOR STILL	FLAT GASKET FOR STILL		2	2	0
18A4-A	GSX27	O-RING SMALL		5	5	0
18A4-C	15393	FLAT GASKET FOR NEW LOOP		10	10	0
18A4-D	MCT-276	MICROCIRCUIT		5	5	0
18B1-A	8267B15	DRAIN VALVE (STILL)		1	1	0
18B1-B	8262G22	INLET VALVE (STILL)		1	1	0
18B2-B	RE10095	LOCK BLOCK		1	1	0
18B2-C	18-810-250-501	TRIP FREE COUPLING ROD, 5KV		1	1	0
18B2-D	1164-046	TEST PLUG, RELAY		1	1	0
18B3-B	14-145-452-501	VOLTMETER SWITCH		1	1	0
18B3-C	70-1192-300	LENS, GREEN		4	4	0

18B3-D	FRNR5	FUSE, 5 AMP		15	15	0
18B3-E	FRNR10	FUSE 10AMP		15	15	0
18B4-A	14-145-456-501	SWITCH CURRENT, 0 BREAKER		2	2	0
18B4-B	70-1191-300	LENS, RED		4	4	0
18B4-C	70-1310-11-105	HOUSING LAMP		2	2	0
18C3-A	18723775001	BREAKER SWITCH		1	1	0
18C3-B	18-364-346-502	SWITCH, AUX 12 STAGE		1	1	0
18C4-A	00-000-466-771	SWITCH, LIMIT	5930014127756	2	2	0
18C4-B	18-657-852-512	HANDLE, MANUAL CHARGING		1	1	0
18C4-C	15-172-275-003	RELAY, ANT-PUMP, 48 VDC		1	1	0
18D1-A	18-364-501	SWITCH, AUX, 8 STAGE		1	1	0
18D1-B	2441D-18B-2B23	SWITCH, CB CONTROL	5930014130428	2	2	0
18D1-C	2410C-10C-4A13	SWITCH, AMMETER		2	2	0
18D2-A	P/O AUX SWITCH	CB3201 Hardware		1	1	0
18D2-B	C30-2	Fuse Holder		2	2	0
18D2-C	207118	BUS BACK		5	5	0
18D2-D	300005-S	CONTACTS		10	10	0
18D2-E	K2214F1	FUSE		6	6	0
18D3-A	700-601	CURRENT TRANSFORMER 600:5		1	1	0
18E1-C	71-109-293-501	ROTOR ASSEMBLY		10	10	0
18E1-D	1690	Mod valve control board		2	2	0
18E2-A	72-120-237-501	SLIDE FINGERS		2	2	0
18E3-A	18-191-601-501	CABINET AUXILARY SWITCH BUILT		7	7	0
18F1-A	140020-1	PART		4	4	0
18F1-A	140021-1	PART		3	3	0
18F1-A	1/4" SPACER	1/4" SPACER		101	101	0
18F1-A	COPPER CONT. SPRING WASH.	COPPER CONTACT SPRING WASHER		12	12	0
18F1-A	LINKAGE	LINKAGE		15	15	0
18F1-A	UNIVERSAL JOINT	UNIVERSAL JOINT		12	12	0
18F1-B	R3100	DIFFERENTIAL		3	3	0
18F2-A	S2523MP1	CAP KNIFE SWITCH		1	1	0
18F2-B	S2411MP1	TUBE, KNIFE PLATE XFER		1	1	0
18G1-A	05852-12028	FILTER ELEMENT	2910-00-187-4382	1	1	0
18I1-A	52151-197466-1			1	1	0
18I2-A	343-5276	STARTER, MOTOR, MANUAL 10-100SOC		1	1	0
18I2-B	V120MA2B	VARISTOR, METAL OXIDE 120VDC		46	51	5
19A	12063	PATCH PANEL (SM JACKS)		1	1	0
19A	CPM-3092	PATCH PANEL	5820-00-168-3587	1	1	0
19A	SB-3092A/U	PATCH PANEL	5820-01-168-3587	1	1	0
19B	710-301	CURRENT TRANSFORMER 300:5		1	1	0
19B	763X21G18	POTENTIAL TRANSFORMER 35:1		1	1	0
19C	250MOY1	Capacitor	5910-00-224-6235	21	22	1

19D	264C899A07	RELAY OVERCURRENT/TIME/INST		1	1	0
19D	512-0130	TRANSFORMER	6120-00-905-1582	1	1	0
20A1	P20E13	CAPACITOR		1	1	0
20B1-A	5VX950	BELT HELIX HOUSE BLOWER		8	2	0
20C1-A	1S-S	FILTER, RUST AND SEDIMENT		6	6	0
20C2-A	H70	LUG 500MCM		10	10	0
20C2-B	25001	FILTER		12	12	5
20C3-A	PAI.2.703.153	BARNSTEAD VENTGARD		2	2	0
20D1-A	TUBE FILIMENT CLAMP	TUBE FILIMENT CLAMP		8	8	0
20D1-B	TUBE FILIMENT CLAMP	TUBE FILIMENT CLAMP		5	5	0
20D1-C	GRID CLAMP	GRID CLAMP		8	8	0
20D1-D	PLATE CLAMP	PLATE CLAMP		2	2	0
20D2-A	DLA70080ML871	STRAINER		2	2	0
20D2-B	MOD 012093	CONTROLLER		1	1	0
20D2-C	100131LSSC1AAM	AMMETER 4160VAC		1	1	0
20D3	700-301	CURRENT TRANSFORMER 300:5		2	2	0
20E1-A	700-500	CURRENT TRANSFORMER 50:5		2	2	0
20E3-A	9F60BBD905	FUSE, PT, .5 AMP		11	11	0
20F1A	P/O R2401	Parts		120	120	0
20F2-A	P/O R2401	Part		5	5	0
20F2-B	P/O R2401	Part		8	8	0
20G1-A	1681212	RELAY		4	4	0
20H1-B	3M20ES-1	CAPACITOR 20 UF		2	2	0
21C	18-737-104-505	VACUUM TUBE, CB 5KV		5	5	0
21D	DS8024	EPOXY KIT MSDS # ?		8	8	0
22A1-A	07708AALSNT	AMMETER, 0-50		1	1	0
22A1-B	07708AALSXR	RELAY, 4PDT 2A, 24VDC COIL		1	1	0
22A1-C	07708VAPZUL	VOLTMETER, 0-5250	6625012212729	1	1	0
22A2	18-741-414-503	SURGE LIMITER		1	1	0
22B1-B	18-280-275-001	INSULATOR, END CAP		3	3	0
22B2-A	5VX1060	Drive Belts		4	4	0
22C3	270-3254-020	POWER SUPPLY		1	1	0
22D1-A	186050-30	METER DRIVER ASSEMBLY		7	7	0
22E1	MIT-27	Resistor Assy		1	1	0
22E1	P/O Cabinet Slide/Switch	P/O Cabinet Slide/Switch		1	1	0
22E2-B	18-734-984-501	TEST PLUG WITH CABLE, CB		1	1	0
22F1	EA40-NO-60-2-15- ZA-BD	Electronic Component		1	1	0
22F2	21MK1LZ7QZ	PLUG-IN ETHER NET		1	1	0
23B	186013-1	CCA, OPTICAL INTERFACE		1	1	0
23B	343-5271	STARTER FOR MOTOR		2	2	0

23C	662-6289-010	Power xfrmr		1	1	0
23D	5679	XFMR, CURRENT		0	1	0
24A2-A	6.1760.0	Oil Sight Glass		0	1	0
24B2-A	18-741-745-506	SOLENOID, CLOSE 48VDC		1	1	0
24B2-B	18-480-848-001	MOTOR, 48VDC		1	1	0
24B3-A	18-741-413-502	SURGE LIMITER		1	1	0
24B4-A	EF2-B020	CKT CKR 20 AMP 2 PHASE		1	1	0
24B4-C	AM333MG6	CKT BKR 2 AMPS 250V 3 PHASE		1	1	0
24C1-A	WC150PB6	PUSH BUTTON, BLACK, DPDT		1	1	0
24C1-B	MS25089-3CR	PUSH BUTTON, RED, SPDT		1	1	0
24C1-C	80-0533-303	LENS COVER, PANEL LIGHT AMBER		1	1	0
24C1-D	80-0535-303	LENS COVER, PANEL LIGHT, WHITE		3	3	0
24C2-A	HLMP-0580	LIGHT EMITTING DIODE, GREEN		1	1	0
24C3-B	195-BA10	AUXILIARY SWITCH		3	3	0
24C3-C	MS24523-22	TOGGLE SWITCH, SPST		1	1	0
24C4-C	80949	TOGGLE SWITCH, 3-POLE, ON-OFF	5930002293463	1	1	0
24D1-A	WELDING CABLE 2/O AWG 600	WELDING CABLE 2/O AWG 600		7	7	0
24D2-A	109014-001	METER, TUNNING		1	1	0
24D2-B	FILTER MATERIAL	FILTER MATERIAL		2	2	0
24D3-A	4.4576E20110	Kaesar Part		1	1	0
24D3-B	104-A09NJ3	REVERSING CONTACT	5961012497186	1	1	0
24E1-A	CP70E1FM405K1	CAPACITOR, FIX 4MFD 4KV WDCV		2	2	0
24E2-A	RC32GF160J	RESISTOR		10	10	0
24E2-B	RS-2B 125< 1%	RESISTOR		5	5	0
24E2-C	35MB40A	RECTIFIER, BRIDGE		5	5	0
24E2-D	193-A4C1	OVERLOAD RELAY		1	1	0
24E3-A	V12SV	REFRIGERATION ABSORBER		2	2	0
24F1-A	RS-2B 2.5K 1%	RESISTOR		5	5	0
24F1-B	516D226M063LL6A	CAPACITOR, ELECTROLYTIC 22uF 63V		9	9	0
24F1-C	RS-2B 1K 1%	RESISTOR		17	17	0
24F2-A	700-N24	SURGE SUPRESSOR, RELAY ACC.		3	3	0
24F2-D	1N6285C	DIODE, SCHOTTKY, 0.4 VF		4	4	0
24F3-A	RS-2B 600< 1%	RESISTOR		5	5	0
24F3-C	A4017MP1	COVER, PLATE		1	1	0
24G1-A	31618-2	PRESSURE SENSOR		1	1	0
24G1-B	1950-1	SWITCH, EXPLOSION PROOF PRESSURE SW		2	1	0
24G1-C	KHAU-17A11-24	RELAY		1	1	0
24G3-A	700-CPM	RELAY CONTACT CARTRIDGE, MASTER		5	5	0

24G3-B	186369-1	Pulse Shaper CCA		2	1	0
24H1-A	O-Ring	O-Ring		2	0	0
24H1-B	186041-1	CCO STEERING LOGIC		2	2	0
24H2-A	148504-1	CROWBAR CARRIER CUTOFF		1	1	0
24H2-B	K1-7-M02-42-B8-15	Pressure Sensor		1	1	0
24H2-B	MS3116F8-4S	Connector Kit		1	1	0
24H3-A	HH	Litz Jumper		1	1	0
24H3-B	U26	Litz Jumper		1	1	0
24I1-A	07029	HEATING ELEMENT	4540-00-139-4355	4	1	0
25B	M944A1036	MOTOR		2	2	0
25C	TUBE BAKE IN KIT	Tube Bake-in Kit		1	1	0
25C	95846			1	1	0
25D	RESISTOR W/W	Resistor, W/W		8	8	0
26A1-A	E3-16	Filter, Element		4	1	0
26A1-B	E7-16	Filter, Element		3	1	0
26A1-C	S9-16	FILTER ELEMENT		1	1	0
26A2-A	E9-16	Filter, Cartridge		1	1	0
26C2-A	ROLLERS	ROLLERS		4	4	0
26D1-A	6.0215.0/A1	KAESER AIR FILTER ELEMENT +6EA		6	2	1
26D1-B	NON-50	FUSE		7	7	0
26D2-A	6.1876.1/A1	OIL FILTER KAESER COMP - 1E		4	3	0
26D2-B	05.7501.03	KIT, CONDENSATION DRAIN VALVE		1	1	0
26D3-A	6.1985.1/A1	Oil Filter		3	3	0
26D3-B	6.2024.0	Filter Element Oil Separator		1	1	0
26E1-A	HF1-16-3D			1	1	0
26E2-A	E1-16	FILTER ELEMENT		1	1	0
26E2-B	6.2009.0			0	1	0
26E3-A	6.2511.0.EL	Belt		0	2	2
26F1-A	VALVE KAESER KIT	Valve, Kaeser Kit		1	1	0
26F1-B	1452G3	Power Pole Pack		1	1	0
26F2-A	P/O C2501	Assorted Capacitor Parts		1	1	0
26F3-A	WATER SYSTEM PARTS	Water System Parts		1	1	0
26F3-B	P/O C2501	Assorted Capacitor Parts		1	1	0
26G1-A	P/O S26XX	Switch Parts for Unit 26 Knife Switch		1	1	0
26G2-A	P/O UNIT 24	Copper bus work from old plate circuit		6	6	0
26G3-B	P/O UNIT 26	Spacers, Aluminum for Insulator Shims		98	98	0
26H	P/O Old Plate Switch	Parts from Old Plate Switch		1	1	0
26I1-A	P/O Old Plate Switch	Insulator Sticks		20	20	0

26I2-A	P/O Old Plate Switch	Insulator Sticks		20	20	0
26I3-A	P/O Old Plate Switch	Insulator Sticks		22	22	0
27B	SPARE COMBINER	SPARE COMBINER		1	1	0
27C	270-3263-010	CONTROLLER, MONITOR		1	1	0
27D	TKM75W15	CAPACITOR, FIXED 15MFD 7.5 KVDC *** -2EA 3uF15		3	3	0
28A1-A	M39024/11-02	Jack Tip		1	1	0
28A1-B	M39024/11-05	JACK, TIP		10	10	0
28A1-C	M39024/11-08	CONNECTOR TEST POINT YELLOW		7	7	0
28A2-A	37TB10	TERMINAL BLOCK, 10 POS.		1	1	0
28A2-B	40TB10	TERMINAL BOARD		1	1	0
28A2-C	39TB4	TERMINAL BOARD	5940-00-983-6099	1	1	0
28A3-A	39TB5B	TERMINAL BOARD		1	1	0
28A3-B	38TB4B	TERMINAL BOARD		1	1	0
28A4-A	2RV7LYSA103103 A	RESISTOR	5905-01-073-8945	4	4	0
28A4-B	LC21CD3	LENS LIGHT		3	3	0
28A4-C	LH79/1	HOUSING LIGHT		1	1	0
28B1-A	RNR75E1003FS	RESISTOR		8	8	0
28B4-A	G408-0001	SLIM PACK	01-469-9257	3	6	2
28C1-A	INSULATOR BOARD	Insulator Board Filiment		1	1	0
28E	PCL-1020	FILTER, MIXED BE	4610-00-363-5770	3	3	0
28F	PCL-1020	FILTER, MIXED BED	4610-00-363-5770	6	6	0
28G1-A	K1919	RELAY		1	1	0
28G1-A	S/S Box	Stainless Steel Box		1	1	0
28G2-A	7012NC	AGASTAT RELAY	5945-00-869-0804	1	1	0
28G3-A	CS550X1	FILTER HOUSING		1	1	0
28H	PCL-1020	FILTER, MIXED BED	4610-00-363-5770	6	6	0
28I1-A	458-5165-010	VOLTMETER, RMS		6	6	0
34A	E641067	Cable Wire, 600V Type NPLF		1	1	0
34B	PD713-03-N	FILTER CARTRIDGE, FOR OIL PRESS +	4330000819742	28	24	0
34B	23110	FILTER MATL FOR HI SPEED LOOP FILTERS 50#CNT +2EA		2	2	0
35B	P08001KC01	ISULATOR XFMR		2	2	0
35B	TRANSFORMER OIL TEST KIT	TRANSFORMER OIL TEST KIT		1	1	0
35B	144-0720	CAP, FIXED	5910-01-148-7654	1	1	0
35B	06678222-003	MOTOR, 20HP		1	1	0
35Floor	AIR FILTER STATION AIR	AIR FILTER		18	18	0
36A	512-0078	TRANSFORMER, POWER STEP-DOWN		1	1	0
36B	010-0070-030	TRANSMITTER,PRESSURE		3	3	0
36B	010-0070-040	TRANSMITTER,PRESSURE: differential model1151DP4E		2	2	0

36B	109-9035-240	PLC CHASSIS, 16 SLOT		3	3	0
		VALVE, MOTOR OPERATED(WITHOUT CONTROL BOARD)				
36B	332-5596-010			1	1	0
36B	103006449-6591	UPS, 1.5 KVA, EATON 9130		2	2	0
36B	103006448-6591	UPS, 1 KVA, EATON 9130		2	2	0
37A	140065-1	CAP, FIX GAS .025 MFD		2	2	0
37A	10657	Reactor		1	1	0
		CURRENT MONITOR OUTPUT: .001V PER AMP *** ADD				
37B	4906			2	2	0
37B	10657	REACTOR		1	1	0
38B	197417-1	CCA, IPA AMPLIFIER -1		10	3	0
39A	140064-1	CAP VAR GAS 800-5000PF		0	1	0
39A	125517-1	FRAME FOR LARGE BALL ASSY		3	3	0
39B	F17393	ELEC. TUBE WATER JACKET		4	4	0
40B	PP-6483/FRT ***ADD	RECTIFIER SEMICOND(RECT DRAWER) +1E		17	17	0
41B1-01	RJR12FY503P	RESISTOR, VAR 50K OHM 10% 3/4W		3	3	0
41B1-02	M39006/22-0500	CAP 750 UF 10% 10 WVDC		2	2	0
41B1-03	M39014/01-1327V	CAPACITOR 22 PF 10% 200 WVDC		10	10	0
41B1-06	M39024/11-09	JACK, TIP		10	10	0
41B1-07	M8340108K1002G C	RESISTOR		5	5	0
41B1-08	M39003/01-8073	CAPCITOR, 1UF, 50V, 5%		2	2	0
41B1-14	M39003/01-8078	CAP 2.2UF 10% 20 WVDC		4	4	0
41B1-17	M39024/11-03	JACK, TIP		4	4	0
41B1-18	M39024/11-02	JACK, TIP		16	16	0
41B1-20	M39003/01-8103	CAP 10 UF 10% 100 WVDC		4	4	0
41B1-21	F03A125V30AS	FUSE		4	4	0
41B1-24	M55302/58-A56Y	CONNECTOR, RECEPTACLE		2	2	0
41B1-25	M39006/22-0565	CAP 10 UF 10% 100 WVDC		10	10	0
41B1-27	F03A125V30AS	FUSE		4	4	0
41B1-29	M39024/11-07	JACK, TIP		10	10	0
41B1-30	M55302/57-A56Y	CONNECTOR PLUG		2	2	0
41B1-31	M39006/22-0628	CAPCITOR		4	4	0
41B1-32	M39014/02-1358V	CAP. 0.33 UF 10% 50WVDC		2	2	0
41B2-01	RNC60H1500FS	RESISTOR		10	10	0
41B2-03	RCR20G222JS	RES 2.2K OHMS 1/2W BS		10	10	0
41B2-06	RNC60H2150FS	RESISTOR		8	8	0
41B2-07	RNC60H3570FS	RESISTOR		9	9	0
41B2-08	RNC55H1001FP	RESISTOR		10	10	0
41B2-09	RNC60H8871FS	RESISTOR		10	10	0
41B2-10	RCR32G333JS	RES 33K OHMS 1W BS		10	10	0
41B2-11	RNC55H2941FS	RESISTOR		10	10	0
41B2-12	RNC60H1000FS	RESISTOR		10	10	0
41B2-13	RNC60H1650FS	RESISTOR		6	6	0

41B2-16	RNC55H2741FS	RESISTOR		10	10	0
41B2-18	RNC60H2550FS	RESISTOR		10	10	0
41B2-21	RNC60H1004FS	RESISTOR		10	10	0
41B2-23	RNC60H6340FS	RESISTOR		10	10	0
41B2-24	RNC55H1821FS	RESISTOR		10	10	0
41B2-25	RCR20G152JS	RES 1.5K OHMS 1/2W BS		10	10	0
41B2-26	RNC55H5111FS	RESISTOR		10	10	0
41B2-27	RNC55H1002FS	RESISTOR		10	10	0
41B2-29	RNC60H2000FS	RESISTOR		10	10	0
41B2-31	RCR20G391JS	RES 390K OHMS 1/2W BS		10	10	0
41B2-32	RCR42G510JS	RES 51 OHMS 2W BS		10	10	0
41B2-33	RNC55H10ROFS	RESISTOR		10	10	0
41B2-34	RNC55H2002FS	RESISTOR		10	10	0
41B2-35	RNC60H1781FS	RESISTOR		10	10	0
41B3-03	RV4LAYSА103А	RESISTOR	5905-00-518-5595	3	3	0
41B3-12	RV4LAYSА202А	RESISTOR	5905-00-842-3820	1	1	0
41B3-13	40TB12	TERMINAL BOARD		1	1	0
41B3-16	RV4LAYSА501А	RESISTOR		3	3	0
41B3-21	RV4LAYSА151А	RESISTOR	5962010095492	3	3	0
41B4-02	1N5616	SEMICONDUCTOR DEVICE		10	10	0
41B4-05	M38510/13102BPA	MICROCIRCUIT		3	3	0
41B4-06	5962-8962302PX	MICROCUIT		1	1	0
41B4-07	M83502/2-014	SOCKET PLUG IN		2	2	0
41B4-08	1N1202A	DIODE		5	5	0
41B4-09	1N6067A	DIODE		30	30	0
41B4-13	M24308/26-1F	SCREWLOCK, FEMALE		3	3	0
41B4-14	1N4148-1	DIODE		11	11	0
41B4-18	TX4N47	COUPLER, OPTOELECTRONIC		5	5	0
41B4-26	1N5309	DIODE		7	7	0
41B4-32	1N4479	SEMICONDUCTOR		10	10	0
41B5-01	RNC55H2491FS	RESISTOR		10	10	0
41B5-02	RLR07C5602GS	RESISTOR		10	10	0
41B5-03	RLR07C1001GS	RESISTOR		10	10	0
41B5-04	RLR07C3301GS	RESISTOR		15	15	0
41B5-06	RLR07C2202GS	RESISTOR		10	10	0
41B5-07	RNC60H3740FS	RESISTOR		10	10	0
41B5-08	RLR07C5600GS	RESISTOR		10	10	0
41B5-10	RLR07C1002GS	RESISTOR		10	10	0
41B5-11	RLR07C1003GS	RESISTOR		10	10	0
41B5-12	RJR26FX103R	RESISTOR	5905-01-177-2266	2	2	0
41B5-13	RNC60H49R9FS	RESISTOR		10	10	0
41B5-14	RLR07C1201GS	RESISTOR		10	10	0
41B5-15	RLR07C4702GS	RESISTOR		10	10	0
41B5-16	RLR07C4701GS	RESISTOR		10	10	0
41B5-18	RLR07C1103GS	RESISTOR		10	10	0
41B5-19	RJR24FW501P	RESISTOR		2	2	0
41B5-20	RLR07C2701GS	RESISTOR		10	10	0
41B5-21	RLR07C1801GS	RESISTOR		10	10	0
41B5-22	RLR07C1202GS	RESISTOR		10	10	0
41B5-23	RLR07C6802GS	RESISTOR		10	10	0

41B5-24	RJR26FW103R	RESISTOR		12	12	0
41B5-25	RNC60H10ROFS	RESISTOR		10	10	0
41B5-26	RLR07C2200GS	RESISTOR		10	10	0
41B5-28	RLR07C1803GS	RESISTOR		10	10	0
41B5-30	RLR07C1203GS	RESISTOR		10	10	0
41B5-31	RJR26FX503R	RESISTOR		4	4	0
41B5-32	RNC55H2004FS	RESISTOR		10	10	0
41B5-35	RLR07C8201GR	RESISTOR		10	10	0
41B5-36	RJR26FW101R	POT, 100OHM,10T,1/4W		10	10	0
BD2		AIR FILTER, UNIT#45aNEED 18EA PER Q-8R +2		86	35	0
BIG BOX	142-0084	Capacitor	5910-466-2246	1	1	0
BIG BOX	23332E	Coil, RF 1MH		1	1	0
BIG BOX	E16750	Transformer		1	1	0
BIG BOX	23304-E	Inductor 3 Millihenry		2	2	0
BIG BOX	23304-E	Inductor 3 Millihery (MODIFIED)		1	1	0
BIG BOX	23332-1	Inductor		1	1	0
BULK	6696A	TUBE, ELECTRON : 6 new, 3 rebuilt (1EA IN BAKE-	5960011300141	9	4	5
FLOOR	GD60-M-60-3000- 2C-0/9	Ross Relay		1	1	0
FLOOR	125517-1	Ball Gap Assy (LG)	5840-01-154-3670	1	1	0
FLOOR	341-0043	Relay, Electromagnetic		1	1	0
FLOOR	662-6285-010	Transformer		1	1	0
FLOOR	662-6289-010	Transformer		3	3	0
FLOOR	512-0081	Transformer		1	1	0
FLOOR	512-0030	Transformer		4	4	0
FLOOR	662-6265-020	TRANSFORMER, SOLA		1	1	0
FLOOR	18IN185V5000S	Capacitor, Gas		2	2	0
HH	SS BALLS LARGE	SENSOR RING, SMALL (WESTING HOUSE CCO)		3	3	0
TABLE	2A603-203A	SEE C2626	5910-00-929-7551	2	2	0
TABLE	BAKING SODA	BAKING SODA		3	3	0
TABLE	MOD VALVE KIT	MOD Valve Kit		2	2	0
TABLE	343-5279	Starter Motor for Unit 23		1	1	0
TABLE	410-6197-010	Starter		1	1	0
TABLE	DUMMY LOAD RESISTOR	Dummy Load Resistor		12	12	0
TABLE	125504-1	Ball Gap Assy		4	4	0
TABLE	125505-1	Ball Assy		6	6	0
TABLE	230-5105-020	Motor w/Limit Knife Switch XCMD21FZL1		1	1	0
TABLE	LINE AMP	Line Amp for Unit 2		1	1	0
TABLE	H362RB	Heavy Duty Safety Switch		1	1	0
TABLE	23167-D	Inductor		1	1	0

Appendix I-K
Maps

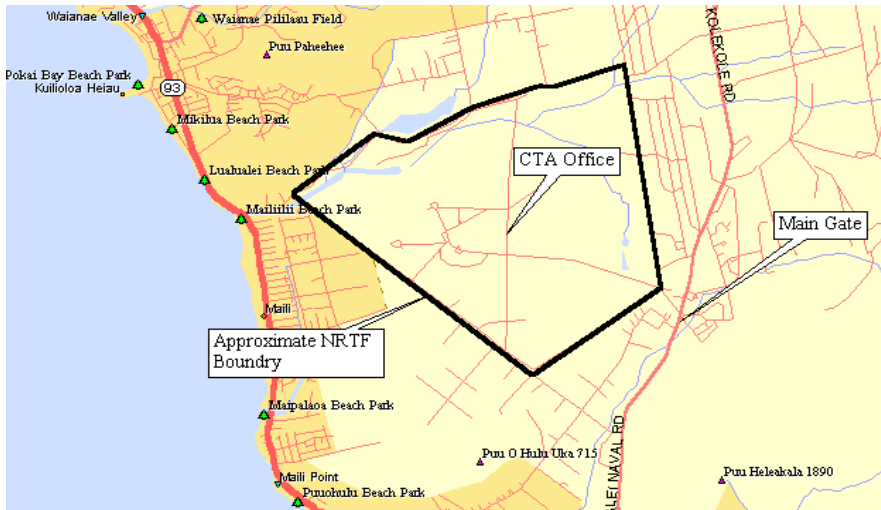

Appendix I-K
Maps

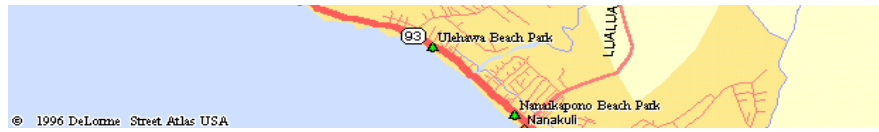

Building 1 Top Floor

Building 1 Top Floor

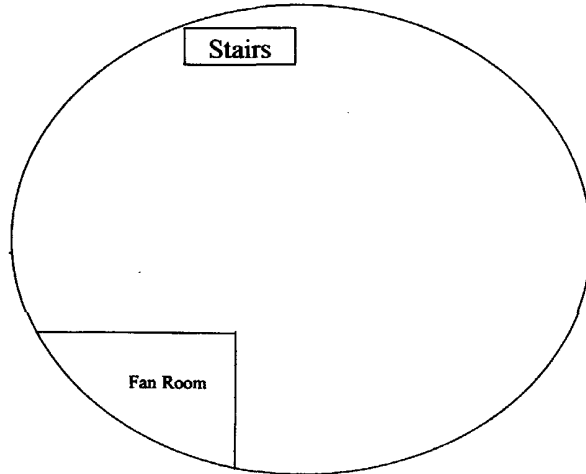

Stairs

Fan Room

Building 1 Lower Floor

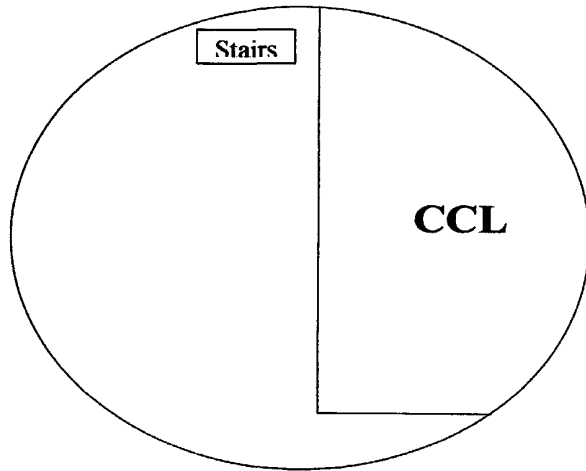

Stairs

CCL