

INSTRUCTIONS FOR INSTALLING THE MODIFICATION KITS
306726 THROUGH 306730, 306986 AND 306987 TO CONVERT
BELL SYSTEM STUNT BOXES FOR USE WITH MODEL 28 83B3
TYPING UNITS (LP)

The chart below pertains to Bell System only

CONVERT FROM TYPING UNIT		RESULTANT TYPING UNIT	
BELL CODE	TELETYPE CODE	BELL CODE	TELETYPE CODE
28D	LP15RX/AR	28AF	LP118RX/AJM
28D		28AK	LP119RX/AJN
28D		28AM	LP121RX/AJQ
28L	LP49RX/AFG	28AF	LP118RX/AJM
28S	LP92RX/AHD	28AK	LP119RX/AJN
28E	LP19RX/AN	28E	LP118RX/AJM
28E	LP19RX/AN	28AM	LP121RX/AJQ

MODIFICATION KIT	TO CONVERT STUNT BOX
306726	AR to AJM (154944 to 199509)
306727	AR to AJN (154944 to 199511)
306728	AR to AJQ (154944 to 199513)
306729	AFG to AJM (162296 to 199509)
306730	AHD to AJN (176487 to 199511)
306986	AN to AJM (152810 to 199509)
306987	AN to AJQ (152810 to 199513)

1. GENERAL

- a. The 306726 through 306730, 306986 and 306987 modification kits convert stunt boxes as shown in the above chart.
- b. These kits contain all the parts, when used with existing parts, necessary to convert the existing stunt box to the stunt box described in each modification kit title. (See charts 1 through 7).
- c. The contents of the kits are shown on the check list found with each modification kit.
- d. The kits covered in this specification are to be used with the 306721 through 306725, 306984, and 306985 modification kits (covered in Teletype Specification 50368S) which convert page printers for use in the 83B3 Selective Calling System as shown on the chart on Page 1.
- e. For parts ordering information refer to Teletype Model 28 Parts Bulletin 1149B.

2. INSTALLATION

a. Figure 1 shows typical assembly of shift slide and the parts in the stunt box slot.

b. Charts 1 through 7 contain the information necessary to make the conversion given in their title. Use the Charts as follows:

(1) The parts in the remove column are either to be discarded or if followed by a number in brackets to be relocated in that number slot.

(2) The parts in the add column are either new parts in the kits or if followed by a number in parentheses taken from that number slot.

(3) The appropriate springs and wicks, shown on Figure 1, must be used in the assembly of the stunt box.

(4) If no mention is made for the removal of a part, it is to be left on the stunt box. The only exception to this is the mounting and wiring of the stunt box contacts. The contacts are to be assembled and wired to the stunt box as shown on the wiring diagram included with each kit. If the wiring diagram does not show the contact assembly being used on the old stunt box, contact assembly and cable should be discarded.

(5) To facilitate the stunt box conversion the selector magnet leads and typing unit connector should be disconnected from the typing unit and kept with the stunt box.

(6) When re-installing the cable assemblies to the typing units and stunt boxes, tie the cable to the stunt box handle and reclamp to the printer side frame.

3. ADJUSTMENTS AND LUBRICATION

a. For standard adjustments and lubrication procedure of related equipment refer to Teletype Model 28 Bulletin 217B (Bell System refer to standard information).

b. Test the converted stunt boxes for proper function in accordance with their individual requirements.

* * *

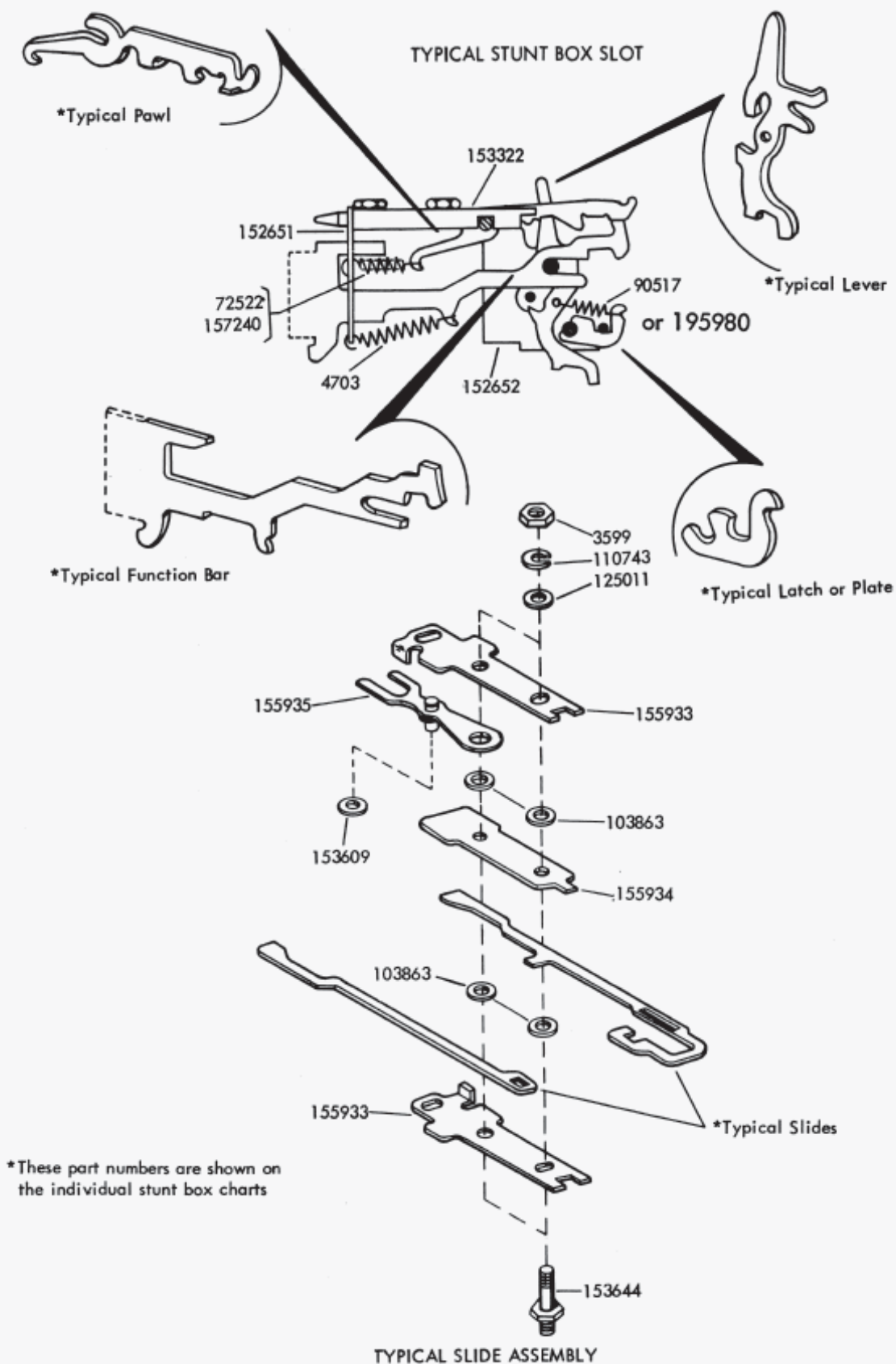

TYPICAL ASSEMBLY OF SHIFT SLIDE AND PARTS IN STUNT BOX SLOTS.

Figure 1.

CONVERSION CHART FOR 306726 MOD. KIT
TO CONVERT AR STUNT BOX TO AJM STUNT BOX

[] Indicates Slot Relocated to

() Indicates Slot Taken From

LOTS	REMOVE			ADD		
	LEVER	Latch or Plate	BAR	LEVER	Latch or Plate	BAR
1						
2						
3						
4				162059(5)	154613(5)	152667 C.R.
5	162059 [4]	154613 [4]		152642	152660(22)	
6				152298	154613	155121 Sel. V.
7				157207	154613	152673 UCH (29)
8				157205	152660(29)	152665 LTR
9				152641(22)	152660(30)	153437 PUCS(30)
10				152121(28)	154613(28)	
11				152121(35)	154613	155112 Sel. M.
12				152298	152089	155121 Sel. V.
13				152641(29)	152660(38)	152668 LF (38)
14				152121	154613	155128 Sel. CR
15				152298	152089	155315 Sel. LF
16				152298	152089	155133 Sel. H
17						
18				152121	152089	155124 Sel. Y
19				152298	152089	155218 Sel. M-V
20				157207	154613	
21				157206	154613	
22	152641 [9]	152660 [5]	152669BL	157207	154613	
23				157206	154613	
24				157207	154613	
25				157206	154613	
26						
27						
28	152121 [10]	154613 [10]	152693 U.C.BL.			
29	152641 [3]	152660 [8]	152673 UCH [7]			
30	152641	152660 [9]	153437 PUCS [9]	152121	154613	152673 UCH
31				154647	152660	152665 LTR
32						
33						
34						
35	152121 [11]			152659		
36						
37				162484	154613	155313 Sel. LTR
38	152641	152660 [3]	152668 LF [3]	163944	154613	155218 Sel. M-V
39						
40						
41						
42						

NOTES:

- See Fig. 1 for typical assembly of shift slides and parts in stunt box slots.
- Use 152653 Pawls in all occupied slots.
- Slot 15-add shift slide assembly using 155946 Slide.
- Use 157274 Function Pawl Clips on Slots 10, 20, 21, 22, 23, 24, 25. These slots are to be equipped in the field with 153440 Function Bars coded in accordance with customer requirements.
- Install 163146 Univ. Contacts Mod. Kit per 58045 Specification.
- Assemble & wire the contacts to the stunt box per 7020WD which is included in the kit.
- Install 155077 Shaft on slots 8 & 31 Function Levers.
- Install 152357 Stud toward slot 1 on slot 38 Function Lever.
- Replace screw stamped AR with screw stamped AJM

CONVERSION CHART FOR 306727 MOD. KIT
TO CONVERT AR STUNT BOX TO AJN STUNT BOX

[] Indicates relocated to

() Indicates Slot Taken From

SLOT	REMOVE			ADD		
	Lever	Latch or Plate	Bar	Lever	Latch or Plate	Bar
1						
2						
3						
4				162059(5)	154613(5)	152667CR
5	162059 [4]	154613 [4]		152642	152660(22)	
6				152298	154613	155121 Sel. V
7				157207	154613	152673UCH(29)
8				157205	152660(29)	152665LTR
9				152641(22)	152660(30)	153437PUCS(30)
10				152121	154613	
11				152121	154613	155112 Sel. M
12				152298	152089	155121 Sel. V
13				152641(29)	152660(38)	155668LF(38)
14				152121	154613	155128 Sel. CR
15				152298	152089	155315 Sel. LF
16				152298	152089	155133 Sel. H
17						
18				152121(35)	152089	155124 Sel. Y
19				152298	152089	155218 Sel. M-V
20				157207	154613	
21				157206	154613	
22	152641 [9]	152660 [5]	152669BL	157207	154613	
23				157206	154613	
24				157207	154613	
25				157206	154613	
26						
27						
28	152121 [30]	154613 [30]	152693UC-BL			
29	152641 [13]	152660 [8]	152673UCH [7]			
30	152641 [41]	152660 [9]	153437PUCS [9]	152121 (28)	154613(28)	152673UCH
31				154647	152660	152665LTR
32						
33						
34						
35	152121 [18]			152659		
36						
37				162484	154613	155313 Sel. LTR
38	152641 [42]	152660 [13]	152668LF [13]	163944	154613	155218 Sel. M-V
39						
40						
41				152641(30)	152660	155131PUCJ
42				152641(38)	152660	155134PUCZ

NOTES:

- See Fig. 1 for typical assembly of shift slides and parts in stunt box slots.
- Use 152653 Pawls, in all occupied slots.
- Slot 15-Add shift slide assembly using 155946 Slide.
- Assemble and wire the contact assembly to the stunt box per 7020WD which is included in the kit.
- Install the 155077 Shaft on slots 8 & 31 Function Levers.
- Replace screw stamped AR with screw stamped AJN
- Install 152357 Stud toward Slot 1 on Slot 38 Function Lever.
- Use 157274 Clip on Slots 10,20,21,22, 23,24, & 25. These slots are to be equipped in the field with 153440 Function Bars, coded to customer requirements.
- Install 163146 Modification Kit: Univ. Contacts per 5804S Specification.

CONVERSION CHART FOR 306728 MOD. KIT
TO CONVERT AR STUNT BOX TO AJQ STUNT BOX

[] Indicates relocated to

() Indicates Slot Taken From

SLOT	REMOVE			ADD		
	Lever	Latch or Plate	Bar	Lever	Latch or Plate	Bar
1						
2						
3						
4				162059(5)	154613(5)	155127P-CR
5	162059 [4]	154613 [4]	152667CR			
6						
7				152121(35)	154613	152673UCH
8				154647	152660(22)	152665LTR
9						
10						
11				157207	154613	152667CR
12				157206	152089	152668LF
13						
14						
15						
16						
17						
18				157207	152089	152702Y
19				157206	152089	199518M-V
20				157207	154613	
21				157206	154613	
22	152641	152660 [8]	152669BL			
23						
24				157207	154613	
25				157206	154613(35)	
26						
27						
28			152693UCBL			152673UCH(29)
29	152641		152673 UCH[23]	154647		152665LTR
30						
31						
32						
33						
34						
35	152121 [7]	154613 [25]	152669BL			
36	152642	152660	152669BL			
37						
38						
39						
40						
41						
42						

NOTES:

- See Fig. 1 for typical assembly of shift slides and parts in stunt box slots.
- Use 152653 Pawls in all occupied slots.
- Wire existing contact assembly per 7021WD which is included with this kit.
- Replace screw stamped AR with screw stamped AJQ.
- Use 157274 Function Pawl clips on slots 20, 21, 24, & 25. These slots are to be equipped with 153440 Function Bars coded to customer requirements.
- Install 154669 Shaft on slots 8 & 29 Function Levers.
- Use 195980 Spring in Slots 12 & 19.

CONVERSION CHART FOR 306729 MOD. KIT
TO CONVERT AFG STUNT BOX TO AJM STUNT BOX

[] Indicates Slot Relocated to

() Indicates Slot Taken From

SLOT	REMOVE			ADD		
	Lever	Latch or Plate	Bar	Lever	Latch or Plate	Bar
1						
2						
3						
4						
5				152642	152660(6)	152667CR
6	152641 [13]	152660 [5]	152668LF [13]	152298(29)	154613(12)	155121 Sel.V(39)
7						
8						
9						
10	157207 [20]			152121(33)		
11	157206 [21]			152121		
12	157207 [22]	154613 [6]		152298	152089(29)	155121 Sel. V
13	157206 [23]	154613 [20]		152641(6)	152660(34)	152668LF(6)
14						
15						
16				152298	152089	155133 Sel. H
17						
18				152121	152089	155124 Sel. Y
19				152298	152089	155218 Sel. M-V
20				157207(10)	154613(13)	
21				157206(11)	154613(28)	
22				157207(12)	154613(33)	
23				157206(13)	154613	
24				157207(28)	154613	
25				157206	154613	
26						
27						
28	157207 24	154613 [21]				
29	152298 [6]	152089 [2]				
30				152121	154613	152673UCH(33)
31				154647(34)	152660(39)	152665LTR(34)
32						
33	152121 [10]	154613 [22]	152673UCH [30]			
34	154647 [31]	152660 [13]	152665LTR [31]			
35						
36						
37						
38						
39	163943	152660 [31]	155121 Sel.V [6]			
40	152641			152642		
41						
42						

NOTES:

- See Fig. 1 for typical assembly of shift slides and parts in stunt box slots.
- Use 152653 Pawls in all occupied slots.
- Slots 28 & 29 remove slide assembly with 162298 Slide.
- Use 157274 Function Pawl Clips on slots 10,20,21,22,23,24,25. These slots are to be equipped in the field with 153440 function bars coded in accordance with customer requirements.
- Assemble & wire the contacts to the stunt box per 7020WD which is included in the kit.
- Install 155077 Rod on slots 8 & 31.
- Replace screw stamped AFG with screw stamped AJM.

CONVERSION CHART FOR 306730 MOD. KIT
TO CONVERT AHD STUNT BOX TO AJN STUNT BOX

[] Indicates Slot Relocated to

() Indicates Slot Taken From

LOTS	REMOVE			ADD		
	Lever	Latch or Plate	Bar	Lever	Latch or Plate	Bar
1						
2						
3						
4						
5				152642	152660(6)	152667CR
6	152641 [13]	152660 [5]	152668LF [13]	152298	154613	155121 Sel. V (39)
7						
8						
9						
10	157207 [20]			152121		
11	157206 [21]			152121		
12	157207 [22]	154613 [22]		152298	152089	155121 Sel. V
13	157206 [23]	154613 [23]		152641(6)	152660(39)	152668LF(6)
14						
15						
16				152298	152089	[55133 Sel. H
17						
18				152121	152089	155124 Sel. Y
19				152298(29)	152089(29)	155218 Sel. M-V
20				157207(10)	154613	
21				157206(11)	154613	
22				157207(12)	154613(12)	
23				157206(13)	154613(13)	
24				157207(28)	154613(28)	
25				157206	154613	
26						
27						
28	157207 [24]	154613 [24]				
29	152298 [19]	152089 [19]				
30				152121(33)	154613(33)	152673UCH(33)
31				154647(34)	152660(34)	152665LTR(34)
32						
33	152121 [30]	154613 [30]	152673UCH [30]			
34	154647 [31]	152660 [31]	152665LTR [31]			
35						
36						
37						
38						
39	163943	152660 [13]	155121 Sel. V [6]			
40	152641			152642		
41						
42						

NOTES:

- See Fig. 1 for typical assembly of shift slides and parts in stunt box slots.
- Use 152653 Pawls in all occupied slots.
- Slots 27, 28, 29, 30 & 31 omit shift slide assembly using 162298 Slides.
- Use 157274 Function Pawl Clips on Slots 10, 20, 21, 22, 23, 24, & 25. These slots are to be equipped in the field with 153440 Function Bars coded in accordance with customer requirements.
- Assemble & wire the contacts to the stunt box per 7020WD which is included in the kit.
- Install the 155077 Rod on Slots 8 & 31 Function Levers.
- Replace screw stamped AHD with screw stamped AJN.

CONVERSION CHART FOR 306986 MOD. KIT:
TO CONVERT AN STUNT BOX TO AJM STUNT BOX

[] Indicates Slot Relocated to

() Indicates Slot Taken From

SLOT	REMOVE			ADD		
	Lever	Latch or Plate	Bar	Lever	Latch or Plate	Bar
1						
2						
3						
4				162059(5)	154613(5)	152667CR(13)
5	162059 [4]	154613 [4]		152642(27)	152660(15)	
6		152089 [6]	155120U		154613(26)	155121 Sel. V
7				157207	154613(13)	152673UCH(11)
8				157205	152660(16)	152665LTR(26)
9				152641(15)	152660(25)	153437PUCS(25)
10			152666FIG			
11	154647	152660	152673UCH [7]	152121(13)	154613	155112 Sel. M
12				152298(14)	152089(14)	155121 Sel. V
13	152121 [1]	154613 [7]	152667CR [4]	152641(16)	152660(27)	152668LF(14)
14	152298 [2]	152089 [2]	152668LF [3]	152121(35)	154613	155128 Sel. CR
15	152641 [9]	152660 [5]	152669BL	152298(28)	152089(28)	155315 Sel. LF
16	152641 [3]	152660 [8]	152668LF	152298	152089(6)	155133 Sel. H
17						
18				152121	152089	155124 Sel. Y
19				152298	152089	155218 Sel. M-V
20				157207	154613	
21				157206	154613	
22				157207	154613	
23				157206	154613	
24				157207	154613	
25	152641	152660 [9]	153437PUCS [9]	157206	154613	
26	154646	154613 [6]	152665LTR [8]			
27	152642 [5]	152660 [3]	155129SP			
28	152298 [5]	152089 [5]	155126UNIV.			
29						
30			152666FIG			152673UCH(31)
31			152673UCH [30]			152665LTR
32						
33						
34						
35	152121 [4]			152659		
36						
37	152642	152660	155130LF	162484	154613	155313 Sel. LTR
38				163944	154613	155218 Sel. M-V
39						
40						
41						
42						

NOTES:

- See Fig. 1 for typical assembly of shift slides and parts in stunt box slots.
- Use 152653 Pawls in all occupied slots.
- Slots 8 & 9 remove slide assembly with 155941 Slide.
- Use 157274 Function Pawl Clips on Slots 10, 20, 21, 22, 23, 24, & 25. These slots are to be equipped in the field with 153440 Function Bars coded in accordance with customer requirements.
- Assemble & wire the contacts to the stunt box per 7020WD which is included in the kit.
- Install 155077 Rod on Slots 8 & 31.
- Replace screw stamped AN with screw stamped AJM.
- Slot 14 & 15 replace 155938 Slide with 155946 Slide.
- Install 163146 Mod. Kit: Univ. Contacts per 5804S Specification.
- Install 152375 Stud toward Slot 1 on Slot 38 Function Lever.

CHART 7

CONVERSION CHART FOR 306987 MOD. KIT;
TO CONVERT AN STUNT BOX TO AJQ STUNT BOX

[] Indicates Slot Relocated to

() Indicates Slot Taken from

SLOT	REMOVE			ADD		
	Lever	Latch or Plate	Bar	Lever	Latch or Plate	Bar
1						
2						
3						
4				162059(5)	154613(5)	155127P,CR
5	162059 [4]	154613 [4]	152667CR			
6	152298	152089 [12]	155120U			
7				152121(10)	154613(10)	152673UCH(11)
8				154647(11)	152660(15)	152665LTR
9						
10	152121 [7]	154613 [7]	152668 FIG.			
11	154647 [8]	152660	152673UCH [7]	157207	154613(13)	152667CR(13)
12				157206	152089(6)	152668LF(14)
13	152121	154613 [11]	152667CR [11]			
14	152298	152089 [18]	152668LF [12]			
15	152641 [30]	152660 [8]	152669BL			
16	152641 [38]	152660 [29]	152668LF [38]			
17						
18				157207	152089(14)	152702Y
19				157206	152089(28)	199518M-V
20				157207	154613(30)	
21				157206	154613(35)	
22						
23						
24				157207	154613(26)	
25	152641	152660 [30]	153437PUCS [30]	157206	154613	
26	154646	154613 [24]	152665LTR [29]			
27	152642	152660	155129SP			
28	152298	152089 [19]	155126UNIV.	152121(30)	154613	152673UCH(31)
29				154647(31)	152660(16)	152665LTR(26)
30	152121 [28]	154613 [20]	152666FIG.	152641(15)	152660(25)	153437PUCS(25)
31	154647 [29]	152660	152673UCH [28]			
32						
33						
34						
35	152121	154613 [21]	152669BL			
36	152642	152660 [38]	152669BL			
37	152642	152660	155130LF			
38				152641(16)	152660(36)	152668LF(16)
39						
40						
41						
42						

NOTES:

- See Fig. 1 for typical assembly of shift slides and parts in stunt box slots.
- Use 152653 Pawls in all occupied slots.
- Wire contact assemblies per 7021WD which is included with this kit.
- Replace screw stamped AN with screw stamped AJQ.
- Use 157274 Function Pawl Clips on slots 20, 21, 24, & 25. These slots are to be equipped with 153440 Function Bars coded to customer requirements.
- Install 154669 Shaft on Slots 8 & 29 Function Levers.
- Use 195980 Spring in Slots 12 & 19.
- Remove shift assemblies at Slot 14 & 15 and Slots 8 & 9.