

INSTRUCTIONS FOR INSTALLING THE 153913 MODIFICATION  
KIT ON A SELECTIVE CALLING MODEL 28 TYPING UNIT LP6  
OR LP9 TO PROVIDE PRINT SUPPRESSION DURING SELECTION  
FOR USE WITH SINGLE LETTER C.D.C. OPERATION

The chart below pertains to Bell System only:

UNIT	TELETYPE CODE	BELL SYSTEM CODE
Typing Unit	LP6, LP9	28B, 28B1 28C through 28G

## 1. GENERAL

a. The 153913 modification kit when installed on a Selective Calling Model 28 Typing Unit LP6 or LP9 provides print suppression of single letter "Call Directing Characters" during selection of stations.

b. The 153913 modification kit consists of:

4	3599	Nut	2	153647	Plate
3	71073	Washer, Flat	1	153795	Slide
4	110743	Lockwasher	1	158300	Fork w/Post
3	119648	Retainer, Ring	1	158301	Fork w/Post
3	125011	Washer, Flat	1	158302	Bushing
1	125802	Washer, Flat	1	158303	Slide w/Post
2	153609	Roller	1	158304	Plate, Guide
4	153644	Stud	1	158305	Arm
3	153645	Plate, Guide	1	158306	Roller
7	153646	Bushing			

c. For part numbers referred to and for parts ordering information, see Teletype Model 28 Printer Parts Bulletin T149B.

## 2. INSTALLATION (Figure 1)

a. Remove the typing unit from the base and remove the stunt box in accordance with standard practice.

b. Insert the four 153644 studs into the top plate of the stunt box.

c. Place the 153645 guide plate over each pair of studs; the formed ear should be toward the front of the typing unit and extend upward.

- d. Place the 153646 bushing over each stud.
- e. Place the 158303 slide with post on the left 153645 guide plate, to the right of the studs (typing unit viewed from rear) and so that the angle section extends to the left.
- f. Place the 153795 slide on the right 153645 guide plate, to the right of the studs (typing unit viewed from rear) and so that the extension is to the left.
- g. Place the 153647 plate over each pair of studs, so that the projection extends toward the rear of the typing unit.
- h. Place one 153646 bushing on each front stud and one on the rear stud of the right assembly.
- i. Place the 158302 bushing over the left rear stud so that the raised section of the bushing is up.
- j. Place one 153609 roller on each fork pin.
- k. Place one 158300 fork with post on the left pair of studs; place the 158301 fork with post on the right pair of studs; the tines should extend toward the front of the typing unit. The longest portion of the post should point upward. Check to see that lower roller is in place.
- l. Place the 153645 guide plate over the right pair of studs; the formed ear should be toward the front of the typing unit and extend downward.
- m. Place the 158304 guide plate over the left pair of studs; the ear should be toward the front of the typing unit and point downward. Be sure that the 158302 bushing fits into the slot of the 158304 guide plate.
- n. Secure the assemblies with the 125011 flat washers, 110743 lockwashers, and 3599 nuts except the left rear stud.
- o. Secure the 125802 flat washer, 110743 lockwasher, and 3599 nut.
- p. Place one 71073 flat washer over the right fork pin.
- q. Place the hole in the tail of the 158305 arm over the right fork post and the slot over the 158303 slide post so that the projection of the arm is toward the left front.
- r. Place one 71073 flat washer and one 119648 retainer ring on the fork post and the slide post.
- s. Place the 158306 roller over the left fork post and secure with the 119648 retainer ring.

t. Install the stunt box into the typing unit in accordance with standard practice in the reverse order in which it was removed.

u. Recode function bars, where necessary, so that they will operate in the print non-select condition.

### 3. ADJUSTMENTS AND LUBRICATION

For standard adjustment and lubrication procedure refer to standardized information, for other than Bell System Bulletin 217B. Make the following Print Suppression During Selection Adjustments.

- (1) Zero Code Bar Shift Mechanism
- (2) Suppression Code Bar Mechanism

\* \* \*

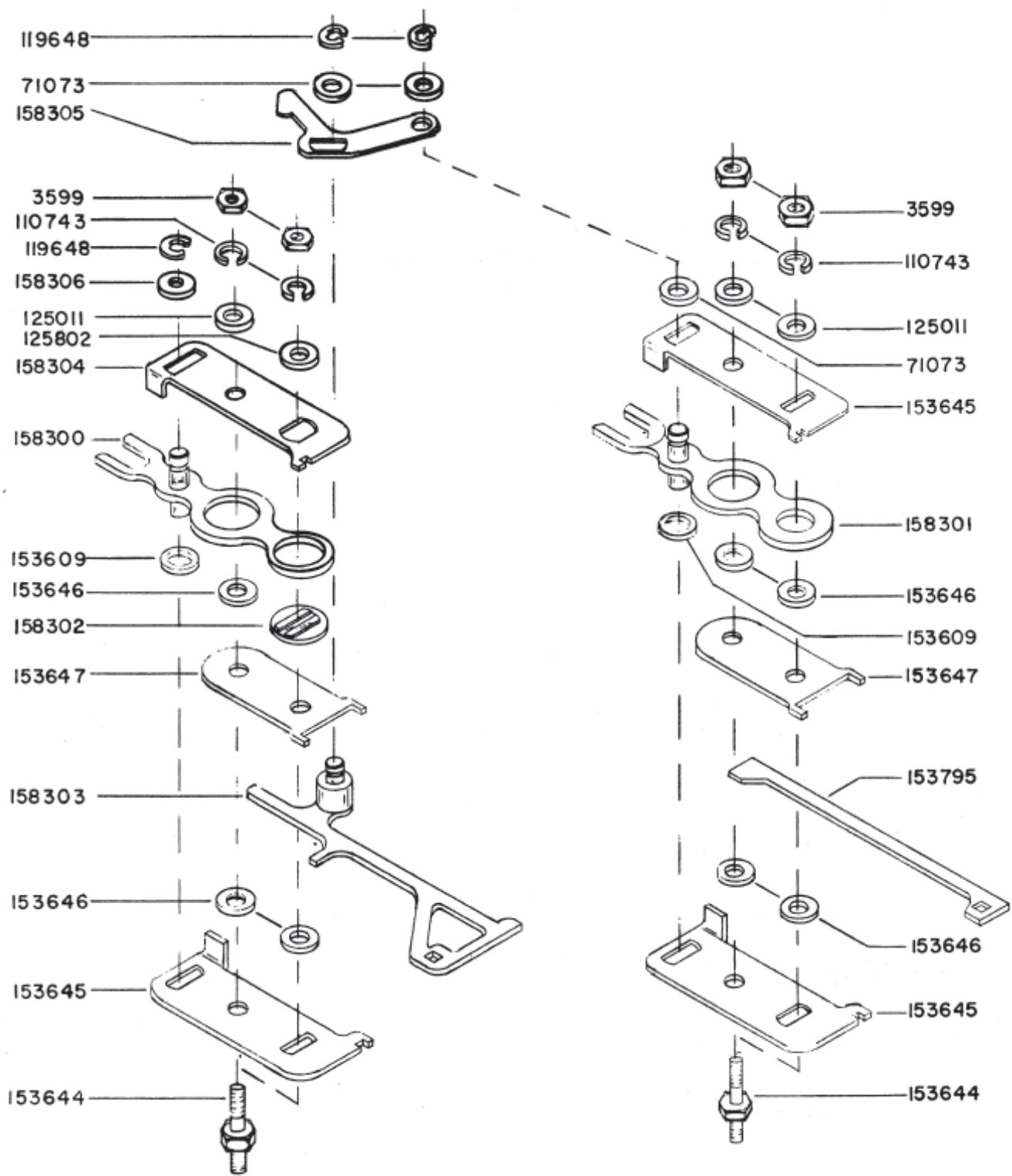

FIGURE 1



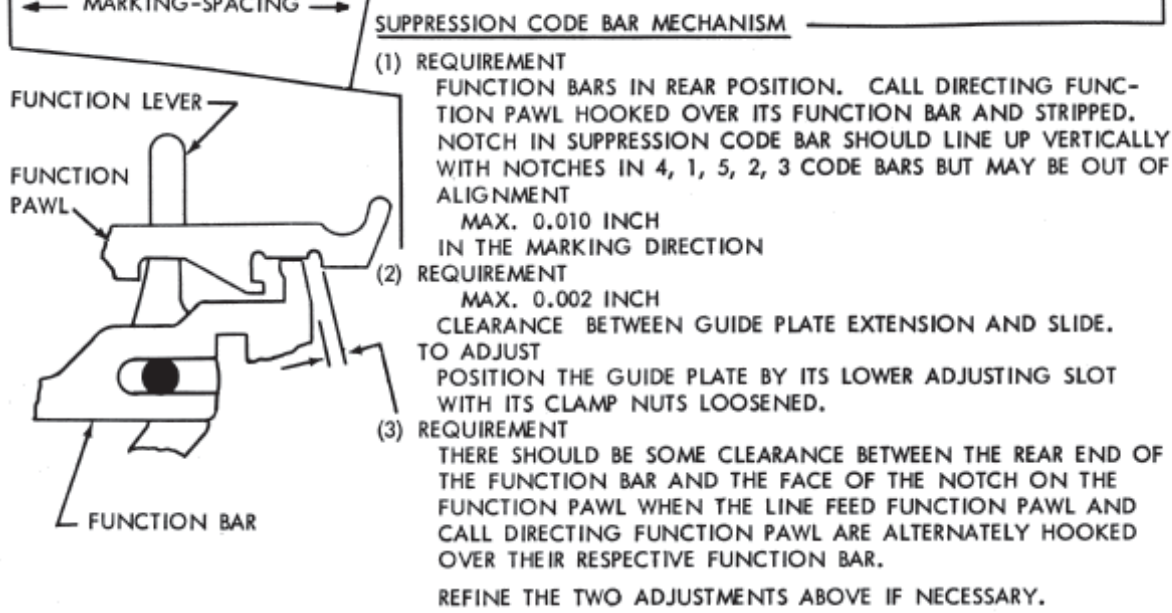
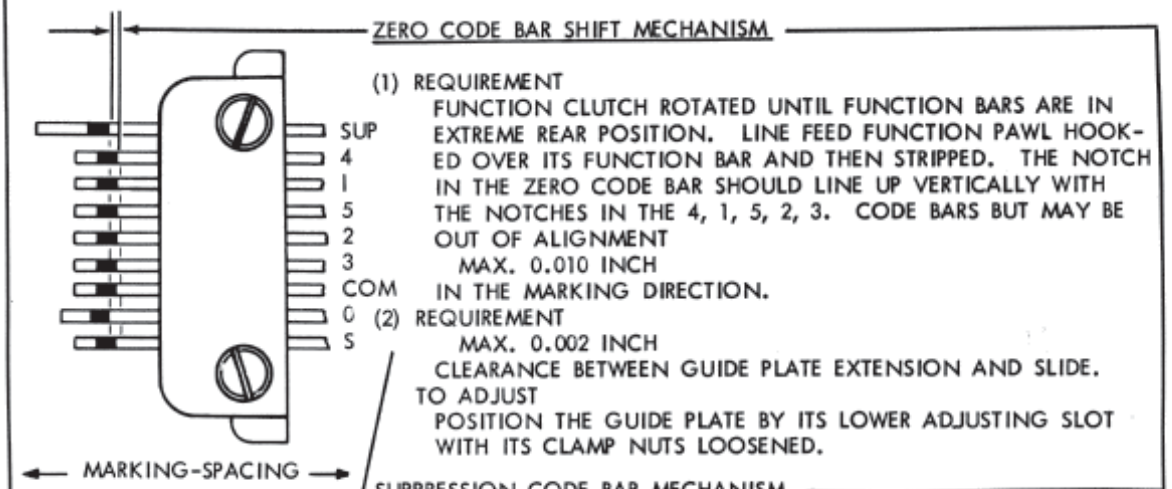
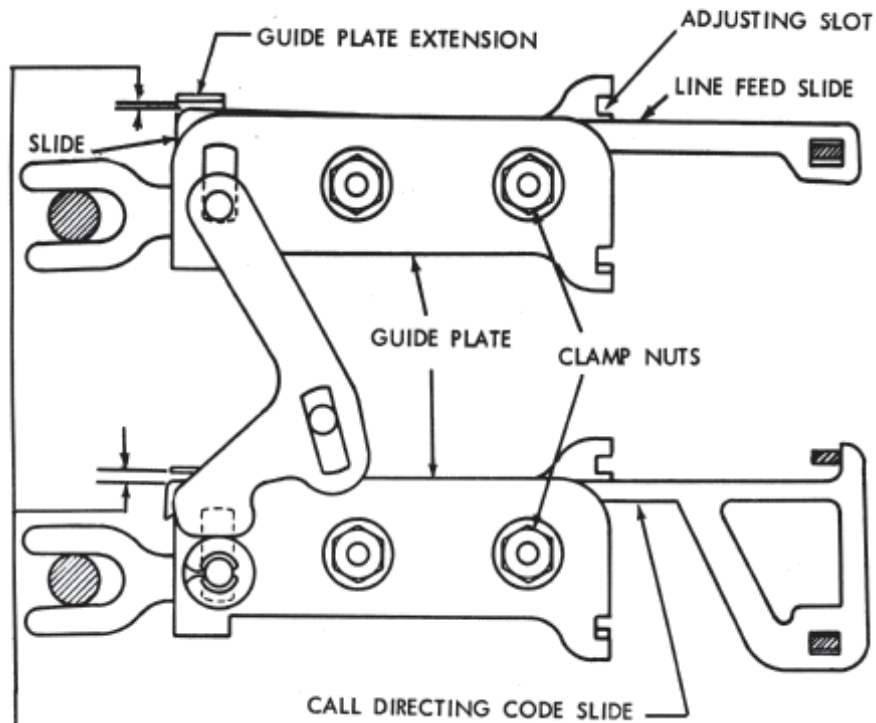

FIGURE 2