

U.S. EXPORTS TO THE UNITED KINGDOM BY COMMODITY GROUP

(Millions of dollars)

Year	Total	Year
1965	1,000.0	1964
1964	950.0	1963
1963	900.0	1962
1962	850.0	1961
1961	800.0	1960
1960	750.0	1959
1959	700.0	1958
1958	650.0	1957
1957	600.0	1956
1956	550.0	1955
1955	500.0	1954
1954	450.0	1953
1953	400.0	1952
1952	350.0	1951
1951	300.0	1950
1950	250.0	1949
1949	200.0	1948
1948	150.0	1947
1947	100.0	1946
1946	50.0	1945
1945	0.0	1944
1944	0.0	1943
1943	0.0	1942
1942	0.0	1941
1941	0.0	1940
1940	0.0	1939
1939	0.0	1938
1938	0.0	1937
1937	0.0	1936
1936	0.0	1935
1935	0.0	1934
1934	0.0	1933
1933	0.0	1932
1932	0.0	1931
1931	0.0	1930
1930	0.0	1929
1929	0.0	1928
1928	0.0	1927
1927	0.0	1926
1926	0.0	1925
1925	0.0	1924
1924	0.0	1923
1923	0.0	1922
1922	0.0	1921
1921	0.0	1920
1920	0.0	1919
1919	0.0	1918
1918	0.0	1917
1917	0.0	1916
1916	0.0	1915
1915	0.0	1914
1914	0.0	1913
1913	0.0	1912
1912	0.0	1911
1911	0.0	1910
1910	0.0	1909
1909	0.0	1908
1908	0.0	1907
1907	0.0	1906
1906	0.0	1905
1905	0.0	1904
1904	0.0	1903
1903	0.0	1902
1902	0.0	1901
1901	0.0	1900

U.S. EXPORTS TO THE UNITED KINGDOM BY COMMODITY GROUP									
In millions of dollars (unless otherwise indicated)									
Commodity Group	1965				Commodity Group	1964			
	Value	% of Total	Value	% of Total		Value	% of Total	Value	% of Total
AGRICULTURAL PRODUCTS	100.0	10.0	100.0	10.0	AGRICULTURAL PRODUCTS	100.0	10.0	100.0	10.0
MINERAL PRODUCTS	100.0	10.0	100.0	10.0	MINERAL PRODUCTS	100.0	10.0	100.0	10.0
MANUFACTURES	800.0	80.0	800.0	80.0	MANUFACTURES	800.0	80.0	800.0	80.0
Other	0.0	0.0	0.0	0.0	Other	0.0	0.0	0.0	0.0
Total	1,000.0	100.0	1,000.0	100.0	Total	1,000.0	100.0	1,000.0	100.0

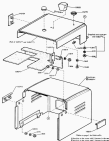

FIGURE 1. ENCLOSED INTEGRATED DEVICE

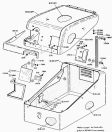

FIGURE 1. EXPLODED VIEW OF THE MECHANICAL ASSEMBLY

Year	Revenue
2000	100
2001	105
2002	110
2003	115
2004	120
2005	125
2006	130
2007	135
2008	140
2009	145
2010	150

Year	Revenue
2000	100
2001	105
2002	110
2003	115
2004	120
2005	125
2006	130
2007	135
2008	140
2009	145
2010	150

Year	Revenue
2000	100
2001	105
2002	110
2003	115
2004	120
2005	125
2006	130
2007	135
2008	140
2009	145
2010	150

10/10/2010