

**INSTRUCTIONS FOR INSTALLING THE 161678 MODIFICATION
KIT IN CABINETS (LBAC) TO USE A MULTIPLE REPERFORATOR
BASE LMRB200** AND OTHERS**

The chart below pertains to Bell System only:

TELETYPE UNIT	TELETYPE CODE	BELL SYSTEM CODE
Multiple Reperforator Base	LMRB200**	28B**
Apparatus Cabinet	LBAC215**	28A-1**
	LBAC216**	28A-2**
	LBAC217**	28A-3**
	LBAC218**	28A-4**
	LBAC219**	28A-5**

1. GENERAL

a. The 161678 Modification Kit when installed in LBAC Cabinet provides for use of a Multiple Reperforator Base LMRB200** and others.

b. The 161678 Modification Kit consists of:

3	1264	Screw	4	112626	Nut
8	2191	Washer, Lock	1	121244	Clamp, Cable
4	2669	Washer, Lock	7	151631	Screw
9	3598	Nut	2	151632	Screw
10	7002	Washer, Flat	1	161683	Channel W/Rail, Left
1	35551	Screw	1	161684	Channel, Right
8	85318	Washer, Leather	1	161711	Block, Grooved Nylon
1	107116	Washer, Lock	3	161716	Block, Flat Nylon

c. The double asterisks (**) designate a suffix which indicates the color of the paint finish.

d. For part numbers referred to and for parts ordering information see Teletype Model 28 Typing Reperforator Set (LPR) Parts Bulletin 1167B.

2. INSTALLATION

a. Fasten the two 161716 Support Blocks to the rear end of the 161684 Right Channel using the two 1264 Flat Head Screws, 2669 Lock Washers and 112626 Nuts.

b. Mount the 161711 Guide Block to the top and rear of the 161683 Channel W/Rail with the 35551 Flat Head Screw, 2669 Lock Washer and 112626 Nut.

c. Mount the 161716 Support Block to the bottom rear of the 161684 Channel using the 1264 Screw, 2669 Lock Washer and 112626 Nuts.

d. Remove the three tape containers and resiliently mounted base from the oil pan. Save all hardware.

*e. Fasten the 161683 Channel W/Rail to the left side of the pan using three 151631 Screws, 7002 Flat Washers, 2191 Lock Washers and 3598 Nuts in the two front and the most forward of the rear holes.

*f. Mount the 161684 Right Channel to the right side of the oil pan using the four 151631 Screws, 2191 Lock Washers, 7002 Flat Washers, and 3598 Nuts.

g. Replace the base and tape containers on the oil pan.

*h. Fasten the ground strap to the pan by inserting the 151632 Screw with a 7002 Flat Washer through the ground strap terminal; add the 107116 Washer and place this assembly through the left rear hole in the pan and rail. Secure by placing a 85318 Leather Washer against the lower surface of the rail, a 7002 Flat Washer against the leather washer, and tighten with a 2191 Lock Washer and 3598 Nut.

i. The multiple reperfurator base may now be installed into the LBAC Apparatus Cabinet by sliding the base into the mating channels located in the cabinet. Apply grease to the mating rails and channels of the base and cabinet.

j. Connect the 36-Point Control Connectors to the Reperfurator. Secure the control cable to the base at three places. Use the 121249, 121248, 121247 Cable Clamps, 151631 Screws, 7002 Flat Washers, and 2191 Lock Washers found in the muslin bag tied to base.

k. If the Multiple Reperfurator Base is mounted in the upper shelf of the Reperfurator Cabinet, the control cable must be secured to the right tape container using the 121249 Cable Clamp and 7002 Flat Washer found in the muslin bag attached to the base. The cable clamp is to be mounted under the upper tape guide mounting screw and positioned so as to make the control cable rise up and backward from the base.

*

*

*

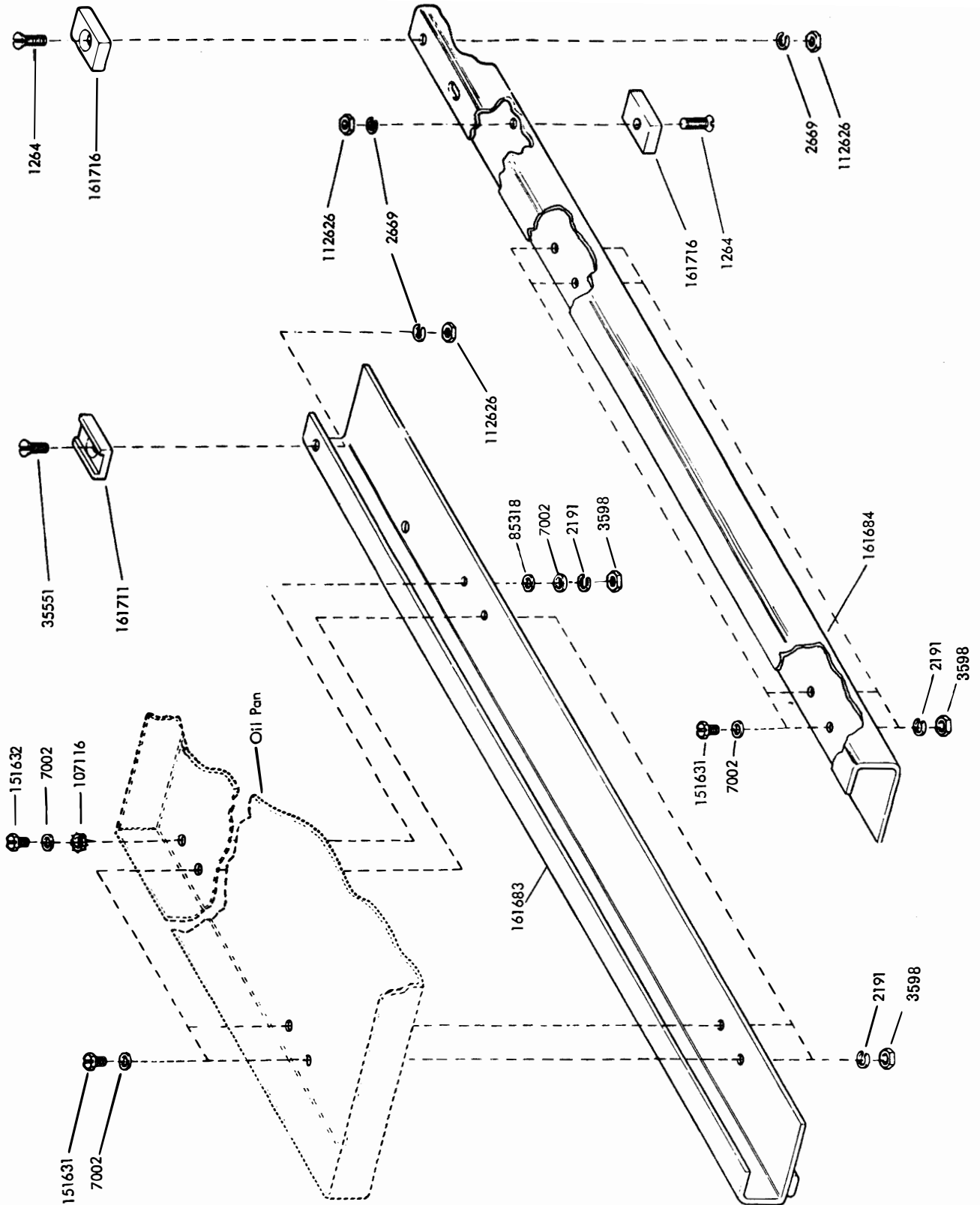

FIGURE 1. 161678 MODIFICATION KIT TO INSTALL A MULTIPLE REPERFORATOR BASE (LMRB) IN A MODEL 28 CABINET (LBAC)