

506-0195-002 CU-286

NOTICE: WHEN GOVERNMENT DRAWINGS, SPECIFICATIONS, OR OTHER DATA ARE USED FOR ANY PURPOSE OTHER THAN IN CONNECTION WITH A DEFINITELY RELATED GOVERNMENT PROCUREMENT OPERATION, THE UNITED STATES GOVERNMENT THEREBY INCURS NO RESPONSIBILITY FOR ANY OBLIGATION WHATSOEVER AND THE FACT THAT THE GOVERNMENT MAY HAVE FORMULATED, PROVIDED, OR IN ANY WAY SUPPLIED THE SAID DRAWINGS, SPECIFICATIONS, OR OTHER DATA IS NOT TO BE REGARDED BY IMPLICATION OR OTHERWISE AS IN ANY MANNER LICENSING THE HOLDER OR ANY OTHER PERSON OR CORPORATION, OR CONFERRING ANY RIGHTS OR PERMISSIONS TO REPRODUCE, USE, OR SELL ANY PATENTED INVENTION THAT MAY IN ANY WAY BE RELATED THERETO.

NOTE:

\*FOR INFORMATION ONLY, CONTRACTOR MAY AT HIS OPTION DEVIATE FROM THESE PROCESS DETAILS

\*SWE APPROVAL  
SYM PR10042-17

REVISIONS

SYM	DESCRIPTION	DATE	APPROVAL
A	A1 - MIL-P-79 WAS MIL-P-3115; ADDED NOTE 3 & APPL.	12 DEC 59	42428-PC-59 -A1-51 RBYR

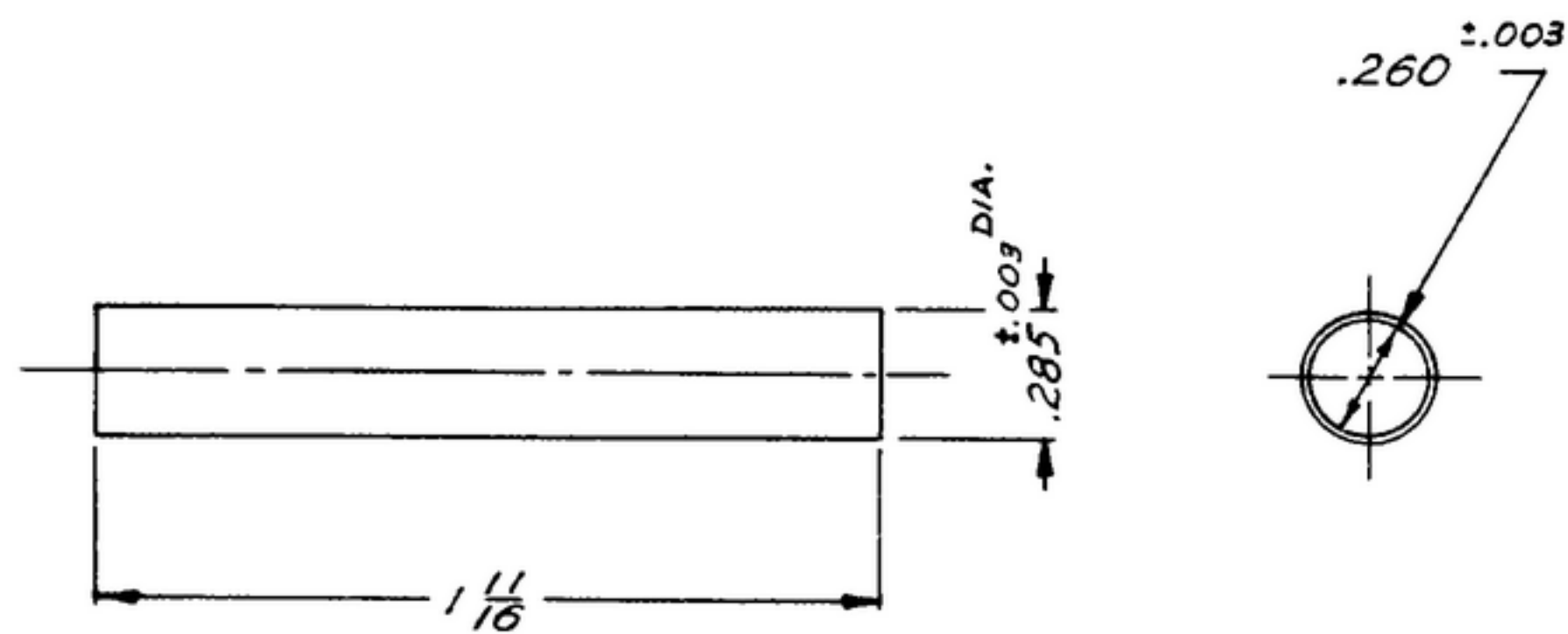

NOTES:

- 1.- PLASTIC TYPE PBM PER MIL-P-79.
- 2.- OUTSIDE & INSIDE DIAMETERS MUST BE CONCENTRIC WITHIN ±.006 TIR.
- 3.- SUPPLIER: PANELYTE DIVISION ST. REGIS PAPER CO. NEW YORK, N.Y. GRADE 780, OR EQUAL.

(A1)

REQD	PART NO.	DESCRIPTION	MATL	MATL SPEC
LIST OF MATERIAL				
UNLESS OTHERWISE SPECIFIED			<p><b>FORM</b></p> <p>SIGNAL CORPS ENGINEERING LABORATORIES</p> <p>FORT MONMOUTH NEW JERSEY</p> <p><b>SM-B-178374</b></p>	
DIMENSIONS ARE IN INCHES				
TOLERANCES ON				
FRACTIONS DECIMALS ANGLES				
± 1/64				
AUTHENTICATION				
DRAWN 21852-PH-50-59			<p>SCALE 2/1</p>	
TRACED PHOTO				
CHECKED <i>Rhon</i>				
VERIFIED <i>PDOR</i>				
APPROVED <i>PDOR</i>				
REVIEWED <i>PME</i>				
DATE 3-AUG-55			<p>APPLICATION</p>	
NEXT ASSY USED ON				
APPLICATION			<p>APPLICATION</p>	
NEXT ASSY USED ON				