

RBB. 7

8

NOTICE: When Government drawings, specifications, or other data are used for any purpose other than in connection with a definitely related Government procurement operation, the United States Government hereby incurs no responsibility or any obligation whatsoever and the fact that the Government may have formulated, furnished, or in any way supplied the said drawings, specifications, or other data is not to be regarded by implication or otherwise as in any manner licensing the holder or any other person or corporation, or conveying any rights or permission to manufacture, use or sell any patented invention that may in any way be related thereto.

NOTE
*FOR INFORMATION ONLY, CONTRACTOR MAY AT HIS OPTION DEVIATE FROM THESE PROCESS DETAILS.

NEXT ASSEMBLY	USED ON	SWE * APPROVAL	REVISIONS			
			SYM	DESCRIPTION	DATE	APPROVAL
SM-B-178861	SC-DL-178467	SWE * APPROVAL SY 10042- M -3	A4	A1 - WAS COMP. FM, AN-S-771, A2 - ADDED "BOTH SIDES" A3 - REVISED FIN. NOTE; A4 - ADDED APPL. SM-B-178861, SC-DL-248775	6 OCT. 59	42428-PC-59-A1-51 REV'D. PME
SM-B-178861	SC-DL-248775					
	SC-DL-144500					
			B1	B1, ADDED: "SURFACE COND c"	25 SEP 64	15283-PP-63 REVD EC-2

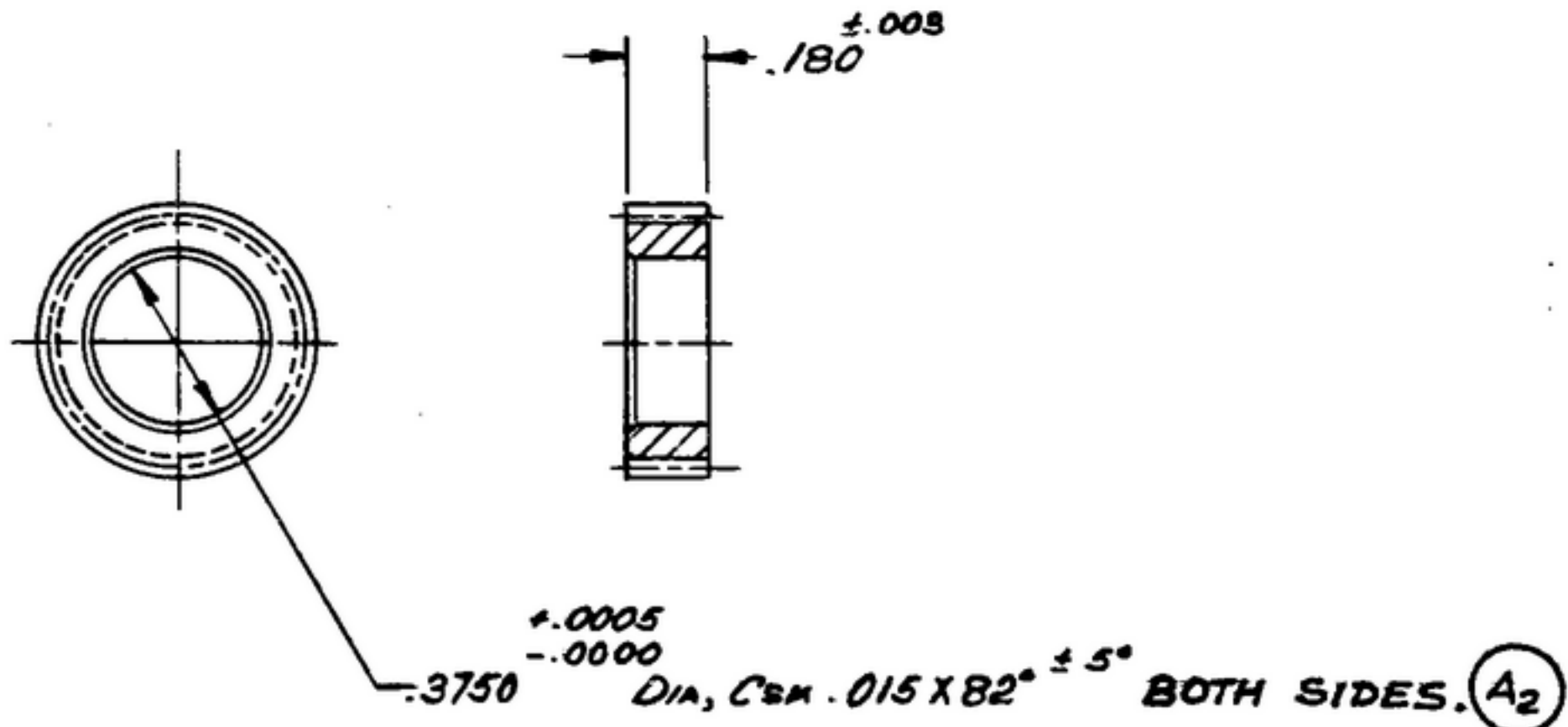

(A1) STEEL, COMPOSITION 303S CONDITION B, SURFACE COND c PER SPEC MIL-5-7120 (B1)

- 1-NORMAL DIAMETRAL PITCH : 48
- THEORETICAL PITCH DIAMETER : .583
- PRESSURE ANGLE : 14 1/2°
- NUMBER OF TEETH : 28
- BACKLASH ON NORMAL PITCH CIRCLE WHEN MATED WITH MASTER .0015-.0025.
- AMERICAN STANDARD INVOLUTE TOOTH FORM.
- 2- ECCENTRICITY BETWEEN BORE DIAMETER AND PITCH DIAMETER SHALL NOT EXCEED .002 TIR.

(A3) 3- FINISH: E 300 PER SPEC. MIL-F-14072.

UNLESS OTHERWISE SPECIFIED	AUTHENTICATION	SCALE	DEPARTMENT OF THE ARMY
DIMENSIONS ARE IN INCHES	DRAWN 21852-PA-50 53	2/1	SIGNAL CORPS ENGINEERING LABORATORIES FORT MONMOUTH NEW JERSEY
TOLEANCES ON FRACTIONS ± $\frac{1}{16}$	TRACED PHOTO		
DECIMALS ± .005	CHECKED <i>[Signature]</i>	GEAR	SM-B-178863
ANGLES ±	VERIFIED P.D.BR.		
COMMERCIAL TOLERANCES APPLY TO STOCK SIZES	APPROVED P.D.BR.	DATE 29-JUNE-53	
ALL SURFACES ✓	REVIEWED PME	SCALE 2/1	
	DATE 29-JUNE-53	SEE NOTE 3	