

D.T. 1.6

EQUIP. TYPE R390A/URR EXP. NO.

COL. 541 6260 002

NOTICE: WHEN GOVERNMENT DRAWINGS, SPECIFICATIONS, OR OTHER DATA ARE USED FOR ANY PURPOSE OTHER THAN IN CONNECTION WITH A DEFINITELY RELATED GOVERNMENT PROCUREMENT OPERATION, THE UNITED STATES GOVERNMENT THEREBY INCURS NO RESPONSIBILITY FOR ANY OBLIGATION WHATSOEVER; AND THE FACT THAT THE GOVERNMENT MAY HAVE FORMULATED, FURNISHED, OR IN ANY WAY SUPPLIED THE SAID DRAWINGS, SPECIFICATIONS, OR OTHER DATA IS NOT TO BE REGARDED BY IMPLICATION OR OTHERWISE AS IN ANY MANNER LICENSING THE HOLDER OR ANY OTHER PERSON OR CORPORATION, OR CONVEYING ANY RIGHTS OR PERMISSION TO MANUFACTURE, USE, OR SELL ANY PATENTED INVENTION THAT MAY IN ANY WAY BE RELATED THERETO.

THIS DOCUMENT HAS BEEN PURCHASED BY THE GOVERNMENT AND MAY BE REPRODUCED AND USED IN CONNECTION WITH ANY GOVERNMENT PROCUREMENT OR MAINTENANCE OPERATION.

\* FOR INFORMATION ONLY, CONTRACTOR MAY AT HIS OPTION DEVIATE FROM THESE PROCESS DETAILS.

~~\* SWE APPROVAL~~  
~~SYM PR10042-12~~

REVISIONS			
SYM	DESCRIPTION	DATE	APPROVAL
A <sub>6</sub>	A <sub>1</sub> NOTE 1 WAS "SILK SCREENING TO BE BLACK, ETC" A <sub>2</sub> ADD CALLOUTS A <sub>3</sub> DELETED ITEM 2 SM-B-249184 A <sub>4</sub> DWG TITLE WAS "CAN-I.F." A <sub>5</sub> NOTE 2 WAS "SILK SCREENING IN ACCORDANCE WITH COLLINS SPEC, ETC." A <sub>6</sub> SEE NOTE 1 REPLACED SILK SCREEN NOTATION	17 NOV 59	42428-PC-51 REV'D PME
B	(1) REMOVED "SM"	31 OCT 61	42428-PC-59 REV'D PME

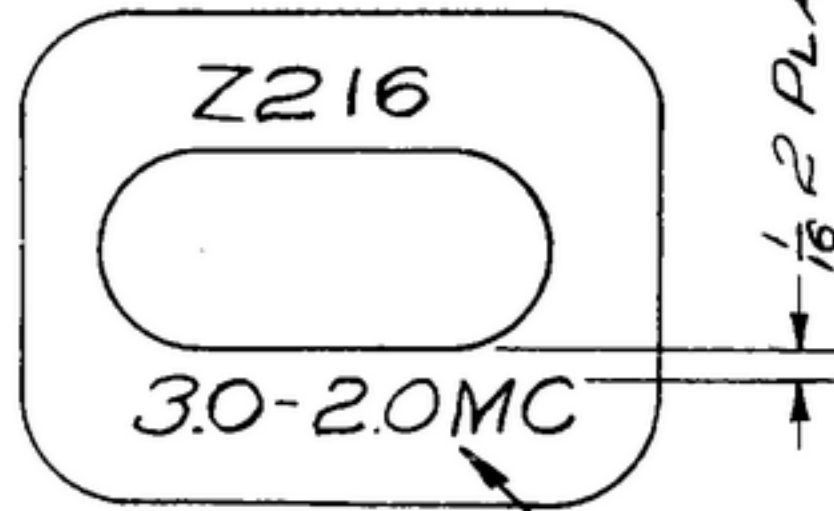

SEE NOTE 1

(A<sub>6</sub>)

OUTLINE OF CASE FOR REF. ONLY

(A<sub>2</sub>)

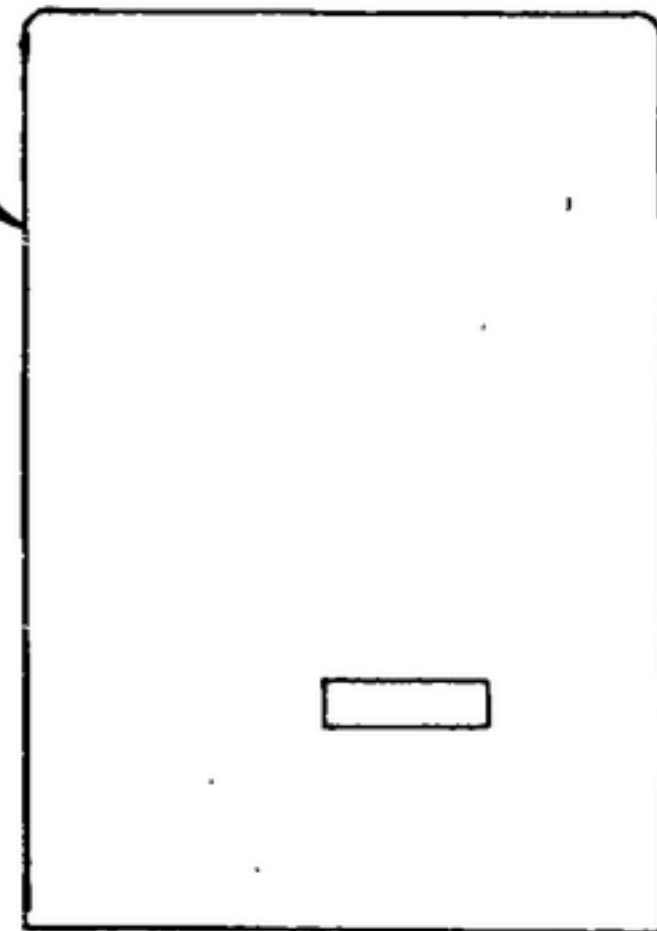

SEE NOTE 2

NOTES

- ALL CHARACTERS TO BE 3/32 HIGH GOTHIC TYPE PER SPEC MIL-M-13231 GROUP II COLOR TO BE BLACK COLOR CHIP NO. 27038 PER FED. STD. 595 MARKINGS TO BE CENTRALLY LOCATED ± 1/32 UNLESS OTHERWISE SHOWN COVER DESIGNATIONS WITH ONE COAT OF VARNISH PER MIL-V-173, TYPE II
- MARK WITH PRIME MANUFACTURERS NAME OR REGISTERED TRADEMARK AND PART NUMBER PER MIL-M-13231 GROUP II (\* STEWART-WARNER ELECTRONICS, CHICAGO, ILL D 249098) (B<sub>1</sub>)

(A<sub>3</sub>)

COLLINS PART NO.	ITEM	REQD	PART NO.	DESCRIPTION	MATL	MATL SPEC
(SA) 558 0407 002	1	1	SM-B-249053	CAN		

LIST OF MATERIAL

~~COLLINS PART NO. 558 0522 002~~

COLLINS NO.	QTY	NEXT ASSY	USED ON
558 0449 001	1	SM-D-249098	SEDL-248775

DRAWN  
*NUGEN*

CHECKED  
*Rln*

APPROVED

UNLESS OTHERWISE SPECIFIED:  
DECIMAL DIMENSIONS INCLUDING HOLE SIZES MAY VARY ±.008  
FRACTIONAL DIMENSIONS INCLUDING HOLE SIZES MAY VARY ±1/64  
MACHINED ANGLES MAY VARY ±1°  
SHEARED ANGLES MAY VARY ±.25°  
BROKEN ANGLES MAY VARY ±1°  
ECCENTRICITY BETWEEN ANY DIAMETERS ON THE SAME CENTERLINE SHALL NOT EXCEED .010 TOTAL INDICATOR READING.  
ALL DIMENSIONS ARE FINISH DIMENSIONS INCLUDING APPLIED FINISH AND ARE GIVEN IN INCHES.

COLLINS-RADIO-CO.  
-CEDAR-RAPIDS, IOWA

14214-PH-51-93

SIGNAL CORPS

REVIEWED *PME*

APPROVED *HLV*  
*PME*

DATE 14 FEB 56

CAN-MARKED

SCALE 2/1

DEPARTMENT OF THE ARMY  
SIGNAL CORPS ENGINEERING  
LABORATORIES

FORT MONMOUTH NEW JERSEY

SM-B-249169