

BY THE CONTRACTOR OR SUBCONTRACTOR AS AN INDICATION OF THE
 HOLDER OR ANY OTHER PERSON OR CORPORATION, OR CONVEYING ANY RIGHTS OR PERMISSION TO MANUFACTURE
 USE, OR SELL ANY PATENTED INVENTION THAT MAY IN ANY WAY BE RELATED THERETO.

CONTRACTOR MAY AT HIS
 OPTION DEVIATE FROM
 THESE PROCESS DETAILS

DATE APPROVAL

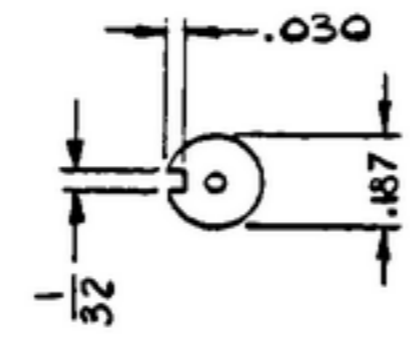
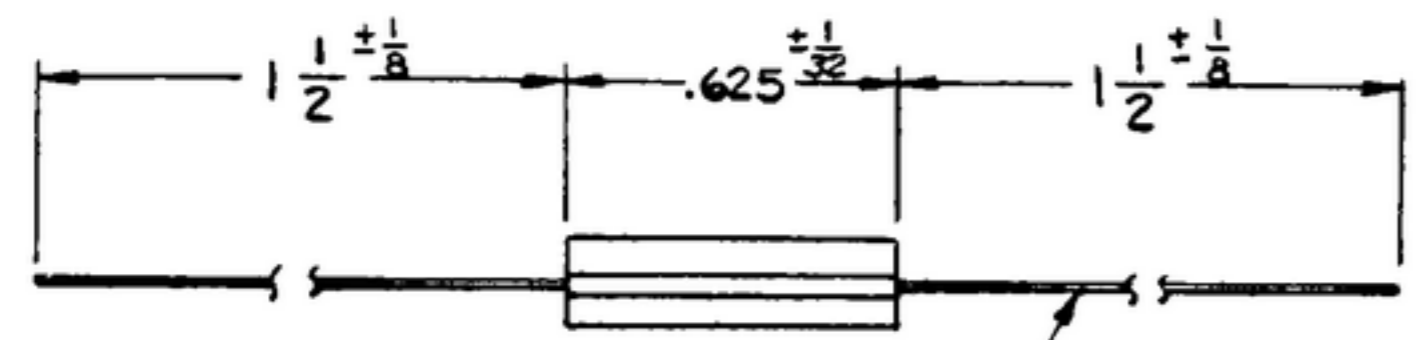

AWG. #22 (.025) TINNED COPPER

NOTES:
 1. AS SUPPLIED BY : QUALITY COMPONENT INC.
 SAINT MARYS, PA.; PART NO. QSI 187625 OR EQUAL.
 2. MATERIAL : CARBONYL C.

REQD	PART NO.	DESCRIPTION	MATL	MATL SPEC	NOTES
LIST OF MATERIAL					

				UNLESS OTHERWISE SPECIFIED					
				DIMENSIONS ARE IN INCHES					
				TOLERANCES ON					
				FRACTIONS		DECIMALS		ANGLES	
				$\pm \frac{1}{32}$		$\pm .005$		$\pm -$	
		DRAWN BY <i>J. Forante</i>		REVIEWED <i>PME</i>					
		CHECKED BY <i>EQ Zeban</i>		APPROVED					
		CHIEF DRAFTS <i>C. J. ...</i>		<i>PME</i>					
		ENG APPROVAL <i>M. W. ...</i>		DATE 25 NOV 59					
NEXT ASSY	USED ON	NEXT ASSY	USED ON						
SWE APPLICATION		APPLICATION		SCALE 2/1					

FORM, COIL

DEPARTMENT OF THE ARMY
 SIGNAL CORPS ENGINEERING
 LABORATORIES
 FORT MONMOUTH NEW JERSEY

SM-B-343643